



Installation Guide

Manufacture Location:

5965 Peachtree Corners East, Suite A-1, Norcross, GA, 30071

Need Help with Installation?

(678) 580-5717 (M-F 10AM-5PM ET)

admin@matrixmirrors.com

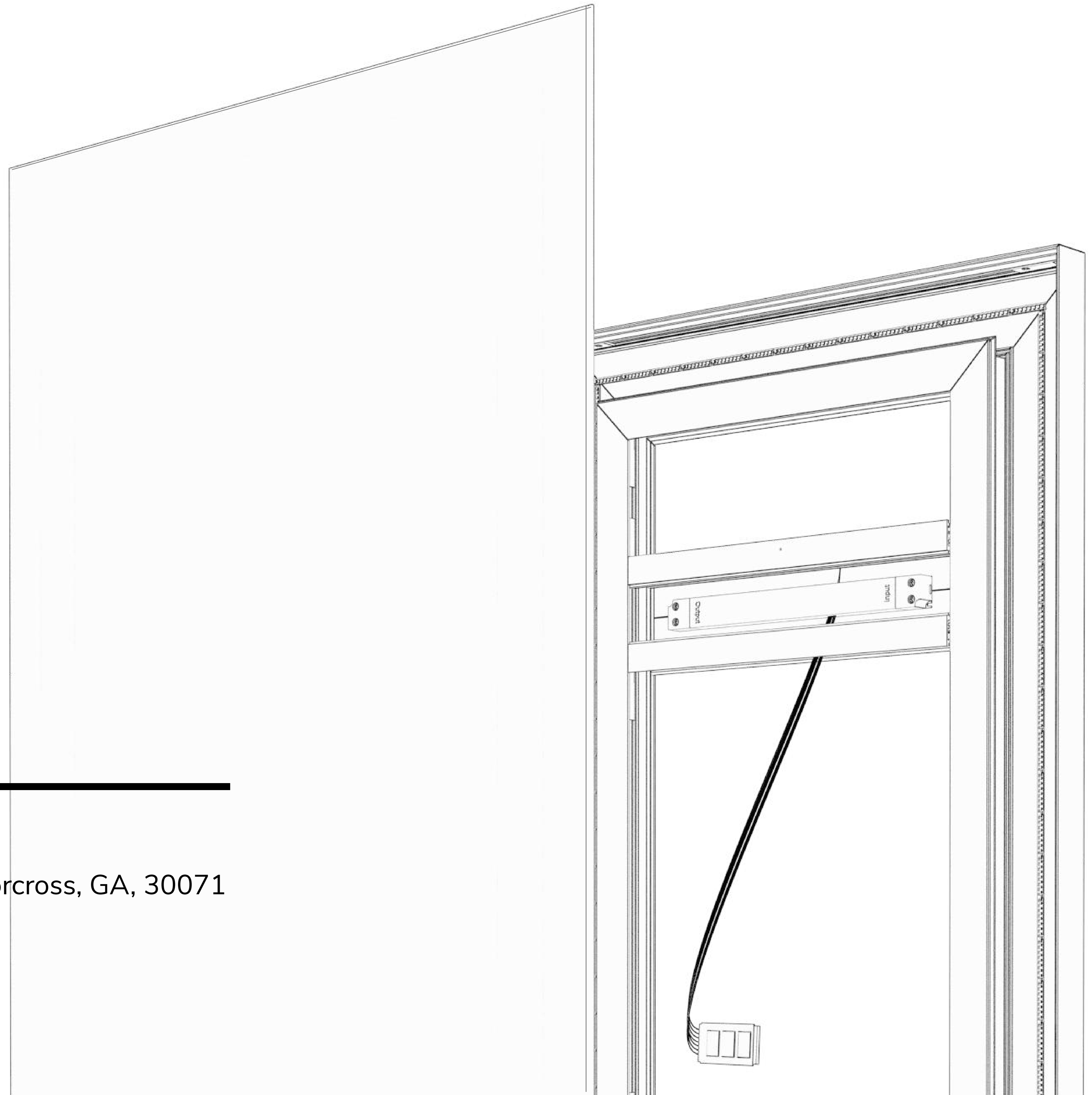



SAFETY, HANDLING, AND CARE INSTRUCTIONS

Safety Information

- Matrix Mirrors fixtures must be installed in accordance with all applicable national, state, and local electrical codes and by a licensed electrician.
- **TO AVOID THE RISK OF SHOCK OR FIRE, DISCONNECT POWER BEFORE INSTALLATION.**
- RECOMMENDED **TWO-PERSON** INSTALLATION. This is especially important for mirrors larger than 32", consider having a glass professional present for the installation.
- Matrix Mirrors hanging brackets **MUST BE INSTALLED INTO STUDS OR BLOCKING**. Sheetrock alone is insufficient; a mirror could fall if not properly installed in accordance with these instructions.
- Matrix Mirrors is not responsible for damage or injury incurred during the installation process or for problems that arise if its products should be installed by an unlicensed person. See the full Matrix Mirrors Warranty Statement and Terms and Conditions on matrixmirrors.com.

Handling Instructions

- **NEVER** place the mirror chassis or glass on any surface by any of the four corners. This can lead to damage or breakage.
- If the mirror must be removed from the wall, be sure to first disconnect the power, then remove the glass before dismounting the chassis.
- **DO NOT** place the glass down on any hard surfaces such as hardwood, tile, granite, concrete, vinyl, or linoleum.
- When storing the glass either during installation or removal, always place two corners flush against the floor and two against a wall. All surfaces should be covered by a soft barrier such as foam double-walled cardboard, a towel, or a blanket. It is also possible to lay the glass completely flat against a soft surface.

Care Instructions

- If possible, turn off the power to the mirror before cleaning.
- Do not clean using abrasive cloths or paper towels as they can scratch the glass.
- Do not spray chemicals or liquids on any part of the mirror – particularly the sides or edges of the glass and the diffusers along the sides of the mirror chassis. To clean the glass, apply a glass cleaning agent to a non-abrasive or microfiber cloth, then gently wipe the glass and sides, being careful not to touch the corners of the glass or the chassis.
- **NEVER** apply pressure, pull down, or push up on the glass or chassis as this could cause injury or damage.
- No one other than a licensed and trained electrician should ever remove the mirror glass from the chassis or uninstall the chassis from the wall.

Before Installing

- Refer to the product specification sheets to determine where to place the junction box needed to install the product.
- Have a soft material such as moving blanket or cardboard available to place the glass down on.
- Contact the factory with any questions about installation.

1 Unscrew the thumb screws

* Optional accessory step

Locate the 1-2 thumbscrew(s) holding the chassis to the glass. The screws are for shipping and are not necessary for installation. Next, slide the touch sensor from its clip and disconnect demister connector. (Optional accessories may not be present)

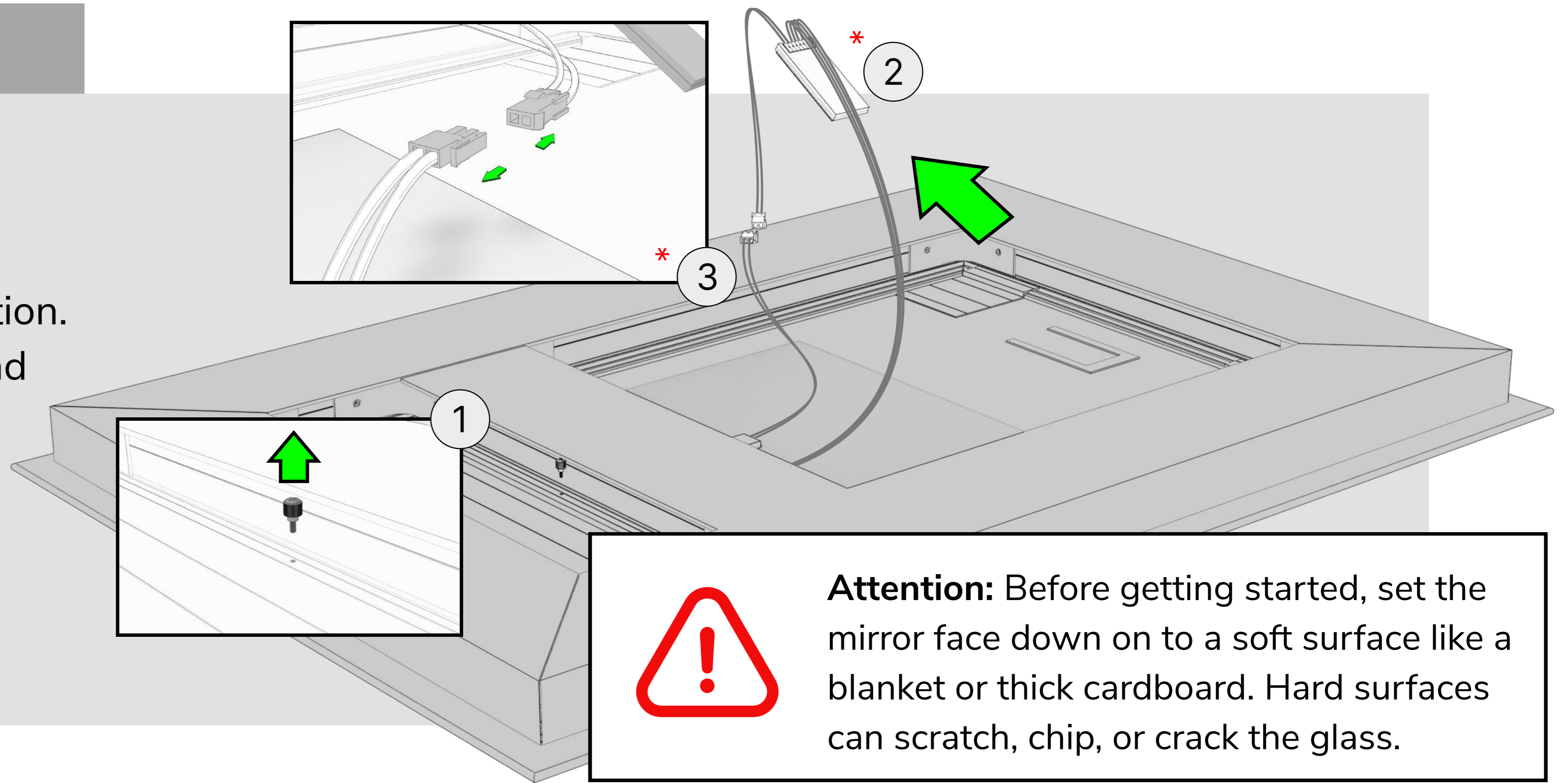
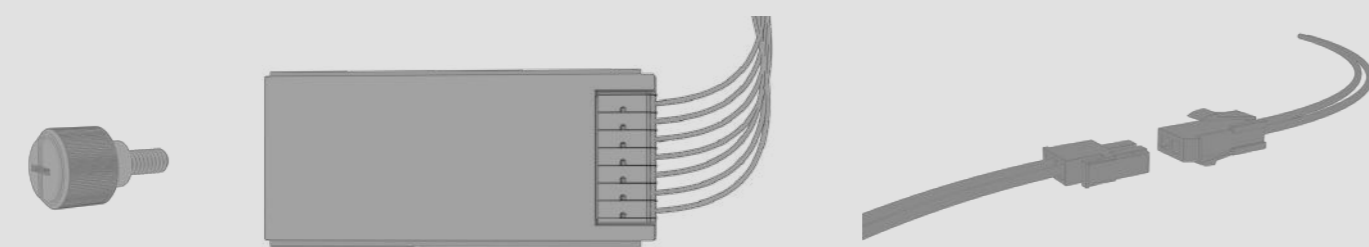

Attention: Before getting started, set the mirror face down on to a soft surface like a blanket or thick cardboard. Hard surfaces can scratch, chip, or crack the glass.

2 Slide off chassis from glass

After removing the chassis put it aside and leave the glass resting safely on a soft surface.

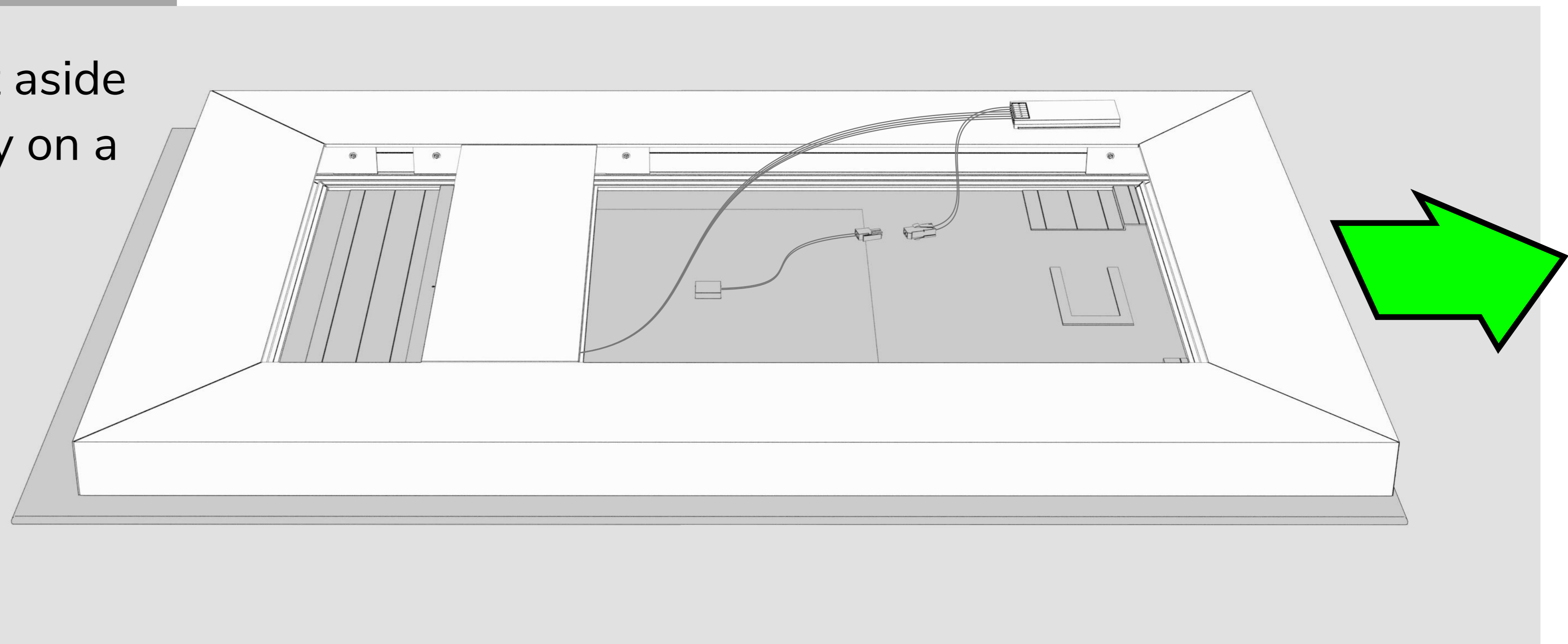

3 Center Junction Box with Chassis

Hold the chassis against the wall and use the chassis as reference to center the junction box.

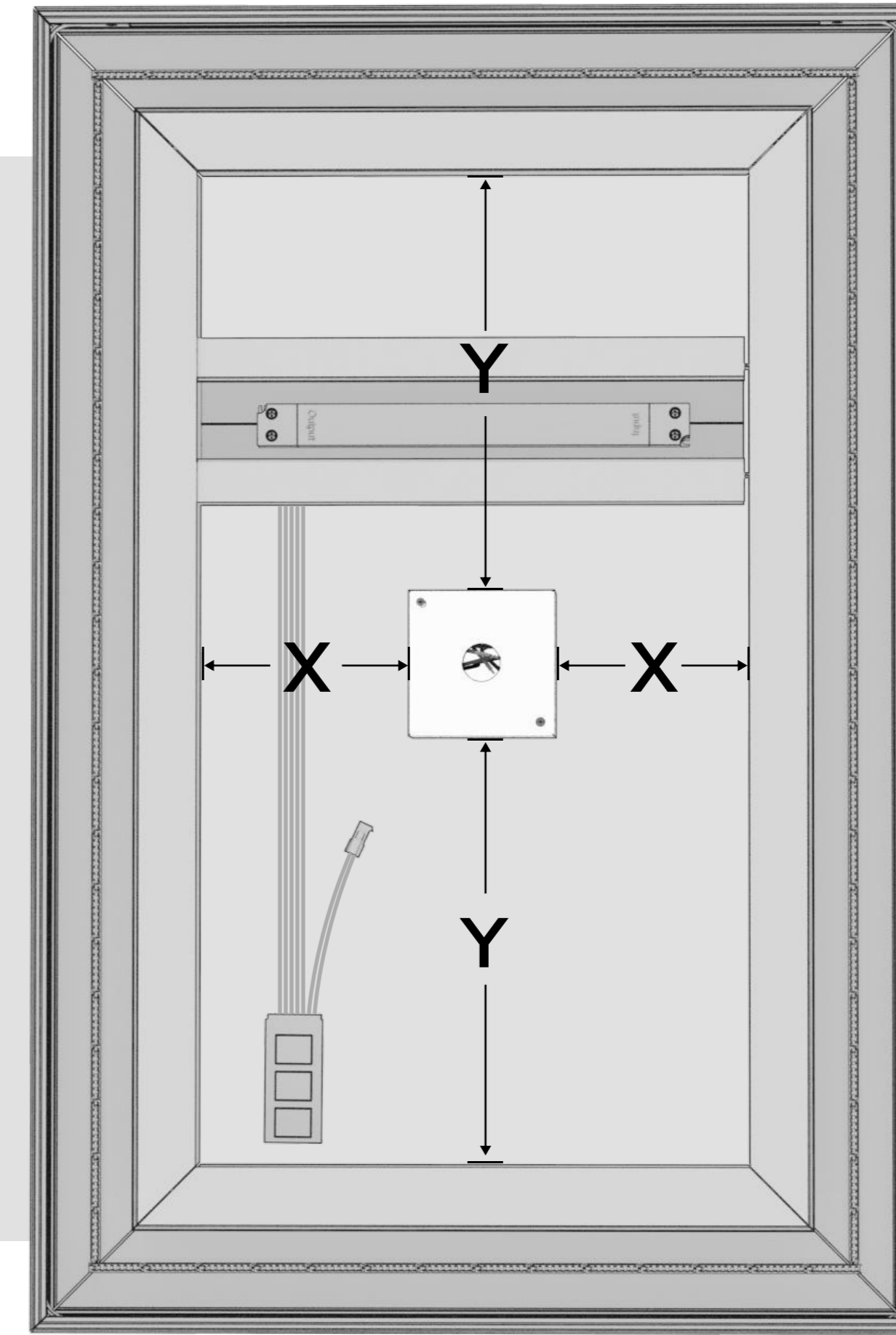
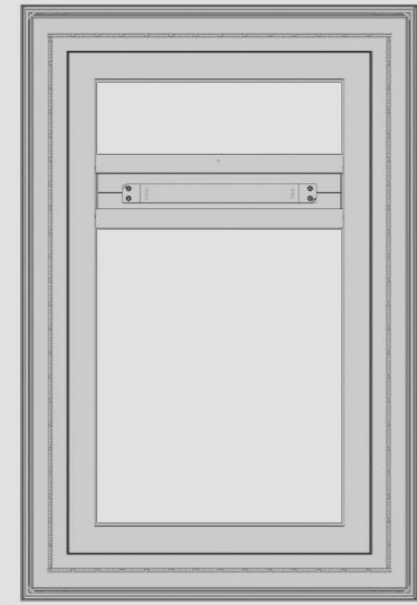

4 Determine Bracket Placement

Use the chassis as reference to determine bracket placement.

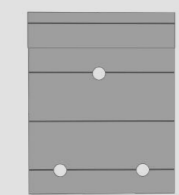

Option 1: Hang from top of chassis.

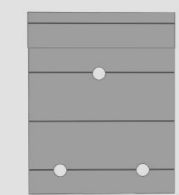

Option 2: Hang from crossbar.

Chassis

Option 1

Or

Crossbar

Option 2

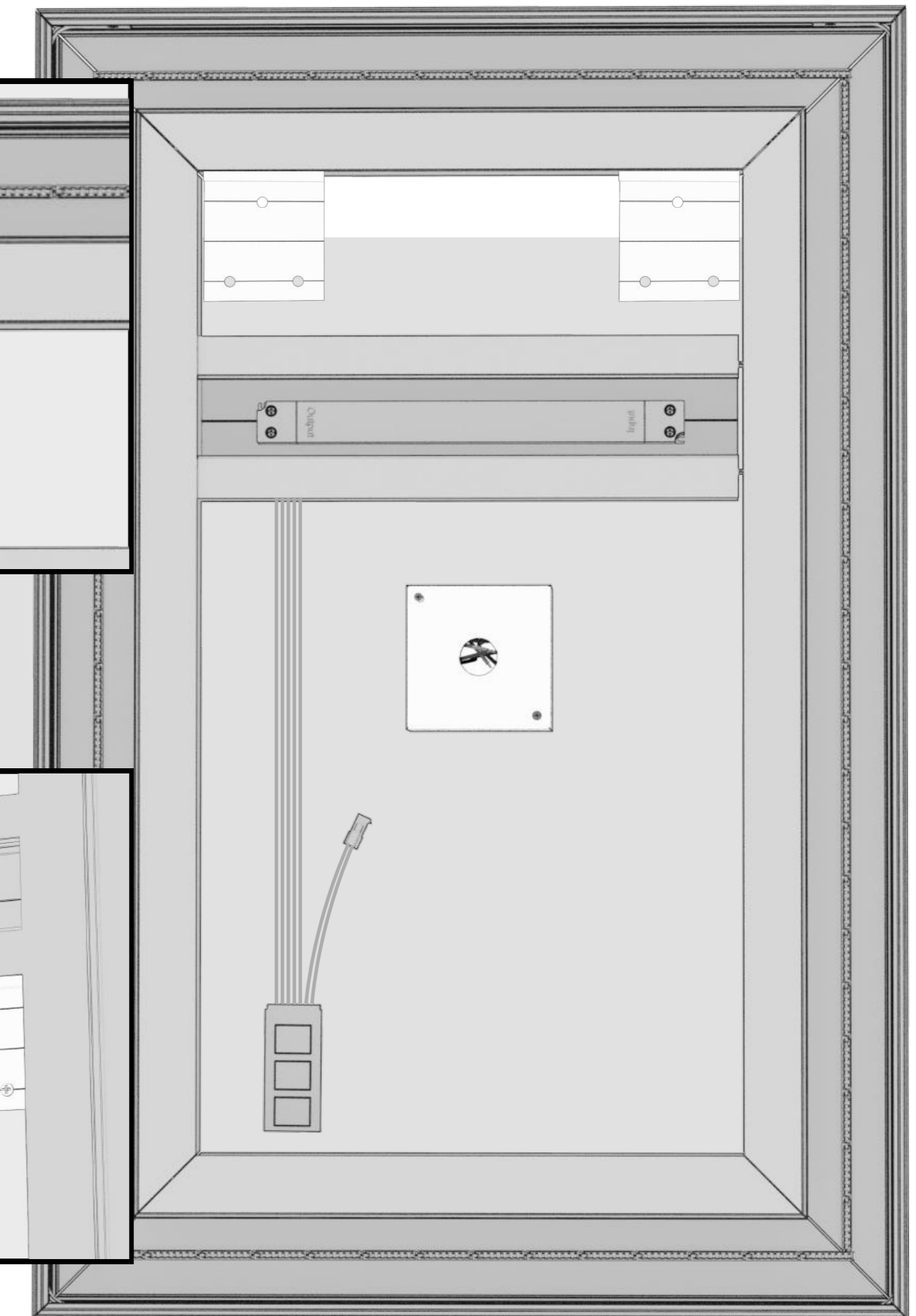

5 Level Bracket

Level the brackets. Mark a straight line for desired wall bracket placement. Larger sizes may require multiple brackets.

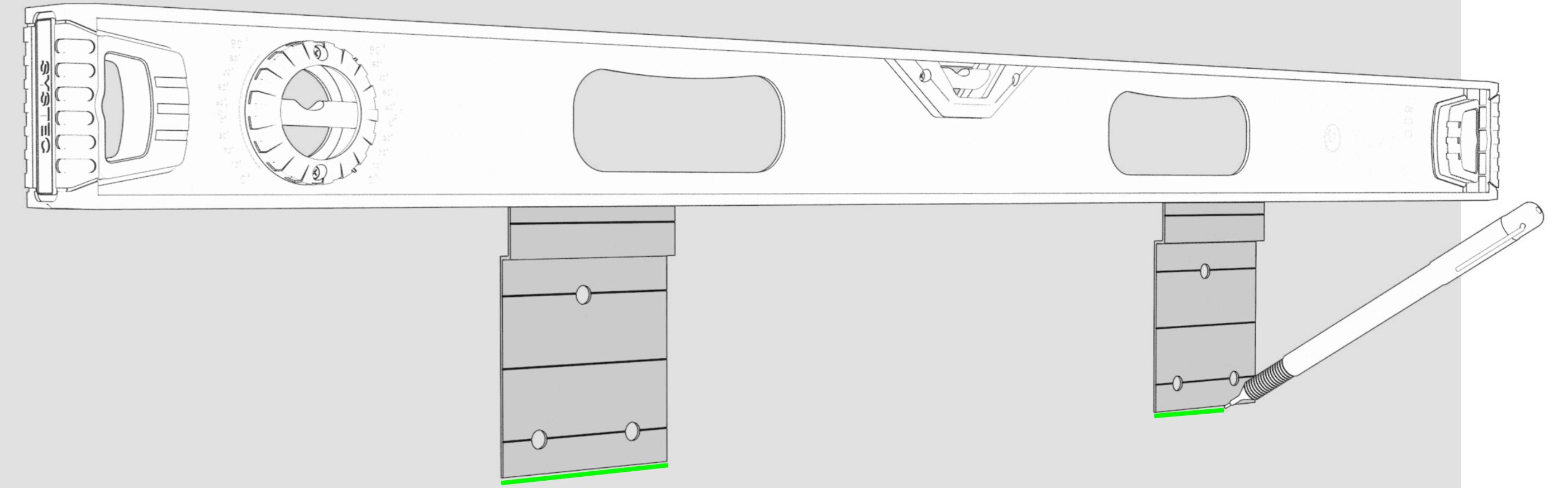

6 Place Brackets

Screw brackets into the wall using screws designed for the mounting substrate.

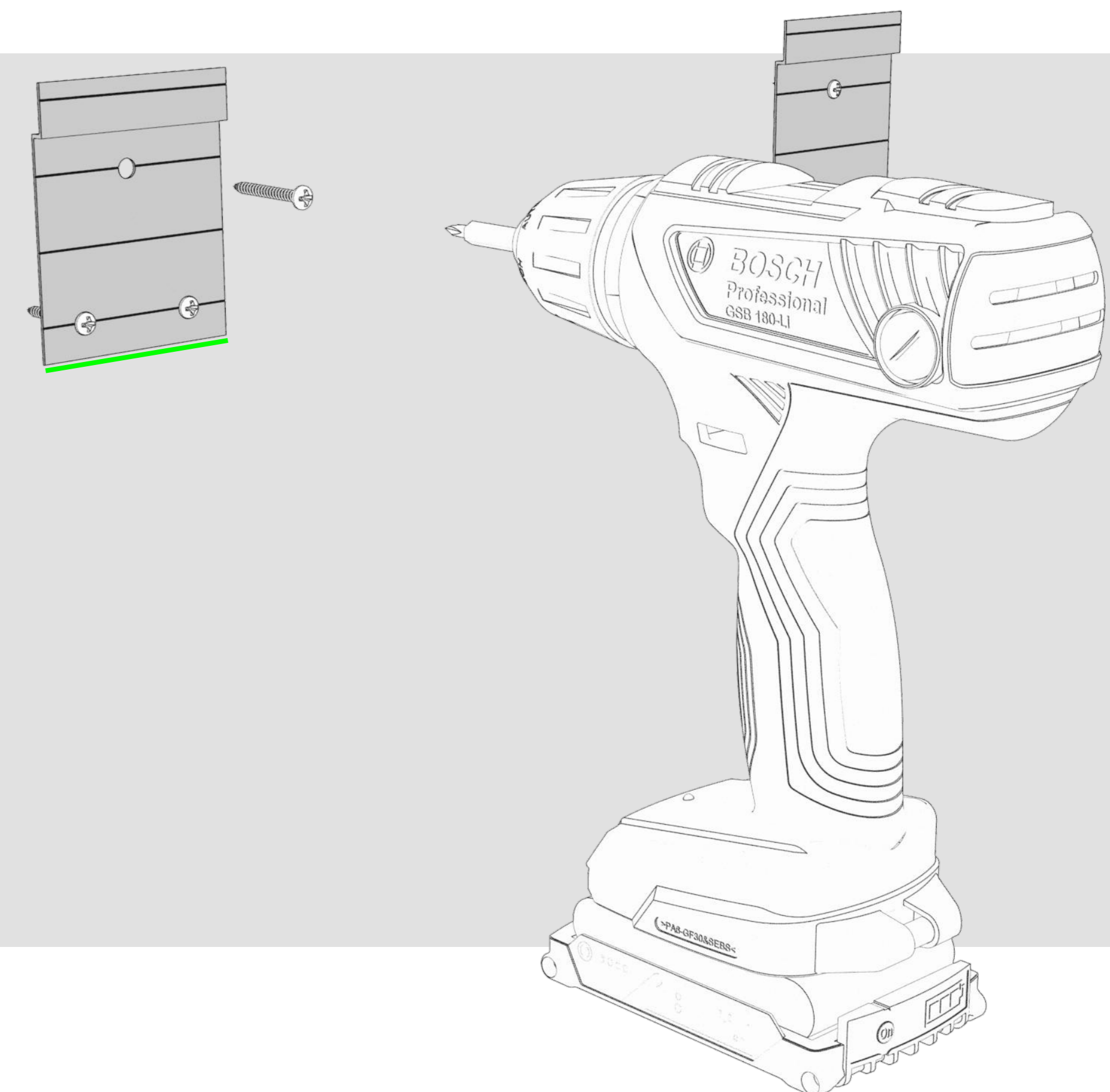
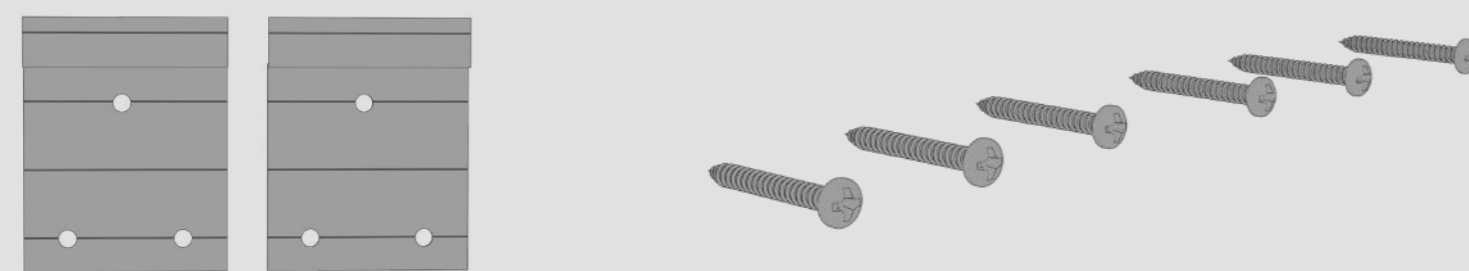

Attention: The wall hanging brackets must be installed into blocking or studs. Sheetrock alone is insufficient. Contact the factory for detailed dimensions.

7 Place Back Chassis

Slide top of chassis or bottom of crossbar into the mounting bracket(s).

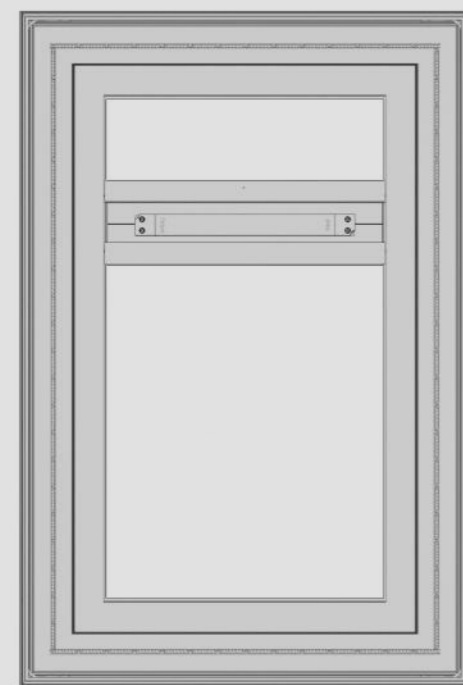

Chassis

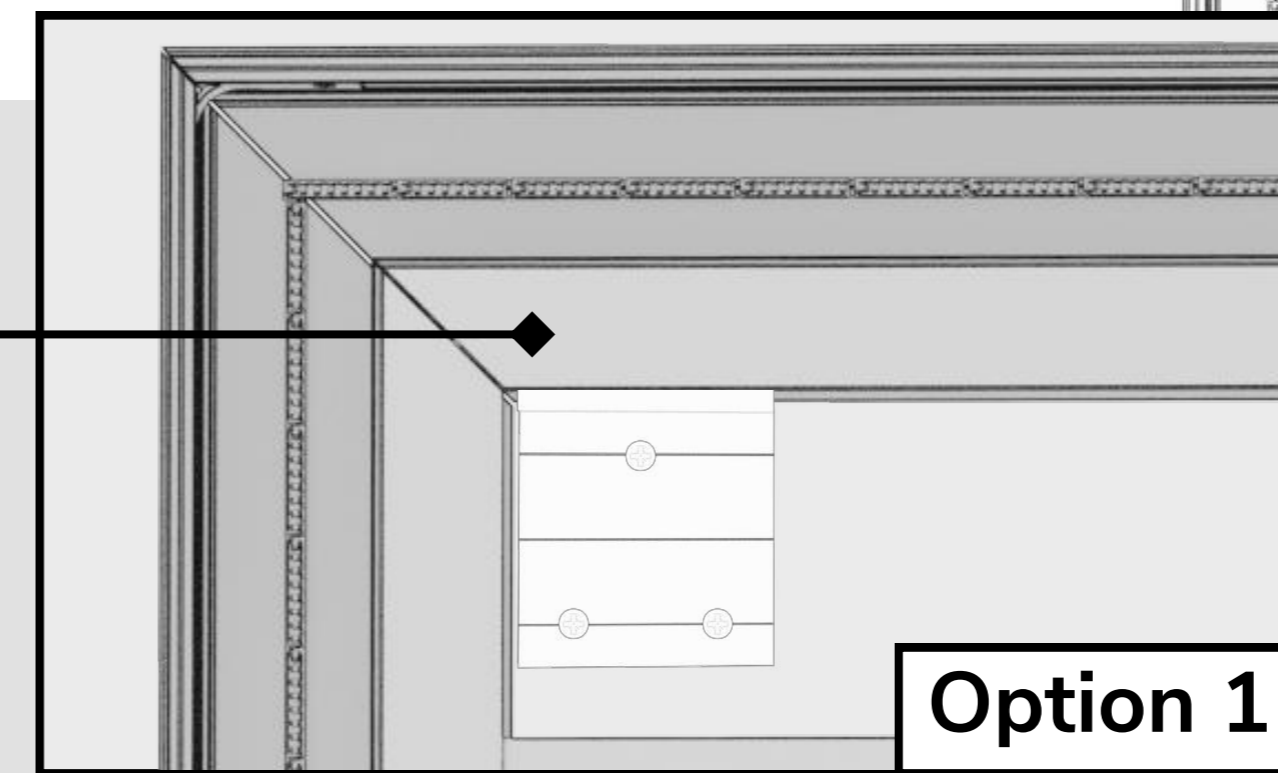

Or

Crossbar

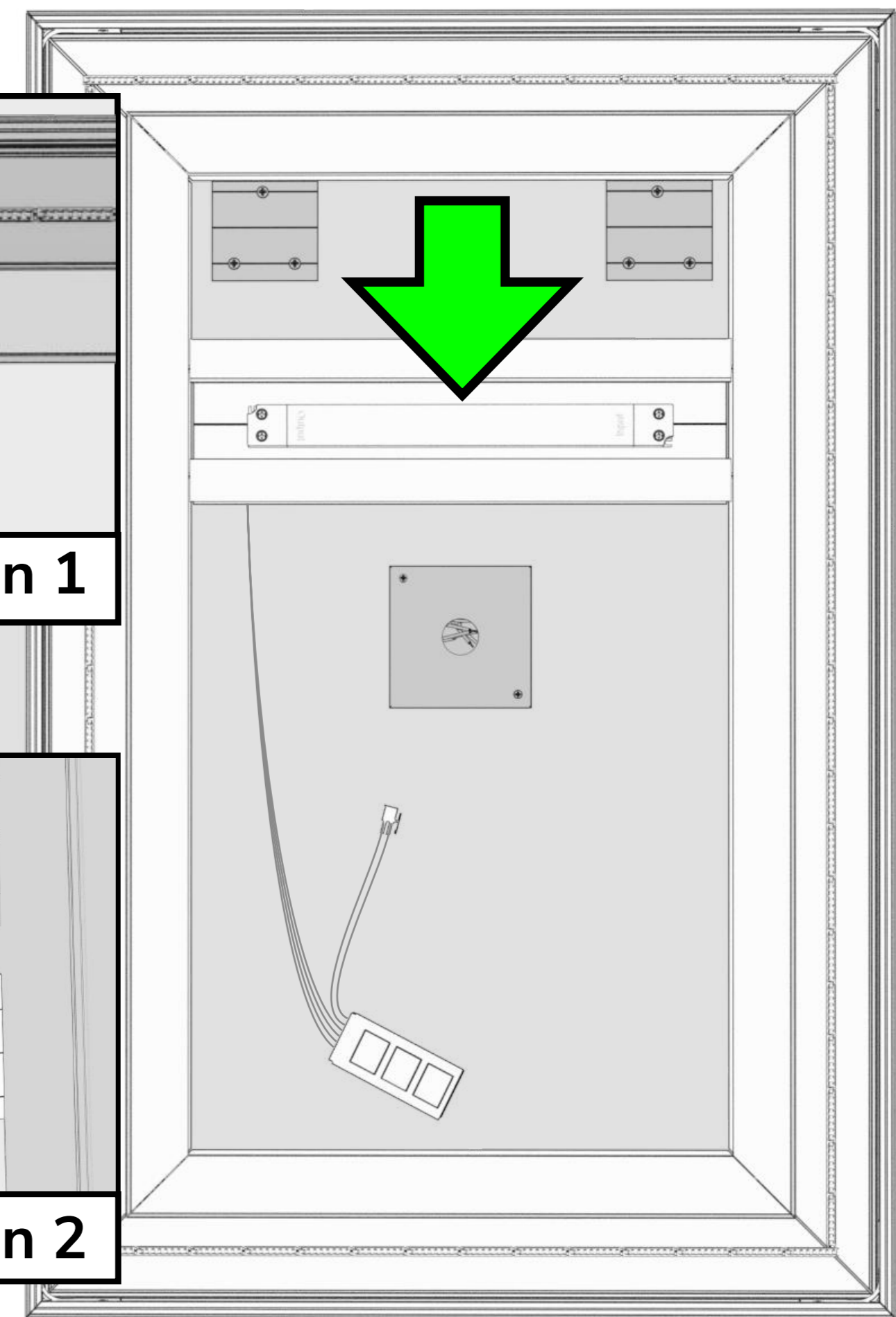
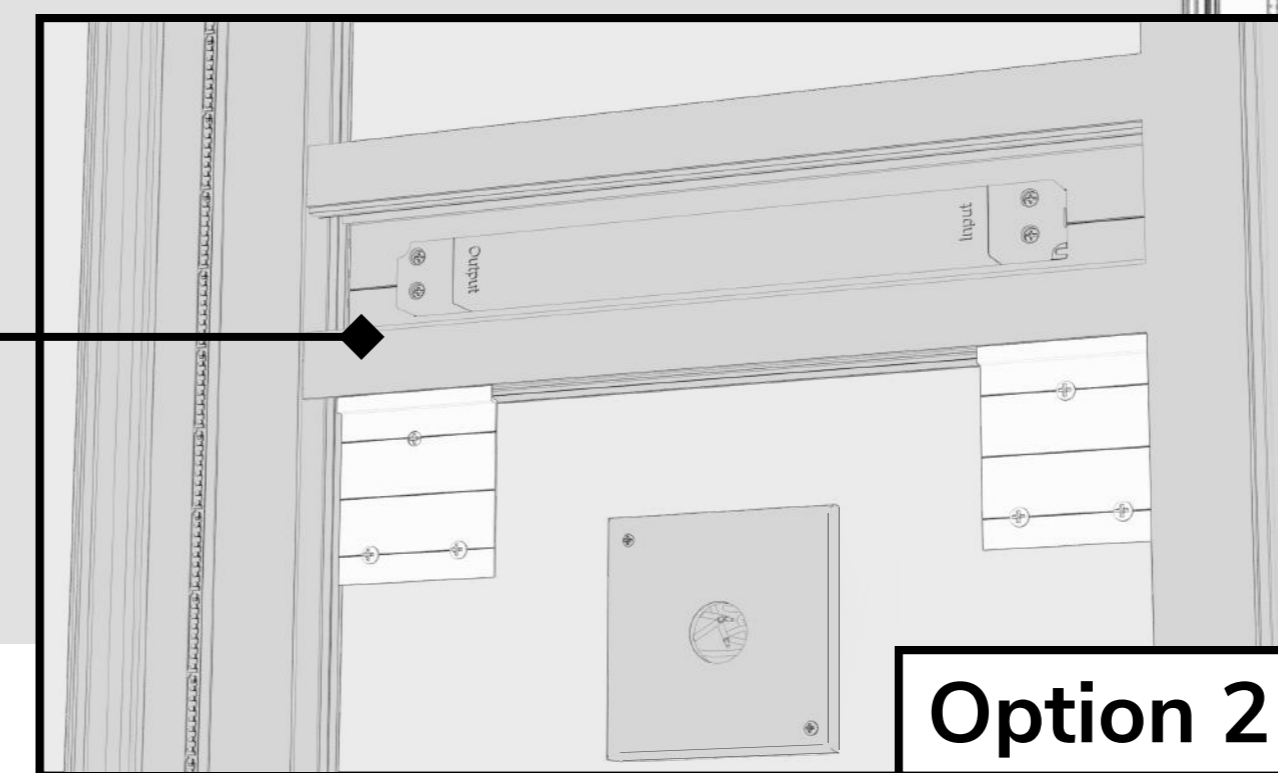

8 Lock Bracket

Level off the chassis, adjust bracket placement by loosening and tightening the screws.

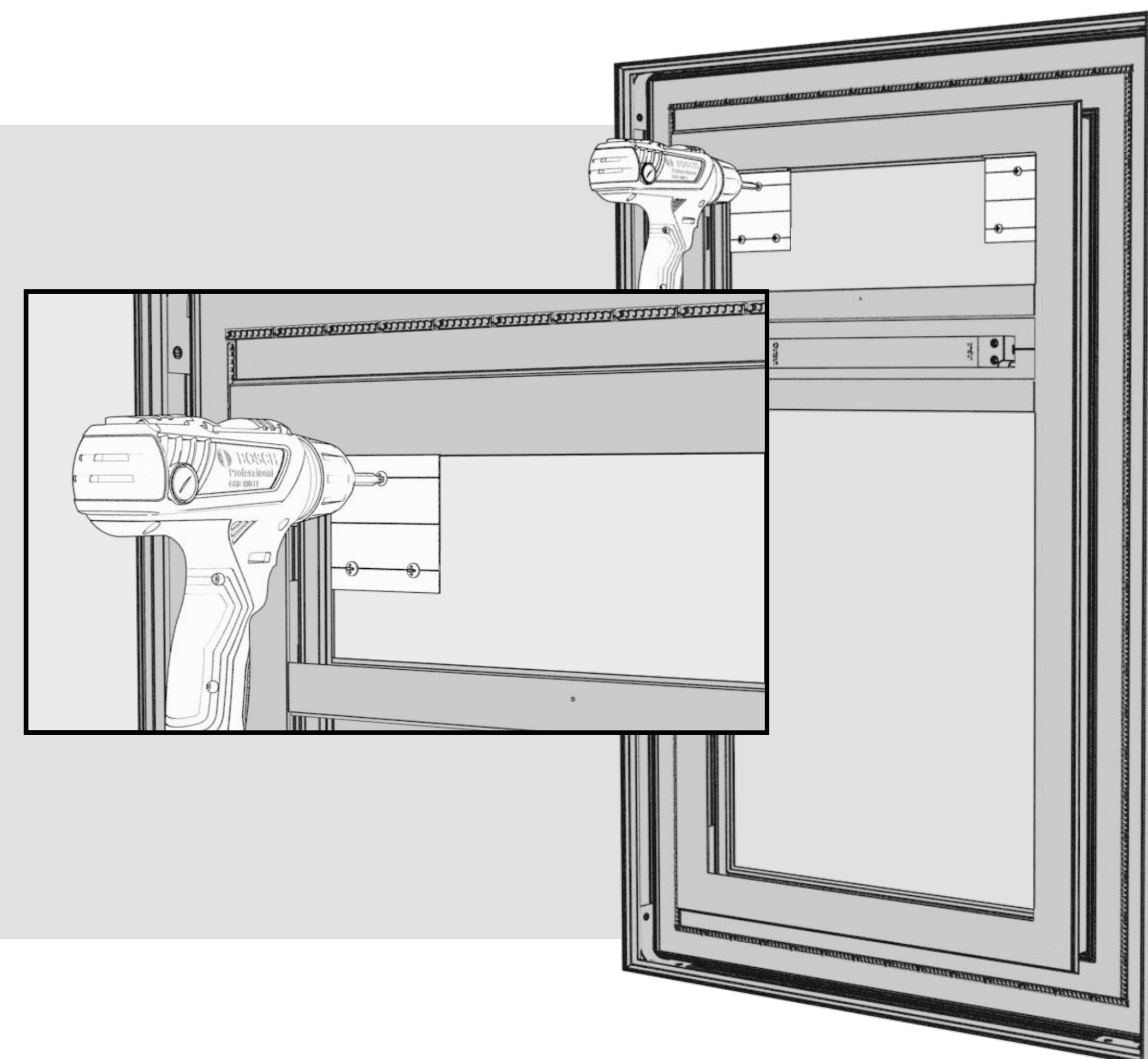
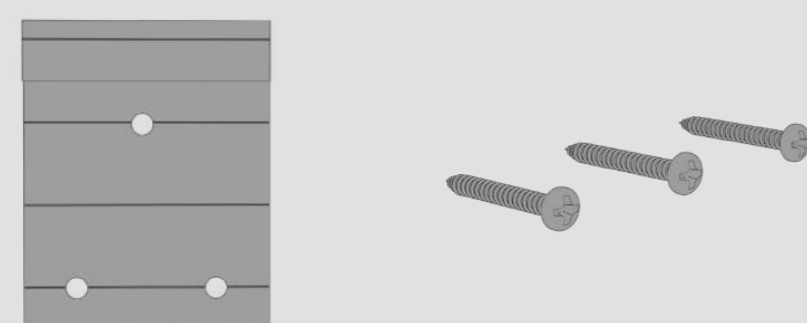

9 Lock Bracket

Lock the chassis to the wall by screwing one or more of the provided smaller brackets, upside down, opposite from the primary wall hanging brackets.

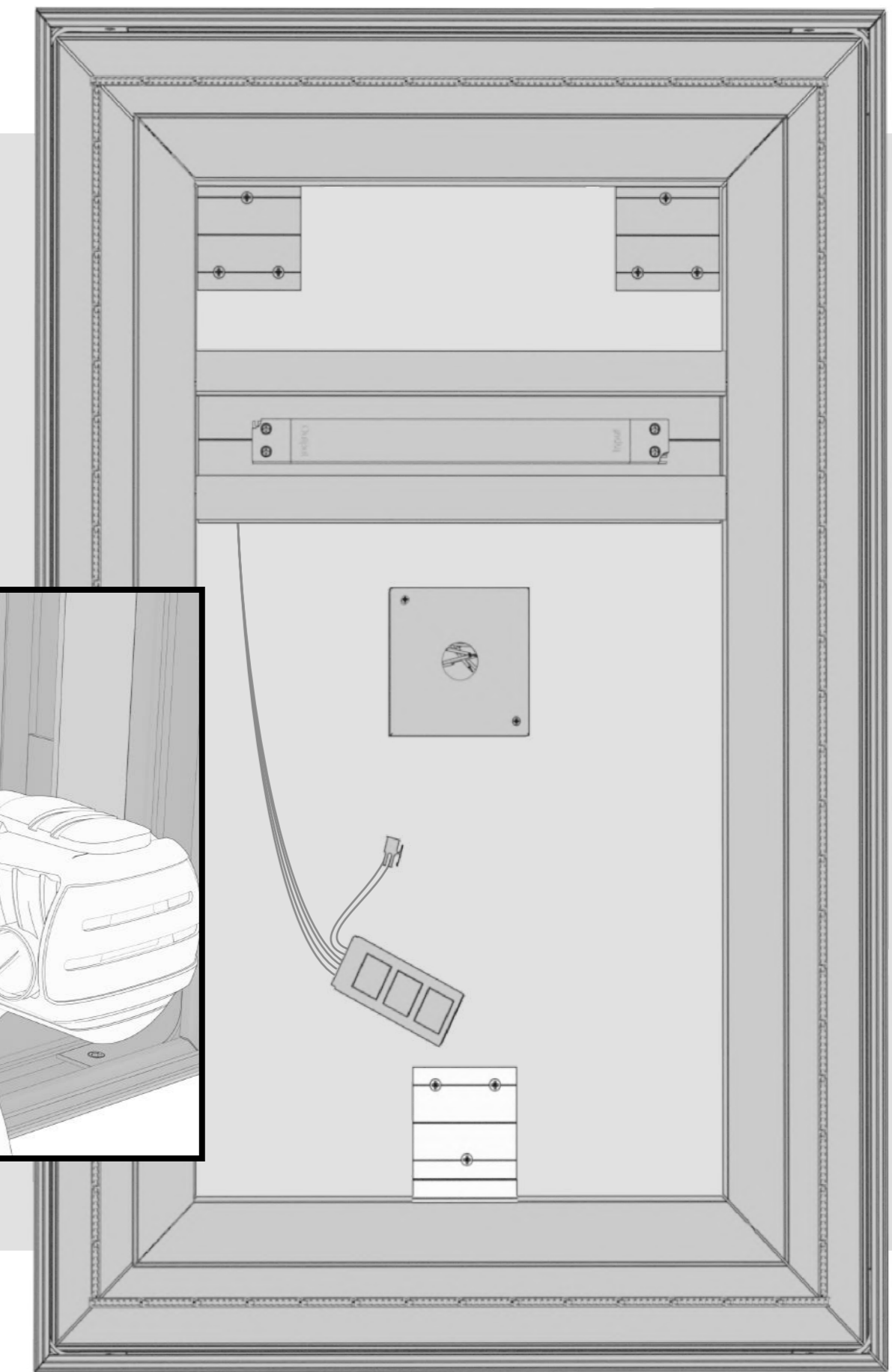
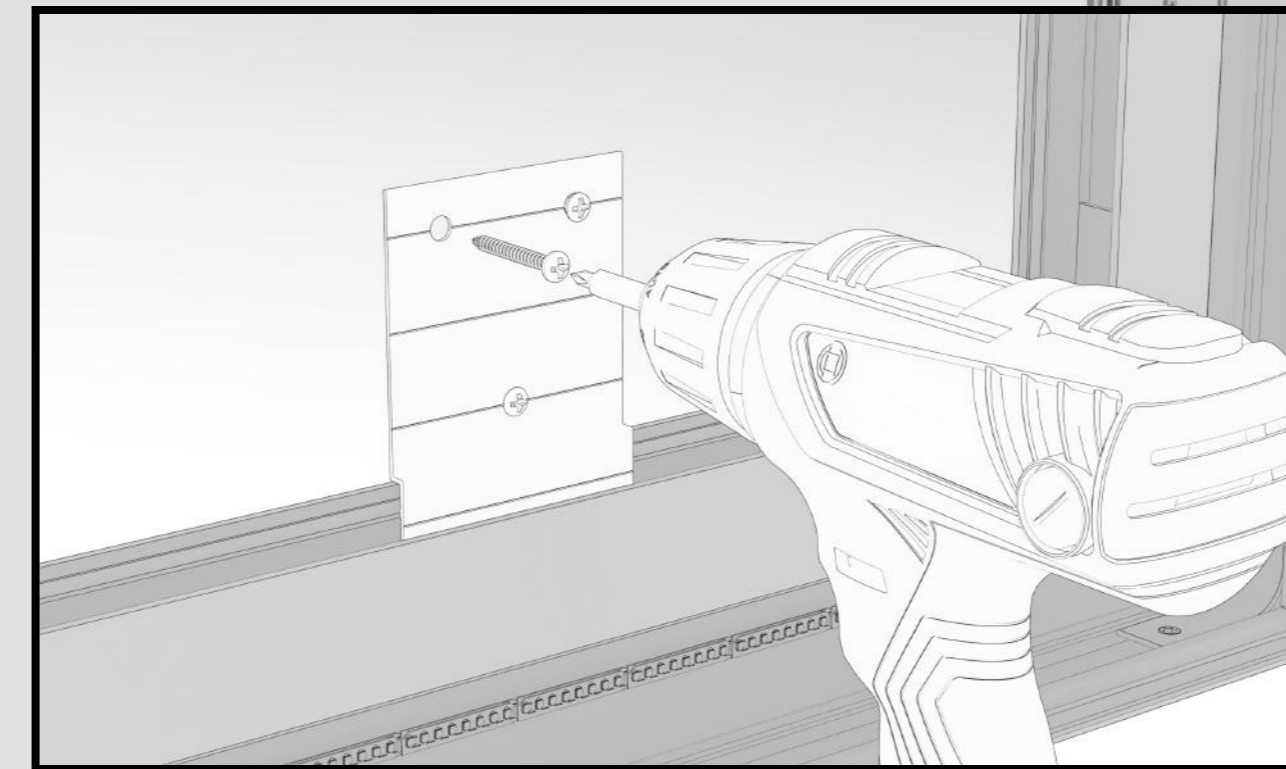
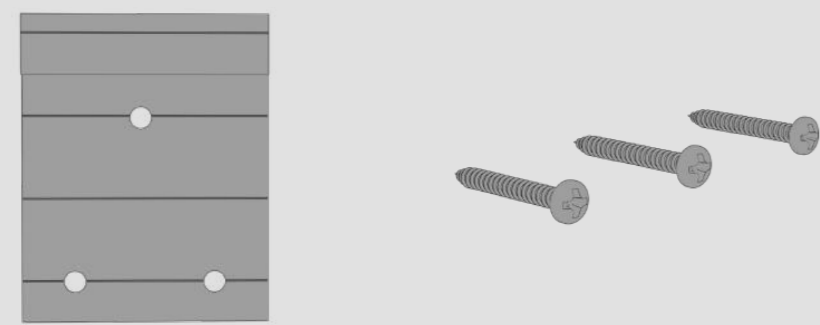

10 Wire connection

Connect the fixture power cables to the junction box cables. Be sure to check fixture voltage information located on the product safety label.

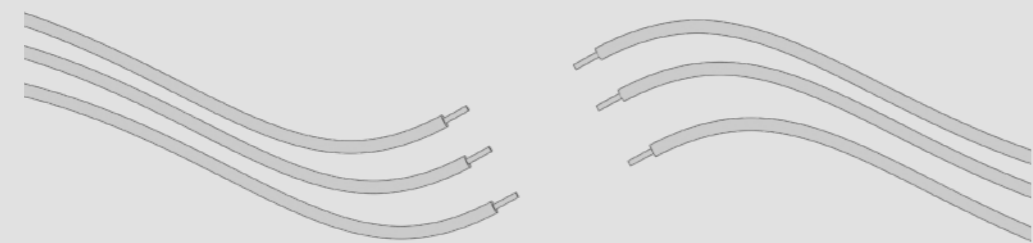

Attention: Power must be shut off before connecting or disconnecting power to the chassis.

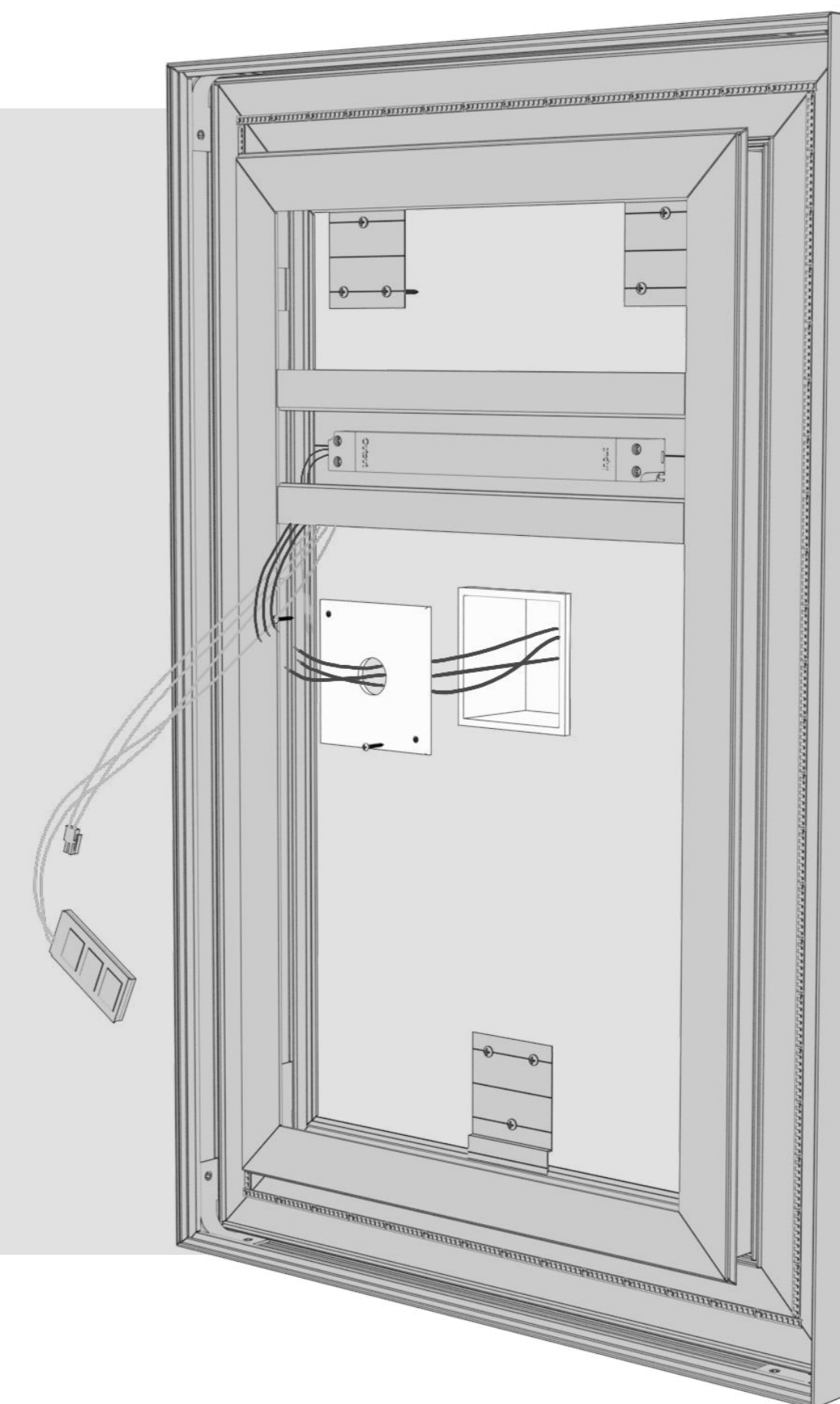



PLEASE REFER TO THE ELECTRICAL SPECIFICATIONS LISTED ON THE MIRROR FRAME TO VERIFY THE CORRECT WIRING CONFIGURATION AND INPUT VOLTAGE. DIRECT & INDIRECT MIRRORS MAY HAVE TWO SETS OF WIRING WIRE TOGETHER OR ON SEPARATE CHANNELS.

Non-Dimming* & ELV Dimming

* Mirrors with touch sensors must be connected to a non-dimming connection.

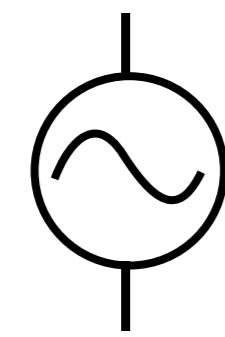

100-277 VAC
50-60Hz

Refer to fixture label to confirm electrical specifications

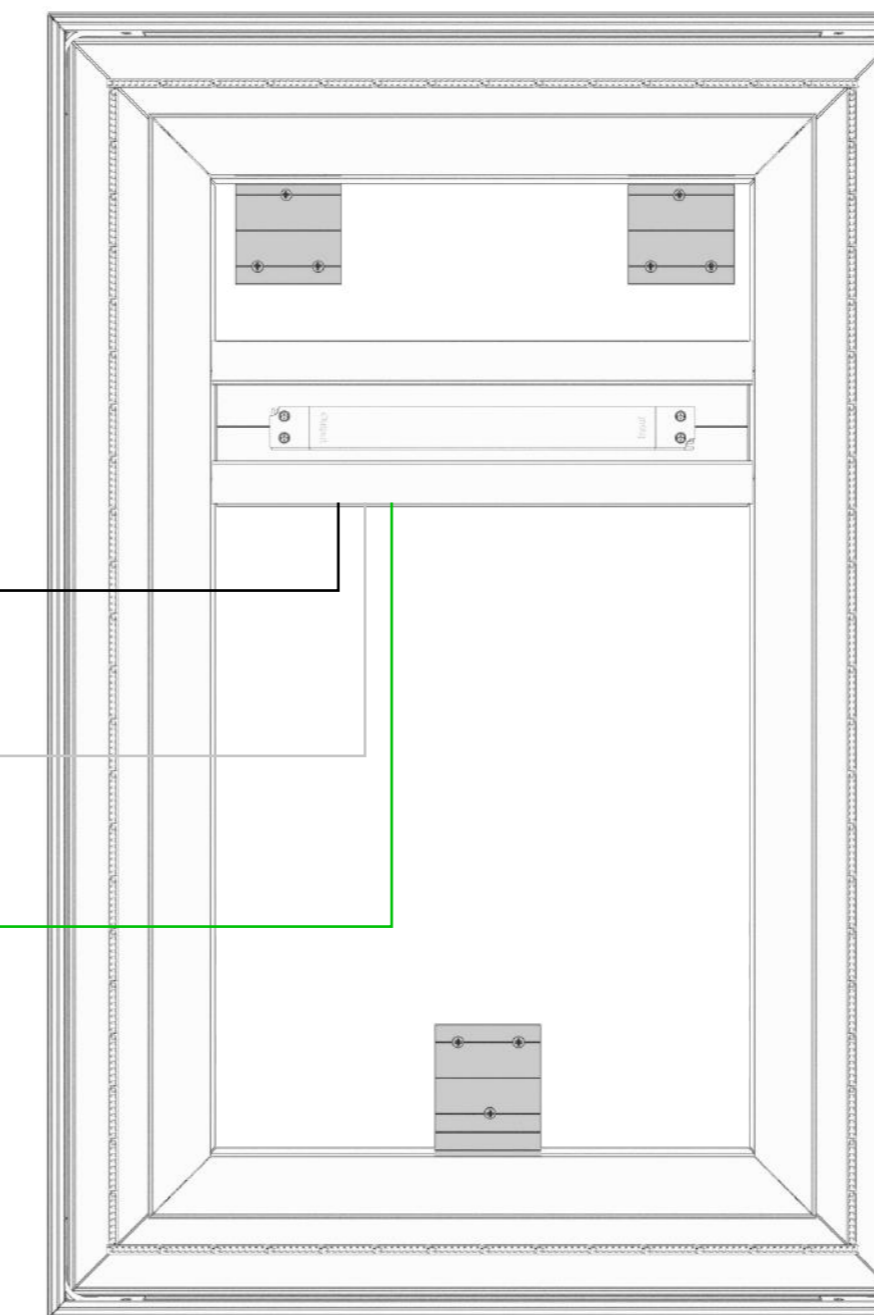
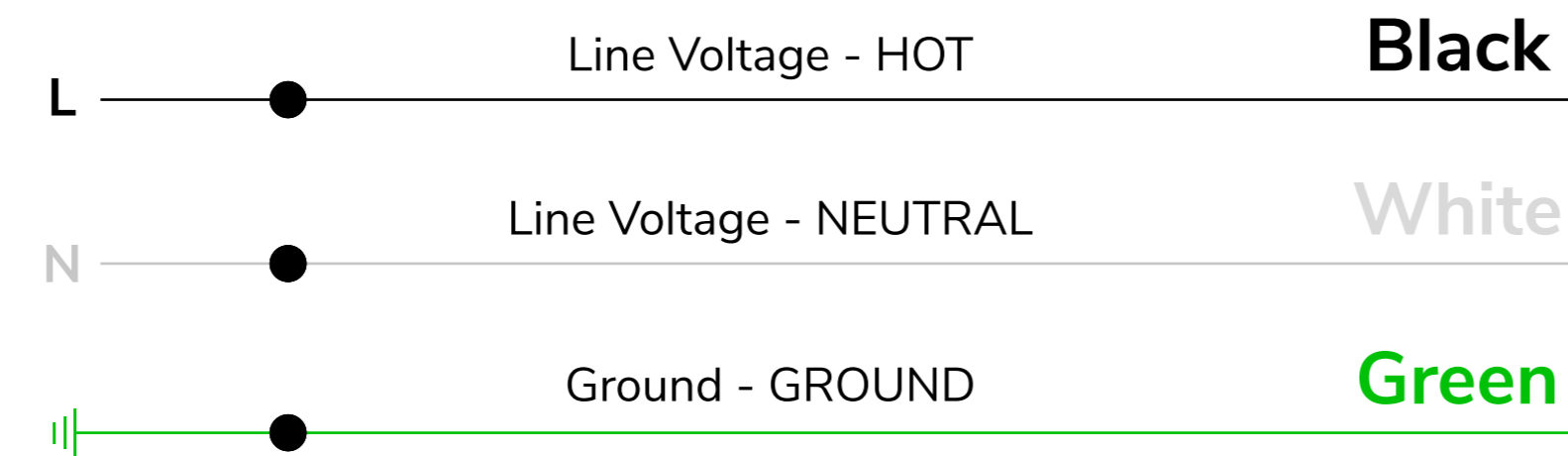

0-10V Dimming

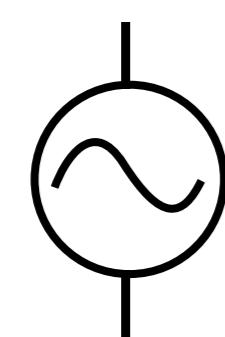

100-277 VAC
50-60Hz

Refer to fixture label to confirm electrical specifications

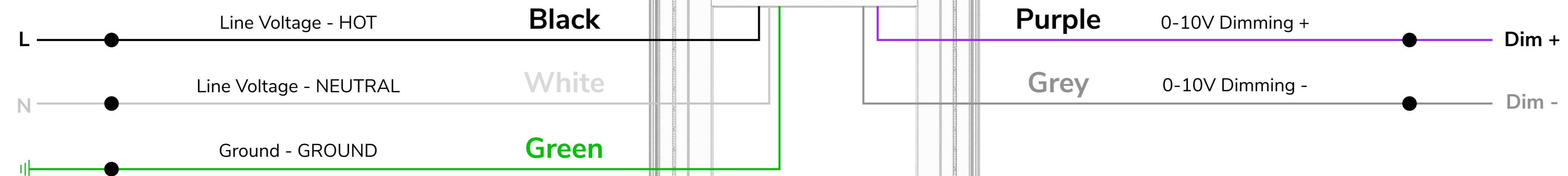

11

Cover Junction Box

The power installation is not complete until the high voltage connection is covered. Use a cover compatible with the installed junction box.

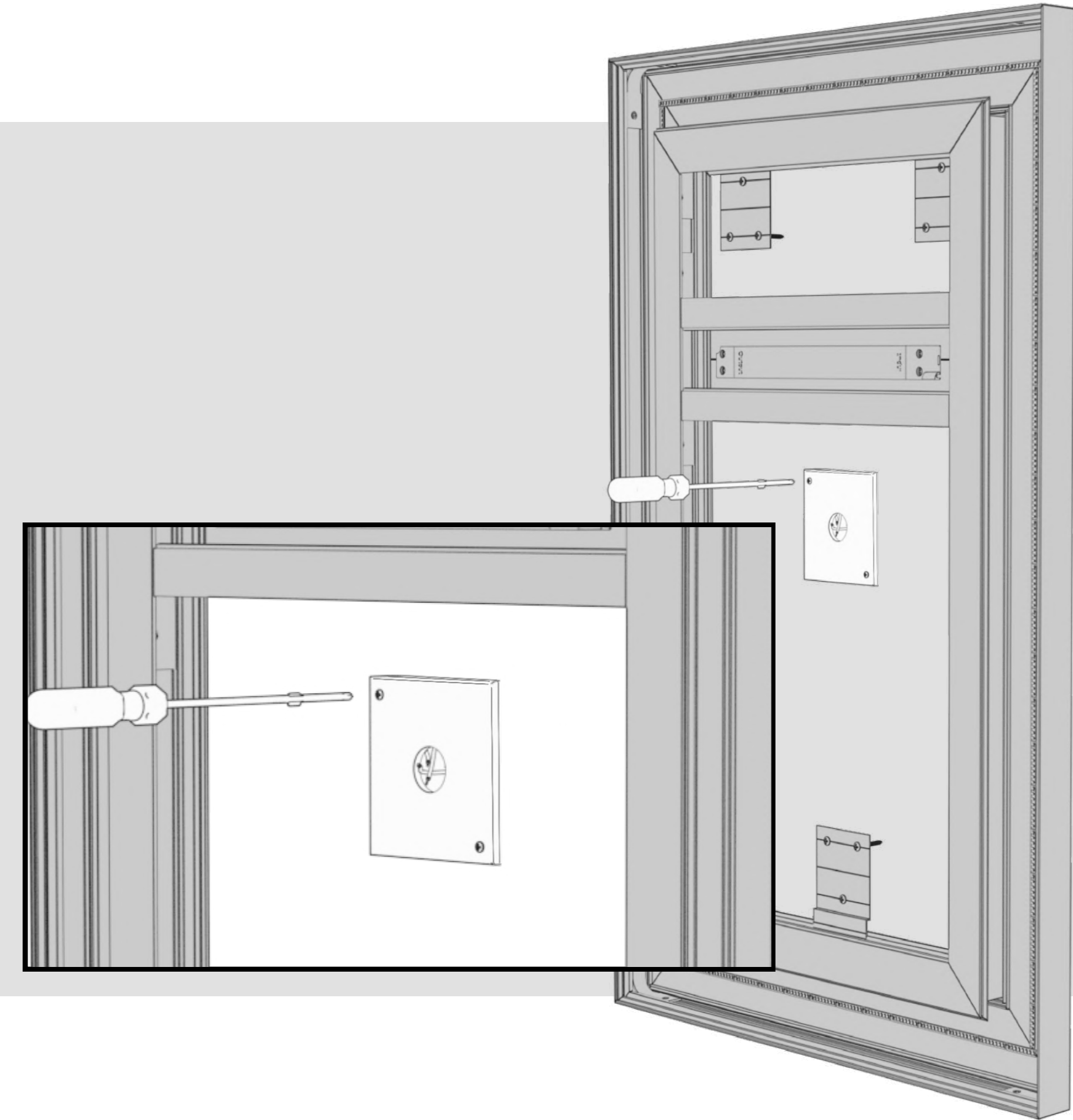

12

Connect demister, slide in touch sensor

* Optional accessory step

Connect demister with Molex connector and slide touch sensor back to its clip.



Attention: Watch the glass corners carefully, and place a soft barrier on hard surfaces or bathroom fixtures near the glass installation location.

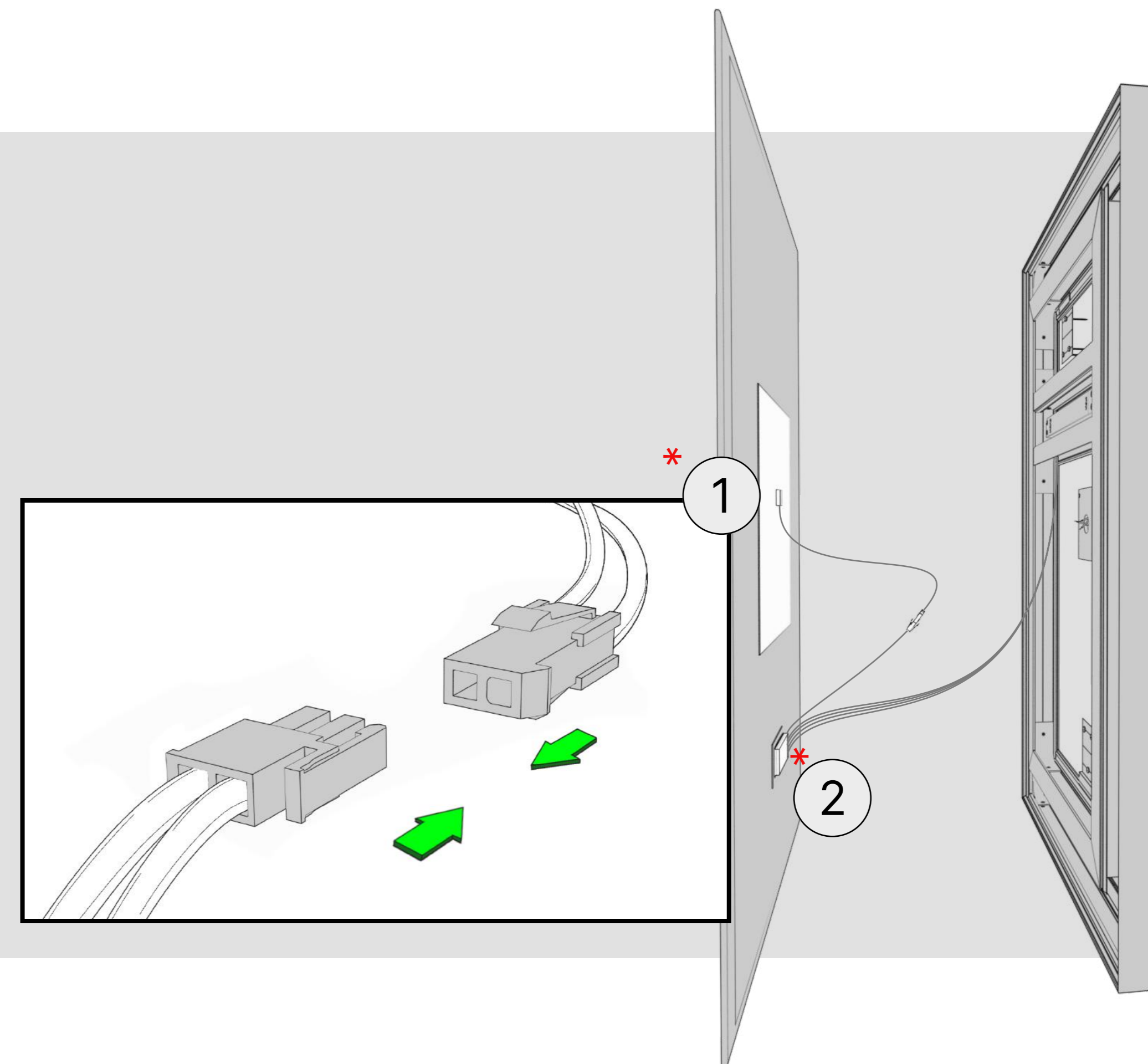

Demister Connection

Can be on at all times or connected to non dimming switch

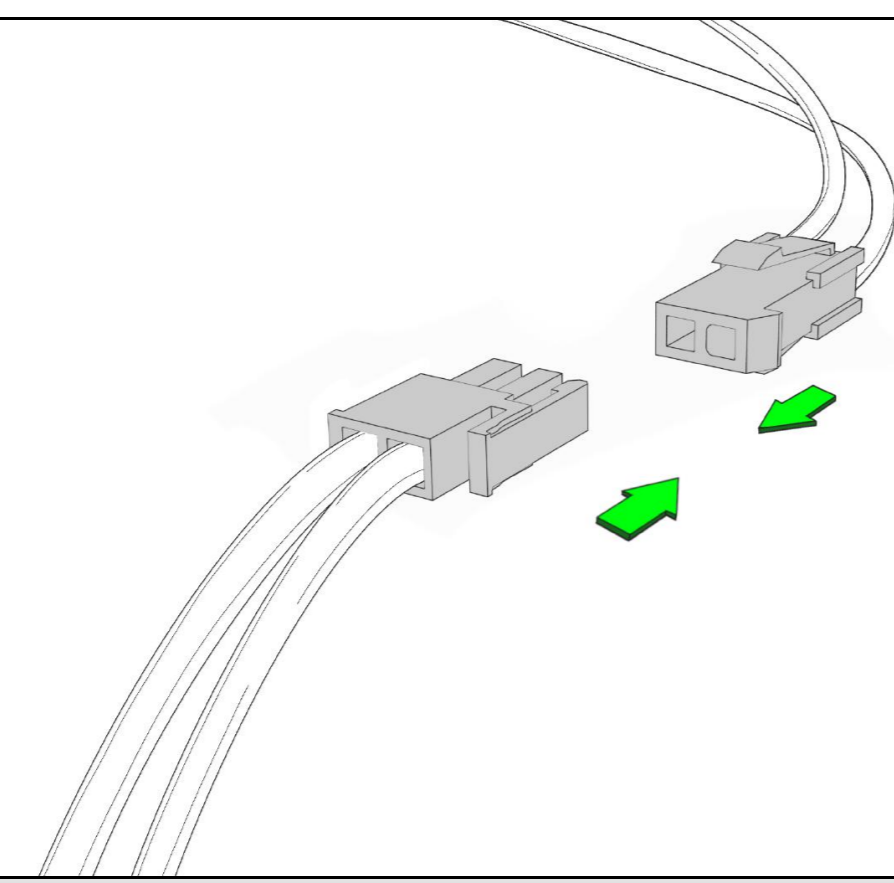
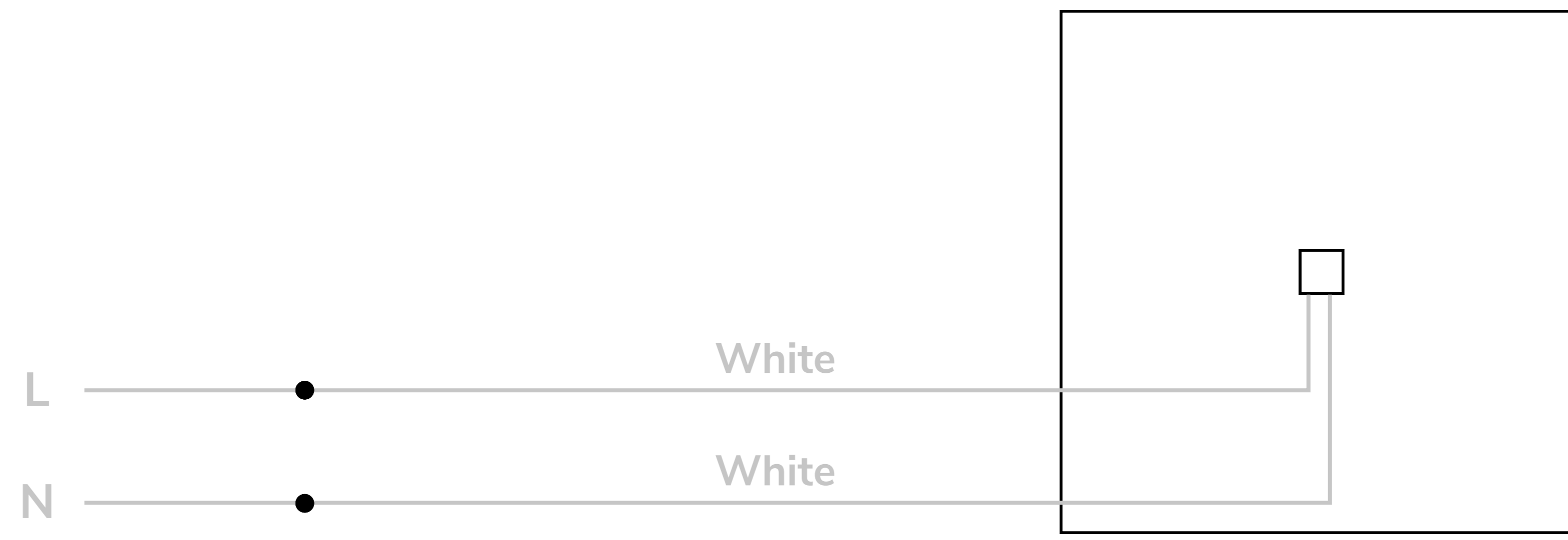

Molex

- Connect to designated 24V low voltage Molex

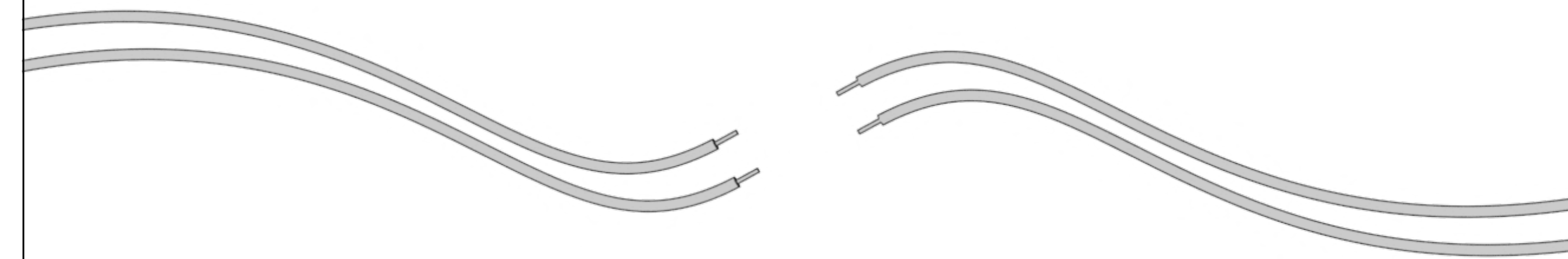

Hard Wire

- Hard wired to 120V non-dimming

13 Place Glass

Slide glass into position and make sure that all brackets are engaged.

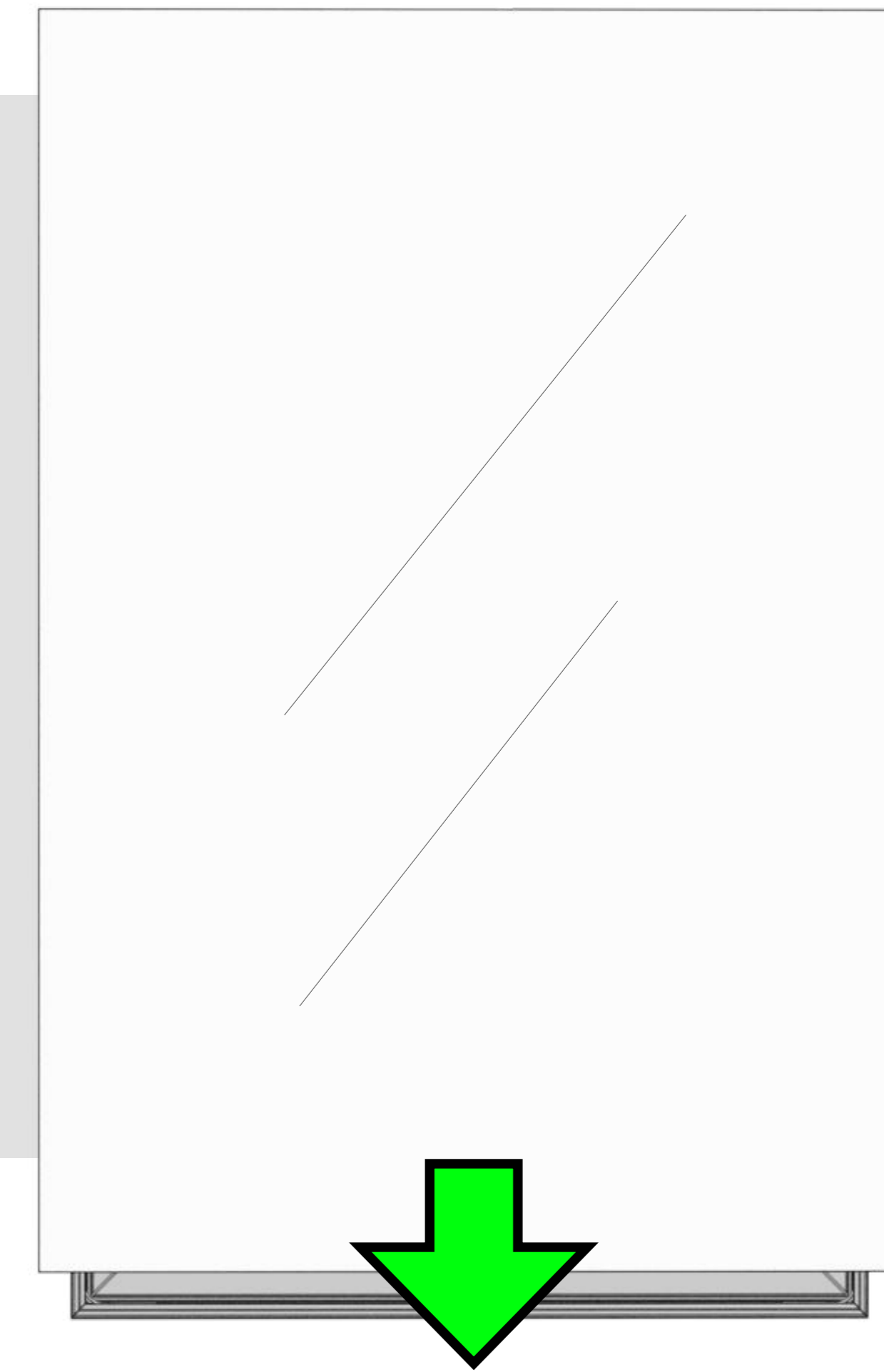
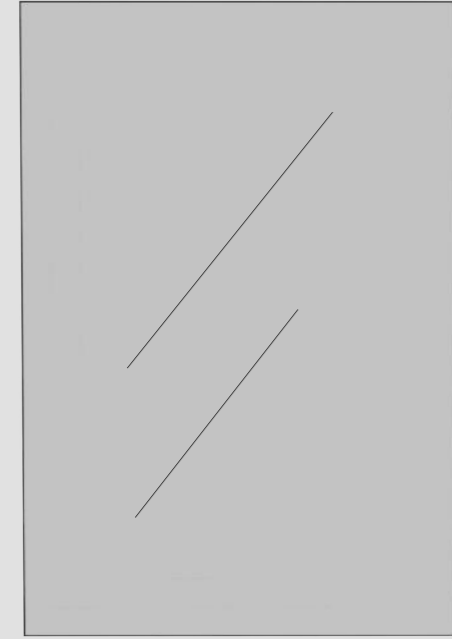

14 Double Check Glass

Double check glass, make sure all brackets are slid into chassis and crossbar.

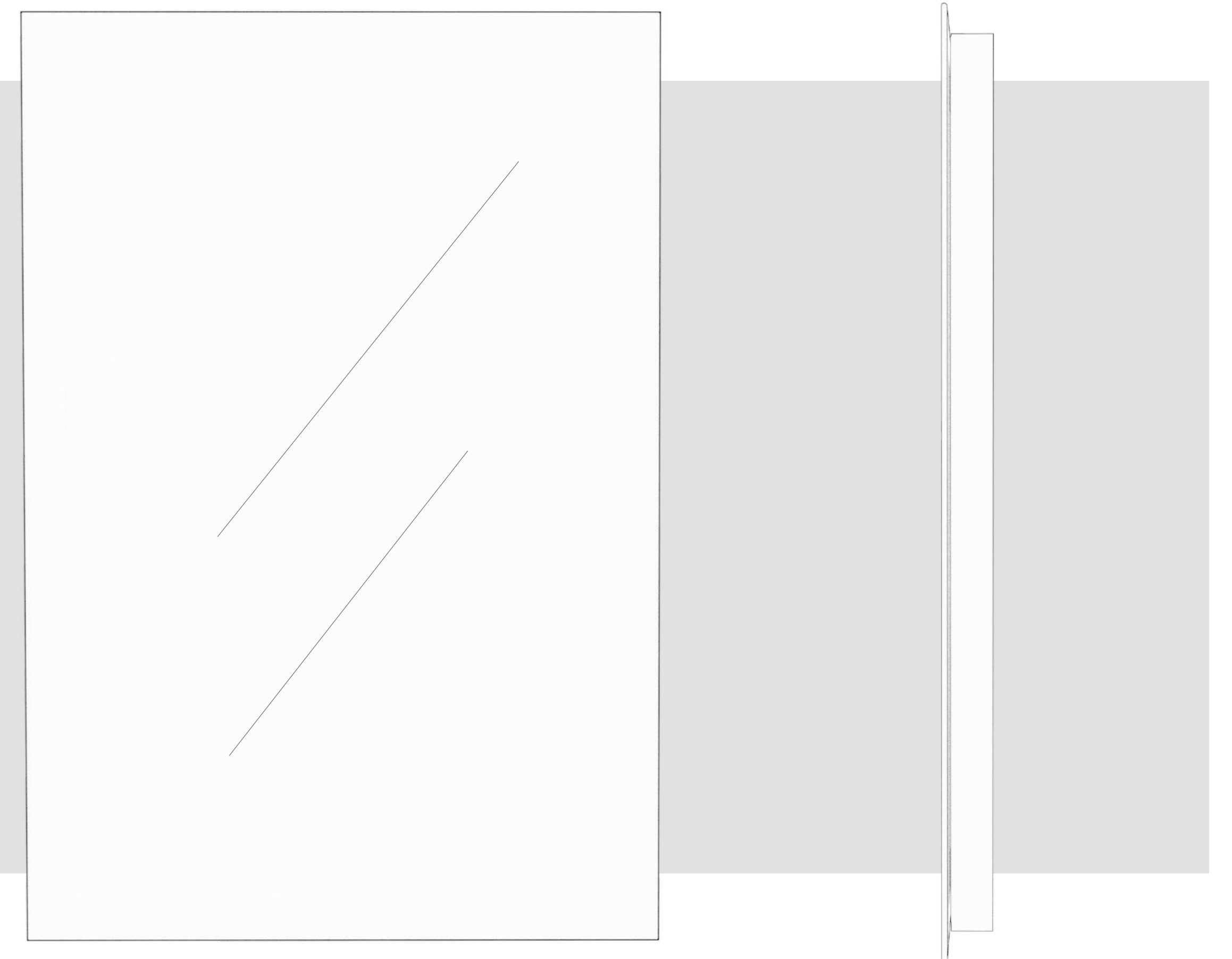
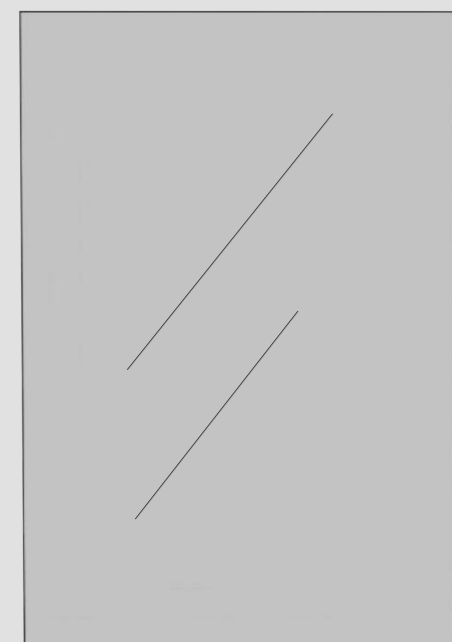

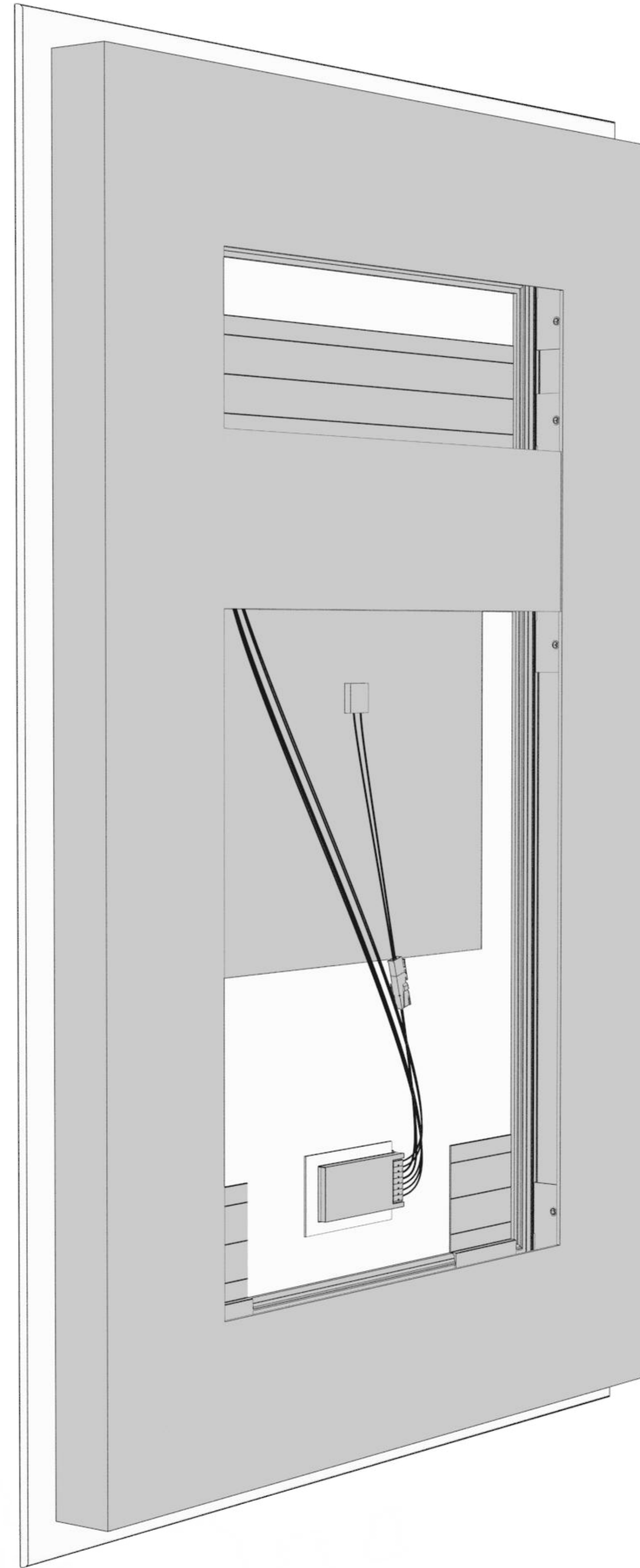
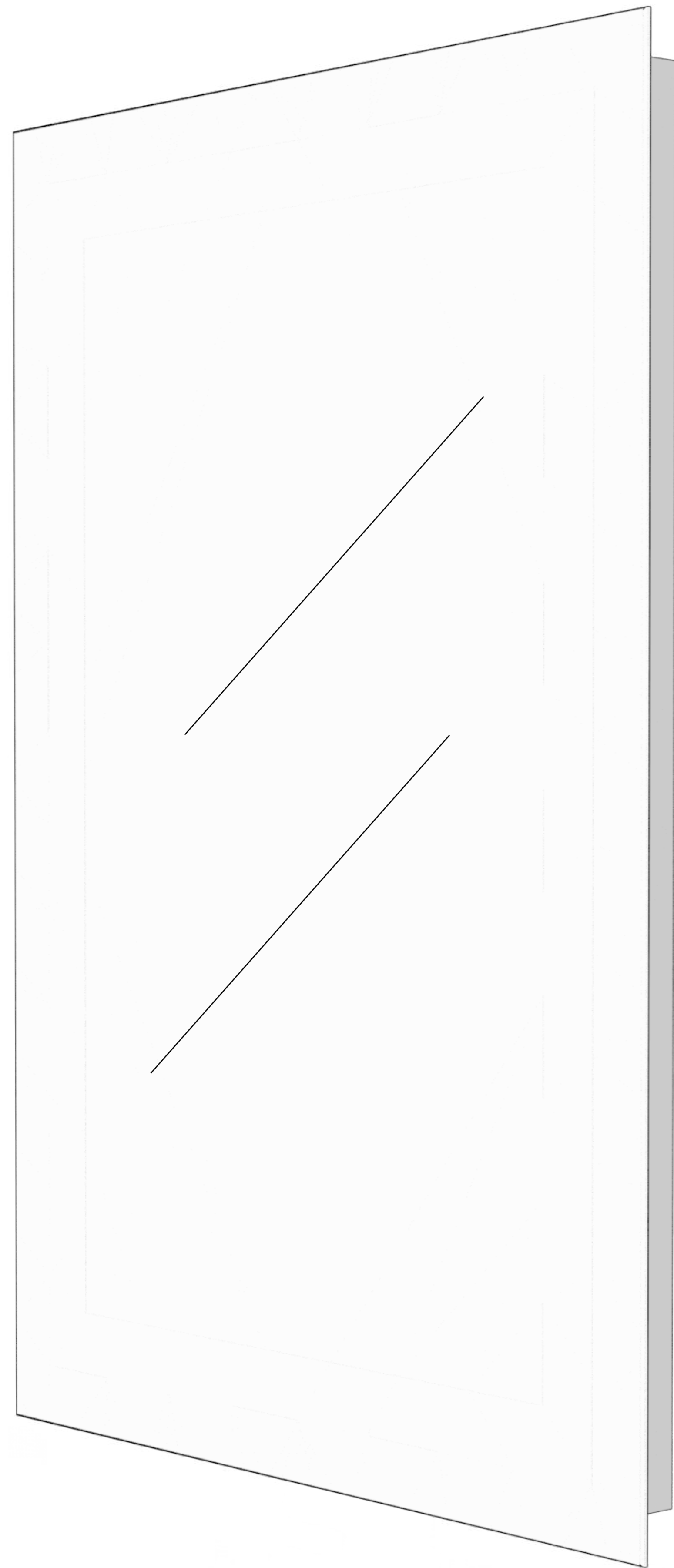

Thank you

for your purchase of this American made product

Regardless of where you purchased your Matrix
Mirrors product, if you have any questions or
issues, please call us at

(678) 580-5717

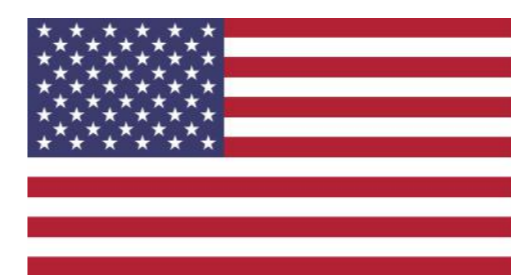

Made in USA

(678) 580-5717

5965 Peachtree Corner East, Suite A-1, Norcross, GA, 30071