

Unique Carpets, 58-Pin 2-Tier Instructions

Product No. 8750

Dimensions D=28" W=72" H=83"

Sheet 1 OF 4

PARTS LIST

1. Base
2. Leg (2)
3. Bedframe (2)
4. Wing (4)
5. Right Header Post
6. Left Header Post
7. Header Sign
8. Top Center Graphic
9. Bottom Center Graphic

Display Color: Satin Nickel

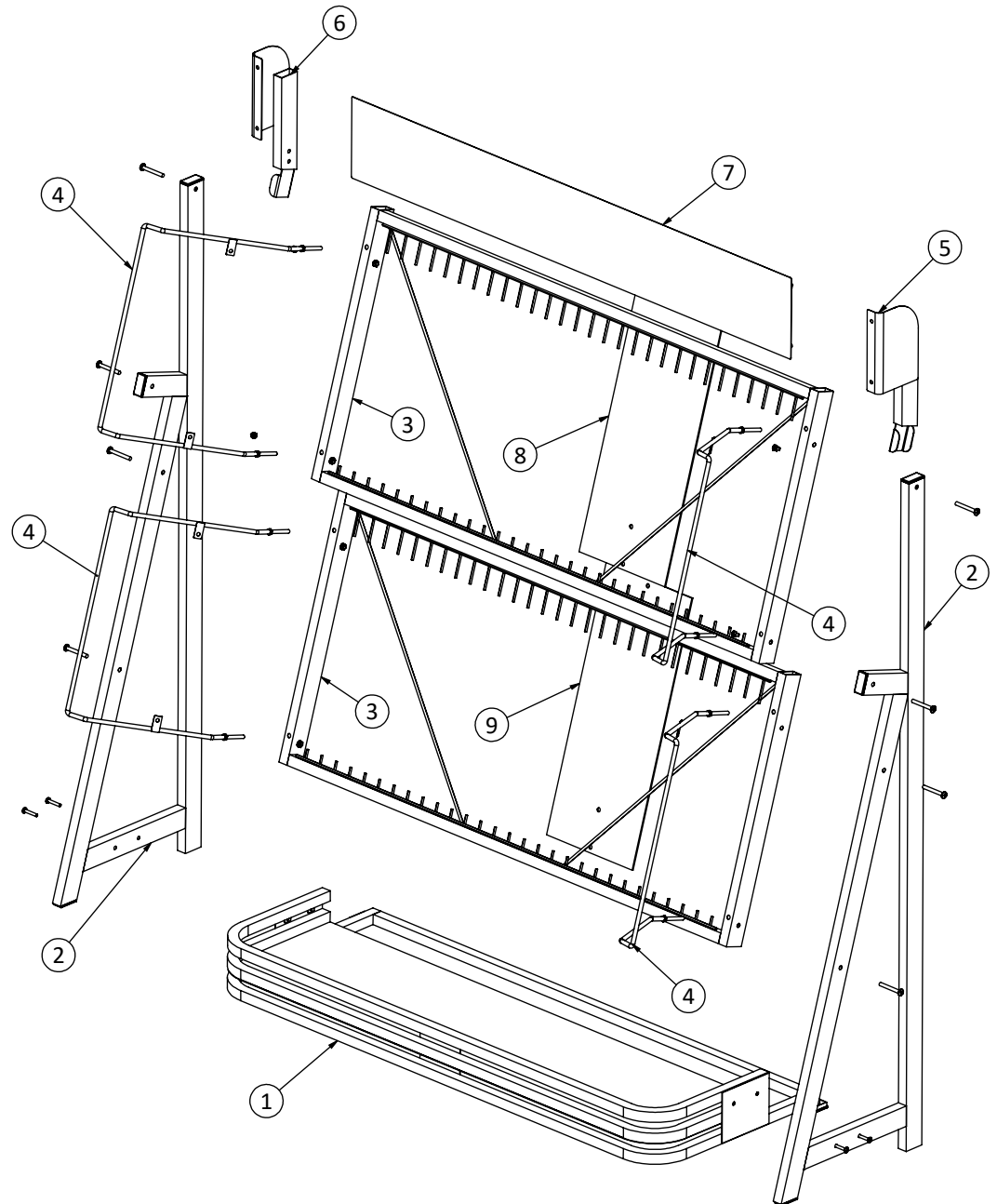
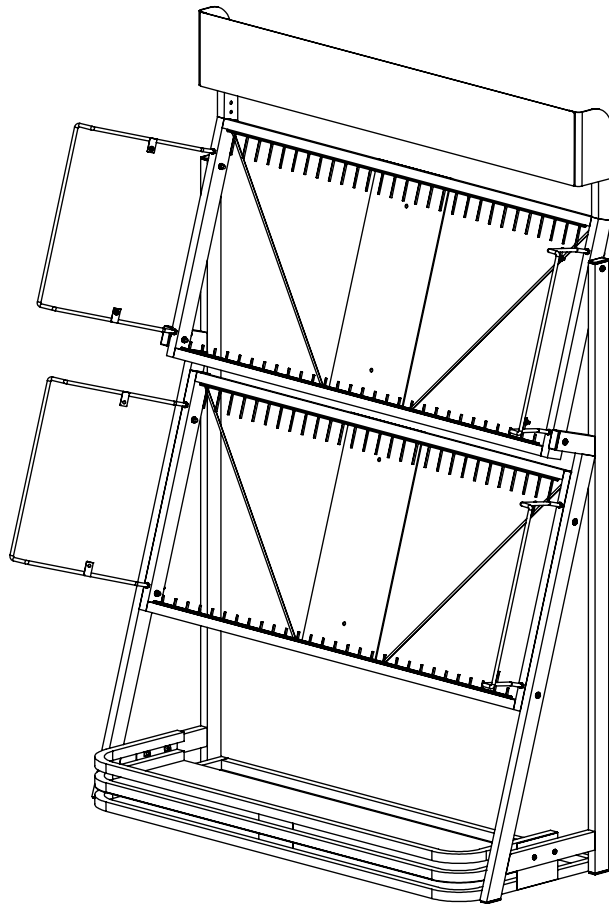

Caution: Do not move display without unloading samples or product!

BEFORE BEGINNING ASSEMBLY

Read entire instruction sheet and safety instructions before you start assembly and installation. If you have any questions or do not completely understand the instructions and warnings please contact **Displaycraft Customer Care at 1-800-537-0299** before beginning assembly.

!!!WARNING!!!

Failure to follow these assembly and safety instructions may result in serious bodily injury or property damage and will void the warranty. Displaycraft Inc. is not liable or responsible for personal damage caused by failure to follow these instructions and warnings.

SAFETY INSTRUCTIONS

- Two people are required to move, unpack and assemble this display
- Assembly should be performed by someone with good mechanical aptitude who completely understands the instruction sheet
 - This display is intended for indoor use only
- Install display on a stable, level surface that will support the fully loaded display
 - Assemble the display in the area it will occupy
 - Never attempt to move the display after loading it with product
- Identify and inventory all parts using the Parts List provided in the instruction sheet. If any parts are missing, do not proceed. Instead call **Displaycraft Customer Care at 1-800-537-0299**.
- Tighten screws firmly. Do not over-tighten. Over-tightening screws can damage the display and compromise its strength. Do not allow persons to climb on, hang from or lean on the display or any part of the displayed components. Doing so could cause the display to tip over.
- This display is designed to hold only the products do not load, attach or store any other products on this display.
- After assembly is complete, double check all connections, screws and other display components to make sure they are secure and the display is stable.
- Regularly inspect the display to make sure all connections, screws and other display components remain tight, secure and safe.
- Retain this instruction sheet for future reference and in the event replacement parts are needed.

Caution: Do not move display without unloading samples or product!

HARDWARE

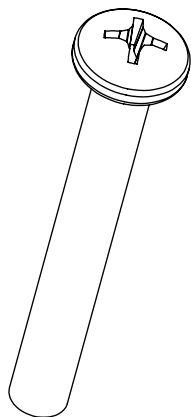

2-1/2" BOLT
Qty: 8

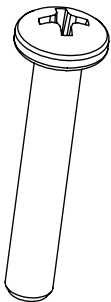

1-1/2" BOLT
Qty: 4

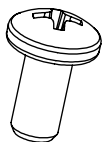

1/2" BOLT
Qty: 4

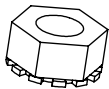

HEX NUT, SMALL
Qty: 8

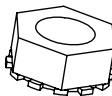

HEX NUT, LARGE
Qty: 16

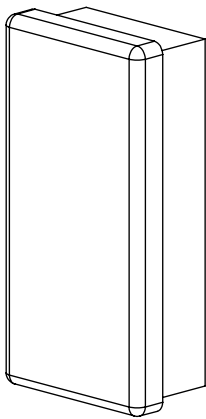

PLASTIC END CAP
Qty: 8



SCREW
Qty: 4

Caution: Do not move display without unloading samples or product!

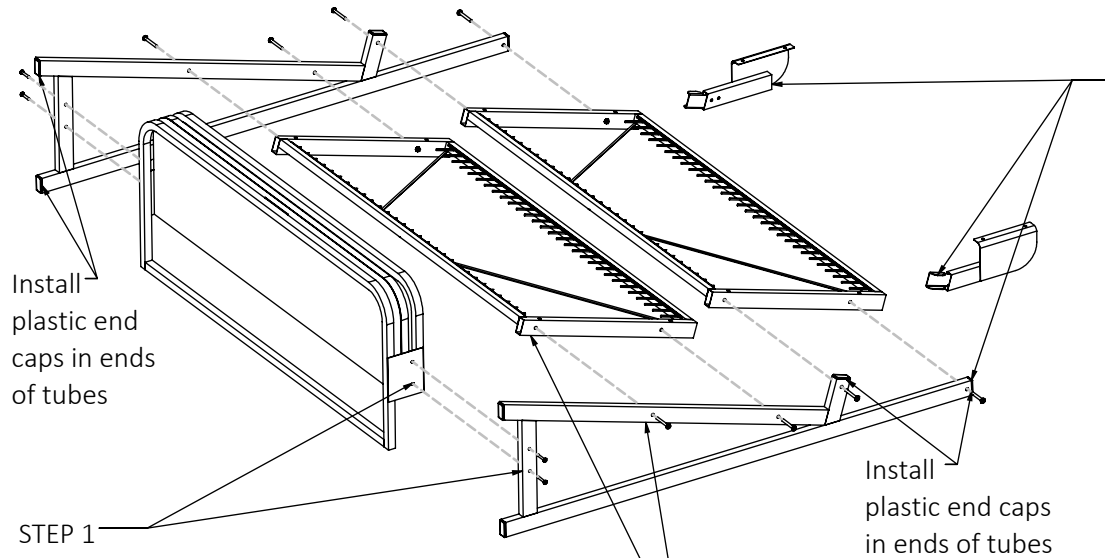

STEP 1
Install plastic endcaps into both leg tubes where indicated. Then, with the display on its back, attach the legs to the outside of the base with four 1-1/2" bolts. They will feed into pre-installed nuts. Do not fully tighten the bolts.

Step 2
Use four 2-1/2" bolts to attach each bedframe to the legs. The long pins will be at the top. Make sure all pins are at the front of the frame. Secure with large hex nuts. Now you can fully tighten the bolts.

NOTE:
The four 1/2" bolts and small hex nuts are for attaching the center graphics to the top wing wires.

Step 3
Fit the right and left header posts into the tubes of the top bedframe. The channels on the front of the posts will open to the inside of the display. Stand the display up.

Step 5
Attach the header sign to both the header posts and secure using four small hex nuts.

Step 4
Attach the four wings to the bedframe and secure with two large hex nuts each.

Step 6
Attach the center graphics to the back of the bedframes with two 5/8" screws each.

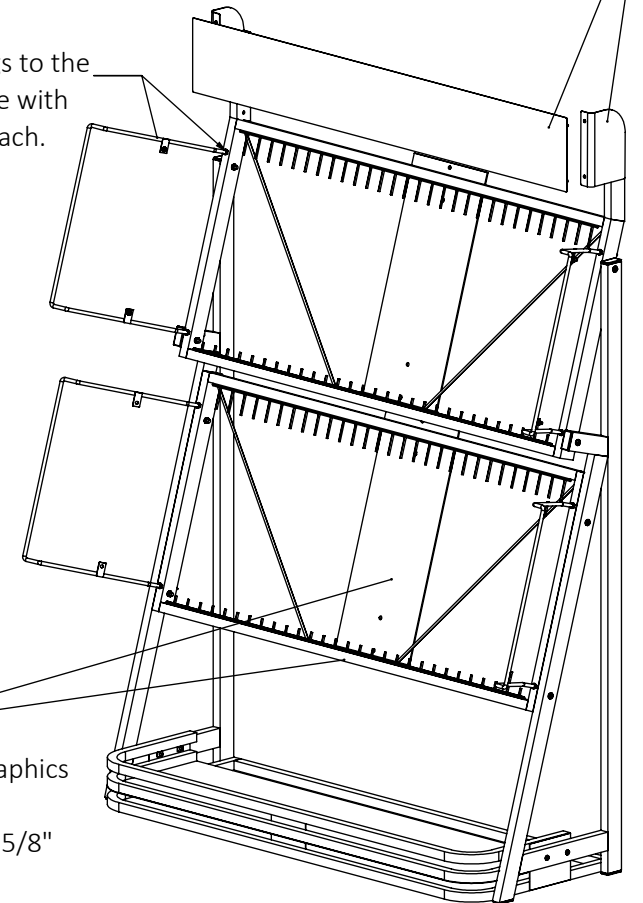

Caution: Do not move display without unloading samples or product!