



NETMAP

NETMAP is a Netcad product that is fully compliant with the legislation and can perform all the procedure steps of development and cadastre projects. It produces data integrated with TAKBIS standards of TKGM.

It prepares documents and reports in accordance with the Regulation on Land and Land Arrangements and the circular numbered 2019/13. Municipalities, public institutions, licensed map and cadastre offices prefer Netmap due to its easy use and structure conforming to standards.

Regulations within the scope of the applications of the 18th article and the 15th and 16th articles including geometry changes based on the distribution applications in the application area and the sketch and declaration of these regulations can be printed.

PREREQUISITES

NETMAP is a product dependent on NETCAD GIS.

MAIN FEATURES

- ✓ Standard data production with ready-made project templates included in NETMAP in accordance with the standards
- ✓ Ability to produce NETMAP projects **integrated with the database**
- ✓ The ability to quickly and seamlessly add **standard TAKBIS data of TKGM** to the project
- ✓ Meeting all the needs of the sector with the option of **Documents and Reports** following the current legislation
- ✓ Ability to produce multi-layered projects **with the ability to draw database blocks, parcels, buildings and neighborhoods**
- ✓ Meeting all needs related to parcel thanks to the **Parcel Editor**
- ✓ Quickly performing processes such as **Balancing, Balancing Allotment and Amalgamation, Renaming.**
- ✓ Freedom to create documents with **User-Defined Reports** included in the Parcel Editor
- ✓ Ability to make small area changes in a controlled manner after parceling with the **Area Correction** option
- ✓ Ability to make **allotment** with the desired method
- ✓ Drawing the roads between building blocks by defining **Road Width Values**
- ✓ Ability to carry out transactions in accordance with the legislation with **Land Use Conversion, Expropriation of Land for Roads** processes
- ✓ **2D Separation Process** designed for the ability to make more than one allotment on lands that have lost their forest quality
- ✓ Distribution Editor in order to perform transactions based on the principles stated in **Article 18 of the Construction Zoning Law No. 3194**
- ✓ **The feature of coloring** the property owners of the parcels belonging to the Public Legal Entity thanks to the **Distribution Editor**
- ✓ Dynamic interactive projects with Distribution Editor and graphics thanks to **Drag and Drop**



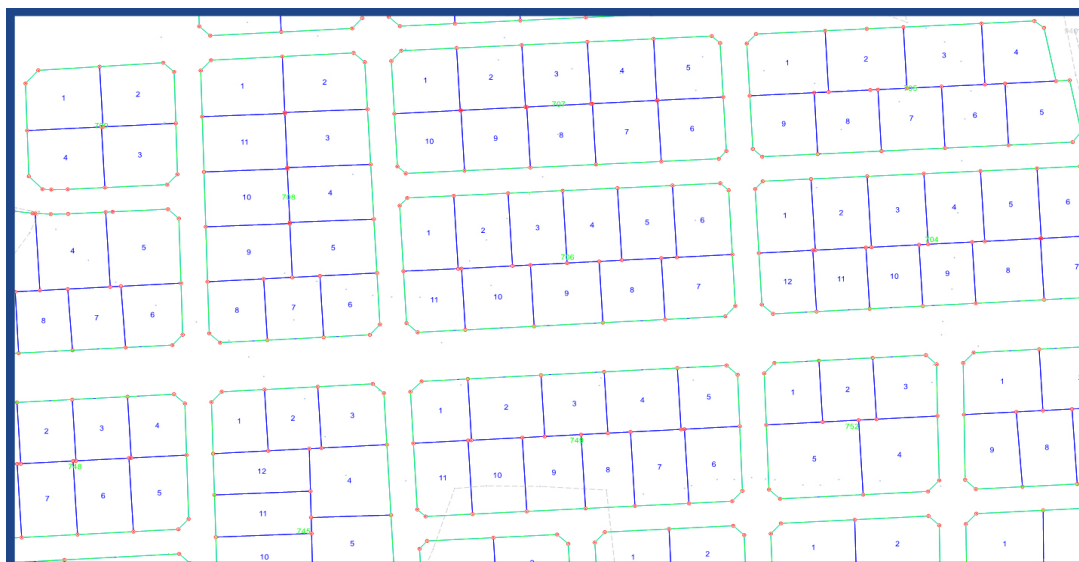

- ✓ **Cadastre, Development, Distribution and Report** screens together in the Distribution Editor
- ✓ Project management **with Entering Collective Data** and **Obtaining Information from the Screen**
- ✓ All transactions regarding the title deed with **Forming Title Deed** process
- ✓ Assigning cadastral parcels to building blocks with **Automatic Distribution**
- ✓ **DOP account** and reporting of the account
- ✓ Graphic interactive property owner and parcel **inquiry capability**

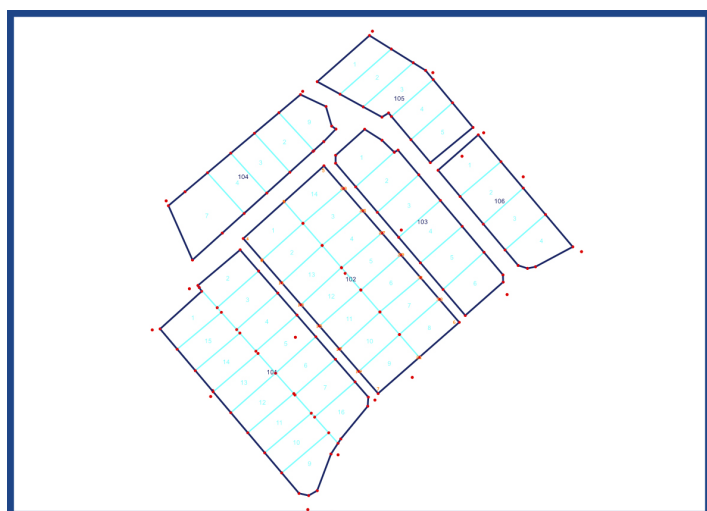

MAIN ADVANTAGES

- ✓ Fully **automatic distribution** processes
- ✓ Displaying distribution inquiries by thematically coloring
- ✓ Comparison of old and new title deed information
- ✓ Producing projects **in accordance with the legislation**
- ✓ Standard data generation thanks to the defined project templates
- ✓ **Automatic data entry**
- ✓ Working structure compatible with **the Land Registry and Cadastre Information System**
- ✓ Ability to work **integrated with the database**
- ✓ Ability to track parcel history
- ✓ Ability to obtain **project outputs** suitable for relevant institutions and organizations



Ankara Headquarter

Bilkent Cyber Plaza, B Blok No:409 Cyberpark, 06800 Ankara/TÜRKİYE

T: +90312 265 0510

İstanbul Region Office

Nidakule Göztepe, Merdivenköy Mah. Bora Sok. No:1 Kat:1 34732, İstanbul/TÜRKİYE

T: +90216 417 6210

global@netcad.com

www.netcad.com

