

BRIGADIER

250 PSI FM APPROVED

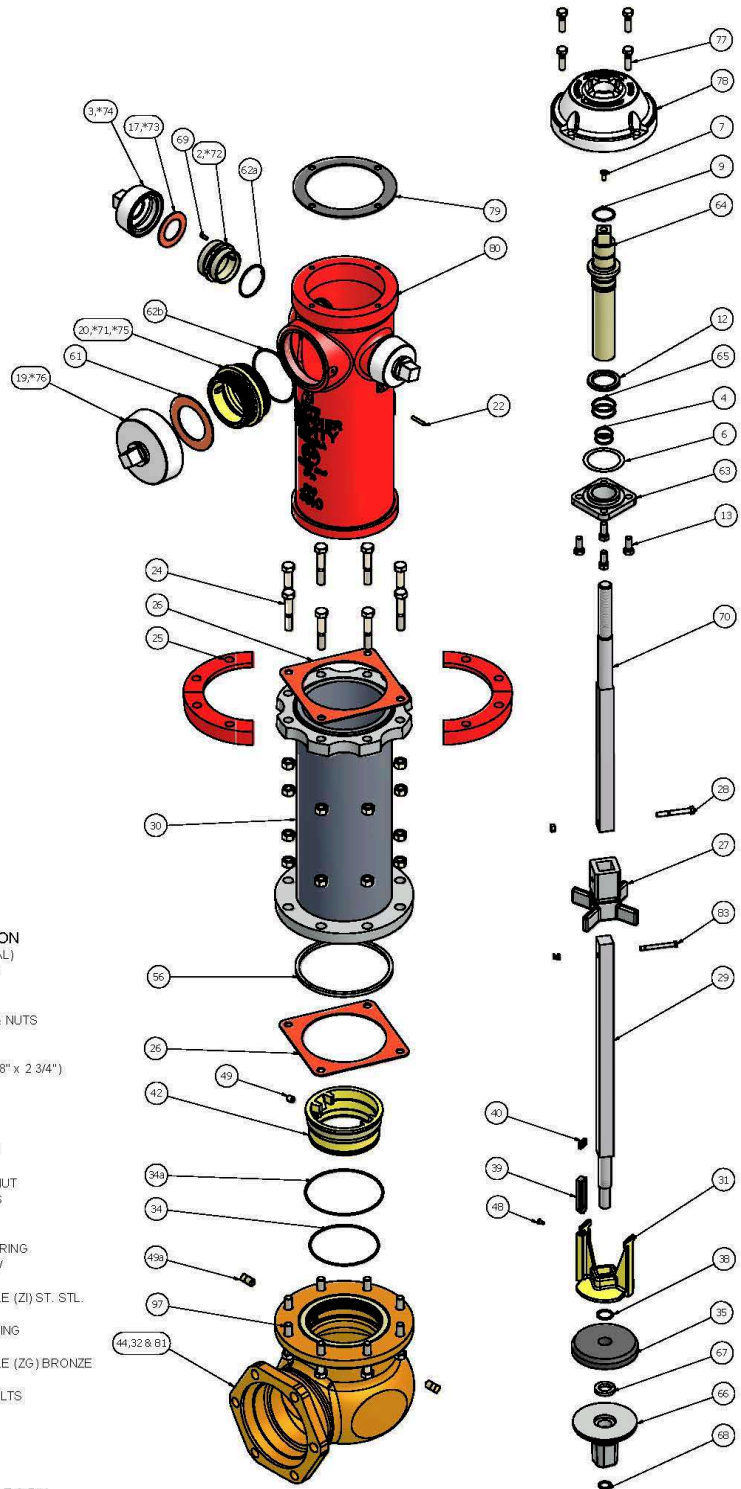
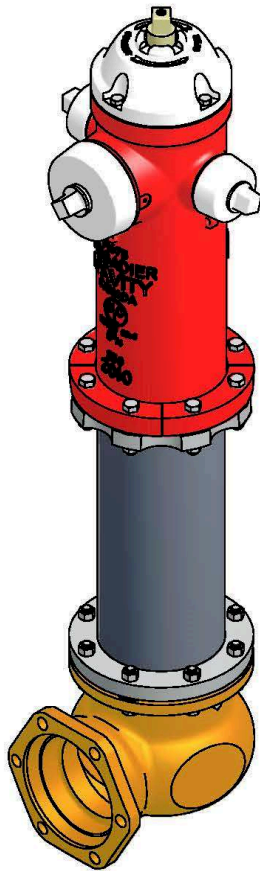

DESCRIPTION	
2	HOSE NOZZLE
3	HOSE NOZZLE CAP
4	HOUSING STEM "O" RINGS
5	HOSE CAP CHAIN & "S" HOOK
6	HOUSING JOINT GASKET
7	OIL HOLE SCREW
9	OPERATING NUT "O" RING
12	OPERATING NUT BEARING
13	HEX BOLT (1/2" x 1 1/4")
17	HOSE CAP GASKET
*18	STORZ 100 PUMPER CAP "O" RING
19	PUMPER NOZZLE CAP
20	PUMPER NOZZLE
21	PUMPER CAP CHAIN & "S" HOOK
22	PUMPER NOZZLE PIN
24	INTERSECTION BOLTS & NUTS
25	SAFETY FLANGE (4 SEGMENTS)
26	INTERSECTION GASKET
27	SAFETY COUPLING
28	SAFETY COUPLING BOLT & NUT
29	OPERATING STEM LOWER
30	INTERMEDIATE SECTION
31	DRIP VALVE
32	DRAIN HOLE LINING C/W ELBOW
34	SEAT "O" RING BOTTOM
34a	SEAT "O" RING TOP
35	MAIN VALVE DISC
38	MAIN VALVE "O" RING
39	DRIP VALVE FACING
40	HOLDING CLAMP
42	MAIN VALVE SEAT
44	ELBOW (STATE INLET REQUIRED)
*45 & 46	GUIDE PLATE ASSY & INT. WRENCH
*47	HOLDING NUT
48	HOLDING CLAMP SCREW
49	1/4" DRAIN HOLE PLUG (INTERNAL)

DESCRIPTION	
49a	3/8" PIPE PLUGS (EXTERNAL)
50	INTERSECTION EXTENSION
51	EXTENSION STEM
52	ALIGNMENT COUPLING
53	EXTENSION STEM BOLTS & NUTS
55	PIPE FLANGE (BOTTOM)
56	RETAINING RING (SQUARE)
57	MONITOR BOLTS & NUTS (5/8" x 2 3/4")
58	MONITOR ELBOW
59	MONITOR GASKET
61	PUMPER CAP GASKET
62a	HOSE NOZZLE "O" RING
62b	PUMPER NOZZLE "O" RING
63	OPERATING NUT GLAND
64	HYDRALUBE OPERATING NUT
65	OPERATING NUT "O" RINGS
66	LOWER VALVE PLATE
67	LOCKWASHER (1 1/8")
68	LOWER VALVE PLATE "O" RING
69	HOSE NOZZLE SET SCREW
70	OPERATING STEM UPPER
*71	STORZ 100 PUMPER NOZZLE (2) ST. STL.
*72	STORZ 65 HOSE NOZZLE
*73	STORZ 65 HOSE CAP "O" RING
*74	STORZ 65 HOSE CAP
*75	STORZ 100 PUMPER NOZZLE (2G) BRONZE
*76	STORZ 100 PUMPER CAP
77	ALLEN SCREWS or HEX BOLTS
78	BODY CAP
79	BODY CAP GASKET
80	BODY
81	SEAT RING C/W ELBOW
82	PIPE FLANGE TOP
83	SAFETY CPLG., CLEVIS BOLT & PIN
97	PIPE TO ELBOW BOLTS & NUTS

*OPTIONAL PARTS

PARTS AVAILABLE FROM EVANS SUPPLY 1-800-268-8309