

INTAKS® On Roof / Underslung Edge Protection System

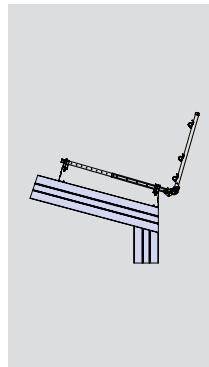

OVERVIEW



ON ROOF
(NO ROOF)

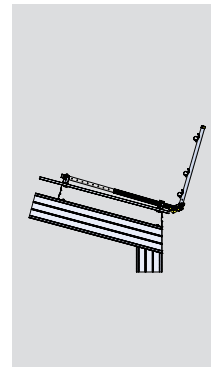

ON ROOF
(ROOF LAID)

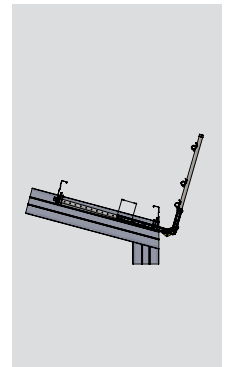

UNDERSLUNG

The INTAKS® On Roof/Underslung Edge Protection system allows edge protection to be installed quickly and efficiently before or after the roof has been laid.

FEATURES & BENEFITS:

- Edge protection system that can be installed on top of or underneath roofs supported by either steel or timber purlins.
- Suitable for new builds or re-roofs.
- Can be installed before roof is laid or afterwards.
- Use of ghost handrail post with On Roof configurations allows continuous edge protection to be in place during laying of roof, without interrupting efficiency of roofers.
- Up to 3.6m spans between handrail posts.
- Two or three handrail configurations available.
- Handrail height is adjustable.
- Handrail distance from edge of building is adjustable.
- INTAKS® Lock Pin & R-Clip and Spring Clip mechanisms allow for visual inspection of correct installation.
- Modular components may be re-used in other configurations – no need to purchase a completely separate edge protection system.

SYSTEM APPLICATIONS:

- Quickly and easily install edge protection on top of or underneath roofs both before and after roof has been laid.



INTAKS® On Roof / Underslung Edge Protection System



INSTALLATION PROCESS:

1. Roof Feet, Standard Arm and Extender assembled and Roof Feet then secured to purlins with Tek screws.
2. Platform Arm Bracket and Handrail Post then attached using the tool-less INTAKS® Lock Pin & R-Clip mechanism.
3. Handrails secured to Handrail Posts using the tool-less INTAKS® Spring Clip mechanism.
4. Dismantling process is simply the reverse to the installation.

COMPONENTS:

For handrail:

- Handrail Tube (part #HR4 to HR#6)
- Handrail Joiners/External Sleeve Couplers (part #1165/#SES)
- Fixed 90° Couplers (part #SFC) and/or Swivel Couplers (part #SSC) – for joining handrails at corners

For each post:

- 1 x Handrail Post/Swivel Handrail Post (part #1101/#1102)
- 1 x Standard Arm (part #1172 to #1177)
- 1 x Platform Arm Bracket (part #1076)
- 2 x Roof Feet (part #1200)
- 1 x Extender (part #1160)
- 5 x Lock Pins (part #1182)
- 5 x R-Clips (part #1900)

Note: components required will vary depending on set-up and site-specific requirements.

FASTENING TO STRUCTURE:

1. Timber purlins – each Roof Foot screwed onto purlin with 2 x Tek screws.
2. Steel purlins – each Roof Foot screwed onto purlin with 2 x Tek screws.
3. Purlins to which Roof Feet are fixed must be fully and properly secured to building frame and otherwise be adequate to support the edge protection. Minimum spacing between purlins is required and channel braces are required in some situations. Steel purlins minimum dimensions of a typical 200/12 steel purlin.

MATERIALS:

1. Roof Feet, Standard Arms, Handrail Posts, Handrails – high strength, durable, light, T6 temper aluminium extrusions.
2. Platform Arm Brackets – zinc passivated and powder coated 5mm mild steel.

WEIGHT:

- Nominal weight is 3.6kg/m to 5.9kg/linear metre, depending on set-up.

COMPLIANCE:

1. Designed and tested for static loadings: may be used as edge protection for a flat surface or up to a maximum roof slope of 15 degrees. Roof slopes between 15 to 35 degrees can also be accommodated in a slightly different configuration.
2. Configuration has been tested and independently verified to AS/NZS 4994 Temporary edge protection standard.
3. May be installed and dismantled by workers who hold the required competencies, but a scaffolder's certificate is not required.
4. Installation and dismantling must be completed in accordance with the latest version of the INTAKS® Guidelines.

CONFIGURATIONS:

1. On Roof (No Roof)
2. On Roof (Roof Laid)
3. Underslung

Note: all configurations can be fixed to timber or to steel purlins.

Important Note: All statements, technical information and recommendations contained in this document are based on information, tests or experience that INTAKS believes are reliable. However many factors beyond INTAKS' control can affect use and performance of an INTAKS® system in a particular situation. Scaffolding and edge protection requirements will vary depending on site specific factors. Since the conditions under which scaffolding and edge protection is installed are uniquely within the installers' knowledge and control, it is essential that the installer evaluates the INTAKS® system to determine whether it is fit for the intended purpose. INTAKS does not warrant that installations shown in photographs comply with current regulatory requirements, which may have changed since the photographs were taken. Photographs should not be relied on for guidance by installers. Installation of components by a non-competent person or installation that is not in accordance with current INTAKS® Guidelines voids system compliance certification.

Limitation of Liability: except where prohibited by law, INTAKS NZ will not be liable for any loss or damage arising from the use of INTAKS® components, whether direct, indirect, special, incidental or consequential, regardless of the legal theory asserted, including warranty, contract, negligence or strict liability.

v01.2019