



Steering Repeater Compass





Steering Repeater Compass

The new steering repeater ensures a clear indication of the heading information by using a 360° and a 10° compass card. In addition heading information is shown on a digital display. Both the analogue and the digital display provide a graduation of a tenth of a degree.

The heading source indication is a unique feature of the new steering repeater from Raytheon Anschütz. It displays the source of heading information such as gyro, satellite or magnetic compass. In combination with the Gyro Compass System Standard 22, it is immediately apparent which heading source is selected.

When connected with Raytheon Anschütz' gyro system, alarms and status information of the Gyro Compass Standard 22 can be displayed on the steering repeater. All necessary information is transferred to the wheelhouse independently of the location of the gyro compass.

The steering repeater from Raytheon Anschütz can be connected to course bus or NMEA 0183 and needs no manual synchronization with the master compass. For use on double-end ferries a 180° offset can be added.

The illumination is concentrated on the lubber line and can be dimmed with push buttons. The anti glare screen is a standard feature.

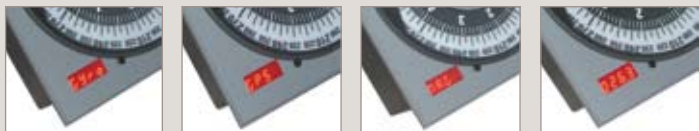

Steering Repeater Compass 133-560 Desk mounting

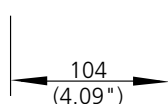
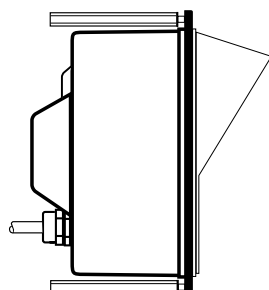
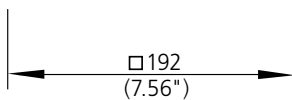
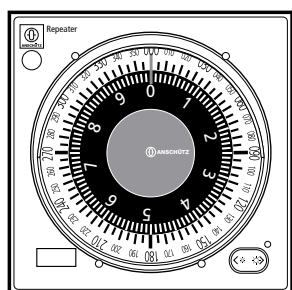

Bulkhead mounting

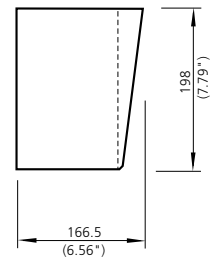
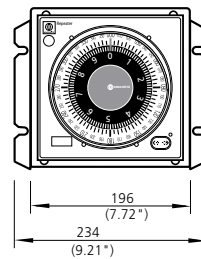

Ceiling, wall and table mounting

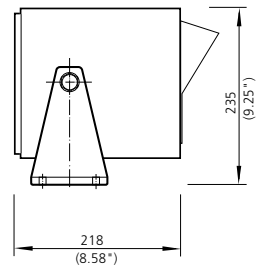
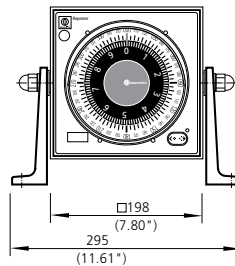

Technical data

Reading accuracy 0.1°
Supply voltage 24 V DC (12-36V DC)
Power consumption max. 9 W

Signal input RS 422 / RS 232C
 NMEA 0183 or
 Anschütz course bus

Permissible ambient temperature
 Operation: -15°C to +75°C
 Storage: -25°C to +75°C

Type of enclosure acc. to IEC/EN 60529
 IP 23
 IP 44 (option)
 IP 56 (option)

In accordance with EN/IEC 60945
 EN/IEC 61162

Subject to change due to technical developments without notice.

All rights reserved · Printed in Germany
 RAN 801.45 e / L&S 0806

Raytheon Anschütz GmbH
 D-24100 Kiel, Germany
 Tel +49(0)4 31-30 19-0
 Fax +49(0)4 31-30 19-291
 Email sales@raykiel.com
 www.raytheon-anschuetz.com