



CHURCH HILL

- RESIDENCES -



CHURCH HILL

*Property Overview*

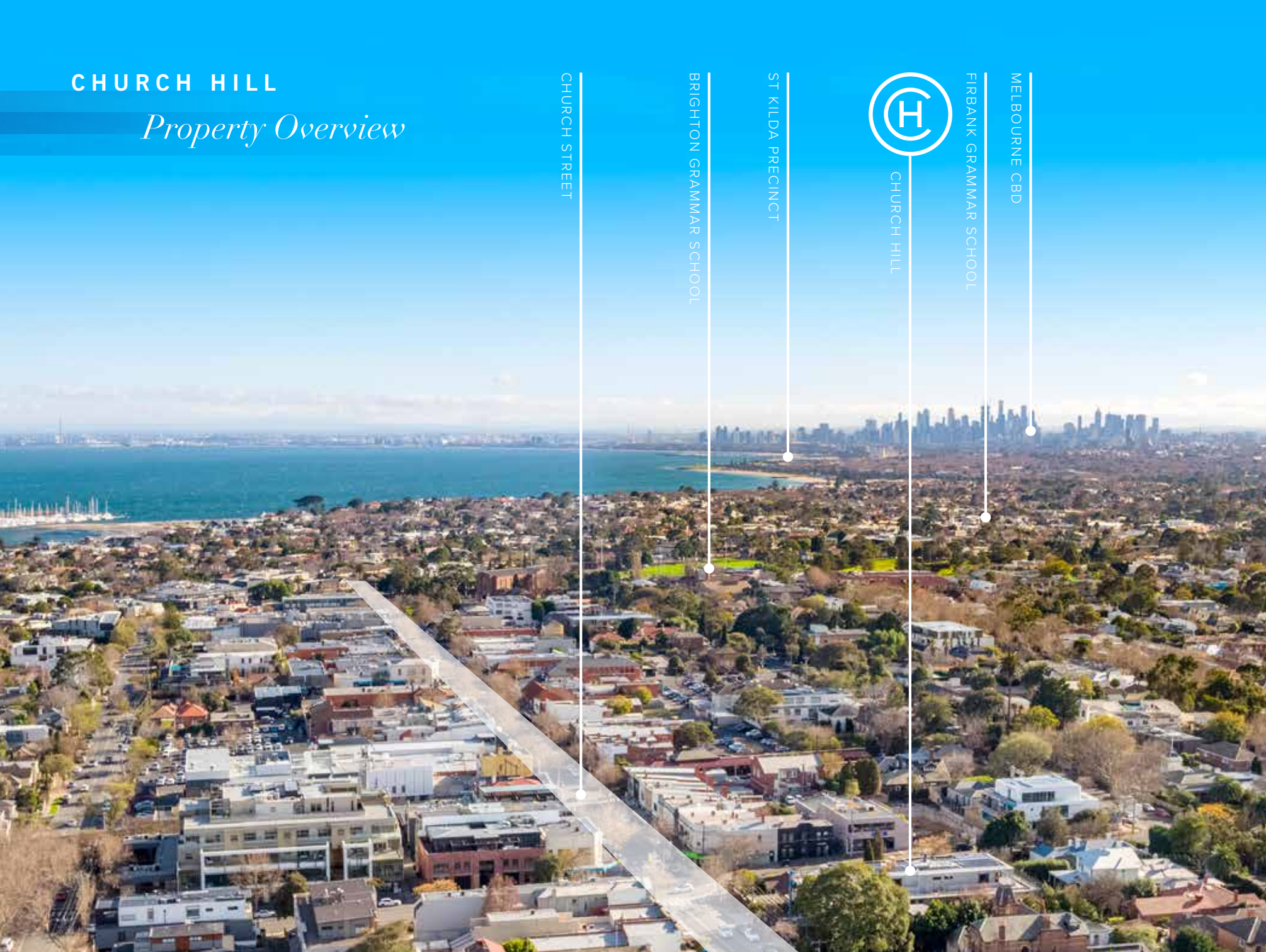

CHURCH STREET

BRIGHTON GRAMMAR SCHOOL

ST KILDA PRECINCT



CHURCH HILL

FIRBANK GRAMMAR SCHOOL

MELBOURNE CBD



BRIGHTON BATHING BOXES



CHURCH HILL

CHURCH STREET RESTAURANTS

BRIGHTON SOUL ESPRESSO

HALF MOON

WHITE RABBIT

CHURCH STREET SHOPS

WOOLWORTHS BRIGHTON

VINTAGE CELLARS

MIDDLE BRIGHTON STATION

CHURCH STREET BANKS

PALACE DENDY

ROYAL BRIGHTON YACHT CLUB





## THE LOBBY

*Bright things ahead*

*Illuminated by incredible pendant lighting,  
stunning stone paves the way to your front door.  
It's a sign of things to come.*

OVERVIEW	2
ARCHITECTURE	6
KITCHEN	8
DINING	10
LOUNGE	12
BATHROOM	14
COURTYARD	16
ROOFTOP	18
BRIGHTON AREA	20
THE COMPANY YOU KEEP	24
SCHOOLS	25
DEVELOPER	26





## THE ARCHITECTURE

*Impeccable taste*

*The private Church Hill domain stands out as a crown-jewel of Church Street.*

Church Hill is modernist design with heart and soul, finished using the highest quality materials. The work of Artisan Architects, Church Hill is a showcase project you could call home.



## THE KITCHEN

*A dream domain for any gourmand,  
you'll be the envy of everyone.*

Church Hill residences feature a cooks-kitchen,  
professionally appointed with Gaggenau appliances  
and a Sub-Zero integrated fridge.

GAGGENAU

SUB-ZERO

*Elegance, served*



## DINING

*Enjoy entertaining friends and family in the spacious dining and living area.*

Flit between the kitchen and your guests seamlessly over the stunning timber floor, and pick the perfect vintage from your integrated wine fridge for a moment of celebration.

Savour the time with those that matter the most.



*Opulent spread*







## THE LOUNGE

### *An earned life*

*Not reserved for the meek, Church Hill offers generous living spaces for those who live large. This is the life for a few, not many.*

Natural stone features and wood flooring present the perfect canvas for a resplendent lounge room. Ready to entertain or retreat from everyone, whatever the mood, the space is an adaptable format to suit your lifestyle.

You'll welcome the warmth with a spectacular inlaid fireplace, and relish in the stellar finishes and sleek recessed storage that is aplenty. Considered design continues to round out your abode throughout, from the front door to your outdoor area.

With large patio windows opening to your private terrace, you can enjoy the best of both worlds seamlessly. Let summer in or brace yourself against winter, this is living for all seasons.





## THE BATHROOM

*Pamper yourself in the elegant en suite, serviced with the most modern of conveniences and dressed in incredible natural stone.*

Bask in your dream bathroom with large mirrors framed by studio lighting, slip into your sumptuous bath\*, and indulge in some self-care. Escape the everyday, every day.



*Lather up in luxury*

\*Bath not available in Unit 1.03



## THE COURTYARD

*Live large*

*Take your party outside on balmy nights.*

An outdoor entertainers expanse extends seamlessly from the interior quarters, maximising your living space year-round.

Best of all, it's all exclusively yours.







## THE ROOFTOP

### *Priceless views*

*Retreat to your private terrace for golden-hued sunset drinks.*

Enjoy BBQ's with the breeze blowing, and let the party live on at the best spot in town at the Church Hill apartments. Let the long summer days finish right here. This view is all yours.

[ This only applies to apartments 2.01 and 2.02 ]

Artist impression only. Illustrated fixtures, fittings and finishes are indicative representations and subject to change. Dimensions and areas shown are approximate only and may not accurately represent actual dimensions. Areas shown may change and locations of utilities may vary during construction. You should not rely on marketing material in deciding whether to enter into a contract.





*An oasis only 20 minutes  
from the city via train,  
or 35 minutes via car.*

**BRIGHTON AREA**

*Prestige Postcode*

*The bayside area of Brighton is brimming with well-heeled neighbours.  
You could be one of them.*

Church Hill is on the doorstep of Church streets’ inimitable food and fashion, and only around the corner from the Bay street strip. The famous Brighton Baths and beach boxes are just a short stroll away, where the calm waters of Port Phillip Bay lap at the shore.

Middle Brighton station is but a block away. The location is an easy commute and offers the perfect lifestyle for the best work-life balance.



100m to  
Restaurants and Cafes



140m to  
Middle Brighton Station



1km to  
Brighton Grammar School



1.2km to  
the Beach



15km to  
Melbourne CBD



42km to  
Mornington Peninsula





## 36 ROCKSALT CAFE





THE COMPANY YOU KEEP

*Day or night, a feast awaits*

Dining options close by include:

- › Bistro La Provence
- › Hellenic Republic
- › Botticelli
- › Vivace
- › Buffalo Boy
- › Cucina & Co
- › Pantry
- › The Baths Upstairs

*And this is only the beginning, there's much more to discover here.*



SCHOOLS

*Securing the future*

*You're well placed here in the catchment area of elite Melbourne schools.*

Some of the top institutes nearby include:

- › Brighton Grammar
- › Firkbank Grammar
- › Haileybury
- › St Leonard's College
- › Xavier College Campus



*This is central living. Bask in the perks of a bayside locale, that's still only just removed from the city.*

*Church Hill is a dream address and it's within your reach.*

Made possible by LK Property Group.

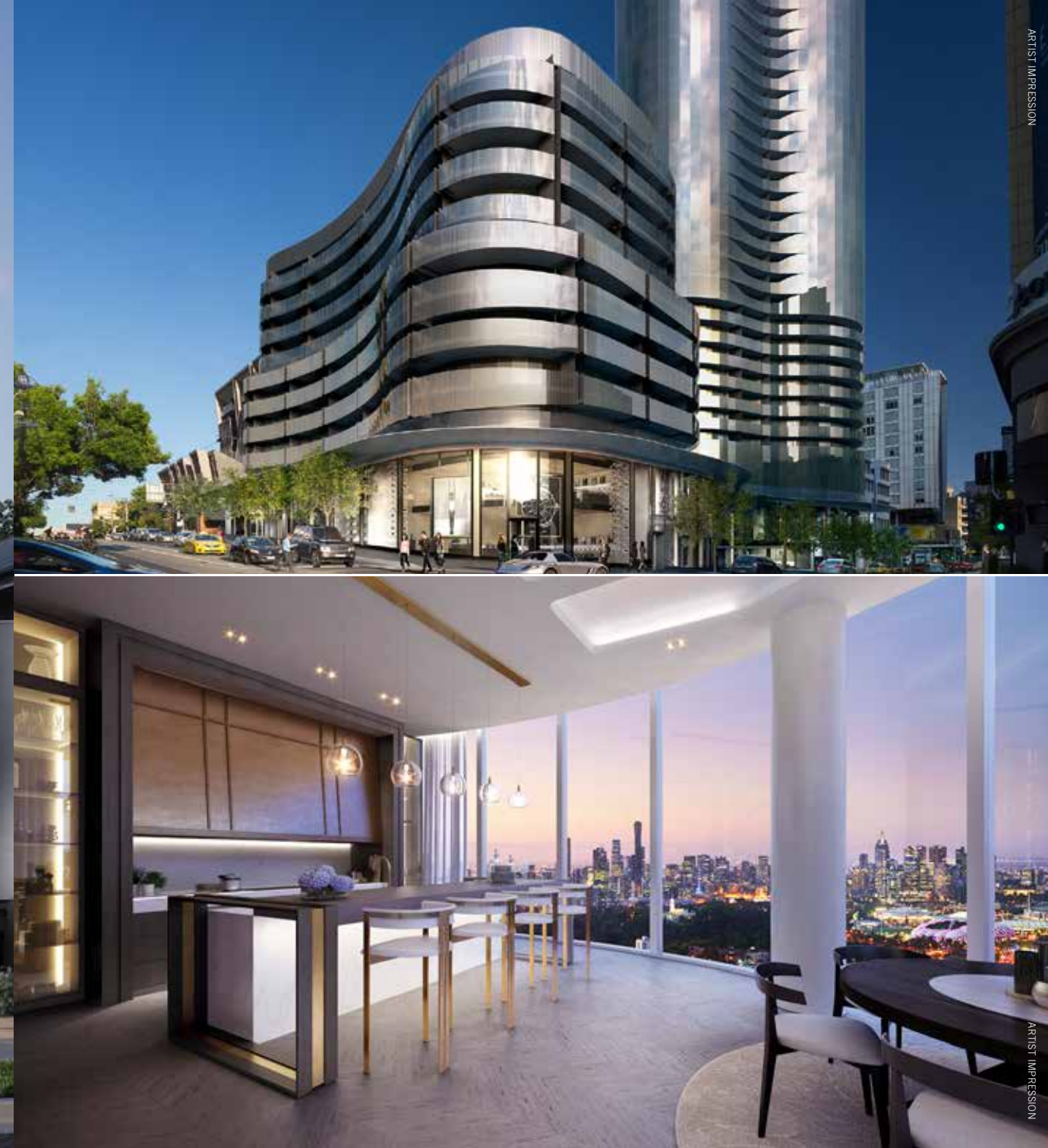

## THE DEVELOPER

*Invest in living*

*LK Property Group offers unparalleled products with over 20 years of experience.*

We provide concierge during, and after the purchasing process to help make things go smoothly, and provide a level of service you deserve.

Our projects produce landmark residences on key sites for discerning buyers who want to be in the right location and live in their dream home.

The six-star Capitol Grand stands resolute on Chapel street, towering above the skyline. The idea to create an icon and residence in one has been realised on time, and settlement has already begun.

We've also constructed top-quality, accessible apartments in Melbourne's south. LK Property wants to present the best of both worlds to our clients.

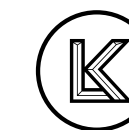

PROPERTY GROUP



**FOR MORE DETAILS VISIT**  
**CHURCHHILLBRIGHTON.COM.AU**