



DT-ASC

Aluminum barbs secure the clip without adhesive, nails or tools.

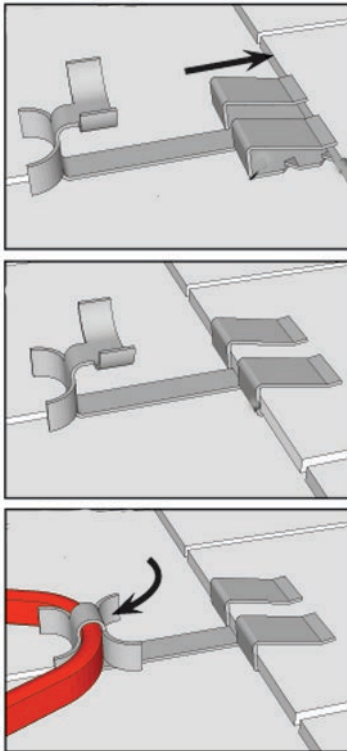

Diagram 1. DT-ASC clips can be quickly installed at the roof edge or any tier of asphalt shingles above that.

DESCRIPTION

DT-ASC Roof Clips provide support for self-regulating or constant wattage heating cable on asphalt shingles without using adhesive or nails. Because they don't rely on adhesives, clips **can be installed in temperatures below 50°F**. Made of .050 black anodized aluminum, each clip has barbs that grip the shingle for easy installation in seconds without tools.

STOCK CLIPS

Available only in packages of 25.

INSTALLATION

DT-ASC clips are secured by 6 barbs. Once the position is chosen, the clip slides onto the edge of the shingle.

Place the cable in the cradle and pinch the cradle securely around it as shown in Diagram 1.

Complete installation Instructions are provided with the product. They can also be downloaded at www.delta-therm.com.

APPLICATIONS

- Roof without Gutter
- Roof with Gutter
- Roof Valleys
- Combination Drip Loop and Gutter Run



Diagram 2. Barbs embed themselves in the asphalt shingle.

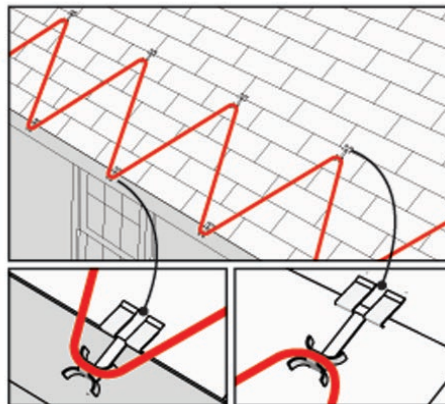

Diagram 3. DT-ASC clips are positioned to alternate between the roof edge and courses above the roof edge. They can also be installed in roof valleys.

For more application installation information and drawings, visit www.delta-therm.com/roof-deicing/accessories.