



### Characteristics

Model style: Urban  
Facade: 30 ft  
Depth: 36 ft  
Living space: 1 458 square-foot  
Number of bathrooms: 1  
Number of rooms: 3  
Garage: 1

### Description

The window configurations, as well as the brick and CanExel engineered siding give this contemporary two-storey home a truly distinctive look. The house measures 30 feet wide by 36 feet deep, with a 1,458-square-foot living space, and a 281-square-foot, single-car garage.

Measuring 748 square feet, the ground floor features 9-foot ceilings, with the exception of the entrance and living room where the ceilings are 18 feet, 3 inches high. In addition to the powder room, the open concept space includes a dining room, an L-shaped kitchen with an island, a large pantry, as well as a living room.

The 711-square-foot second floor includes a bathroom with a freestanding shower and bathtub, as well as three bedrooms, including the master bedroom with a walk-in closet. The landing overlooking the living room gives the home an original touch of grandeur.

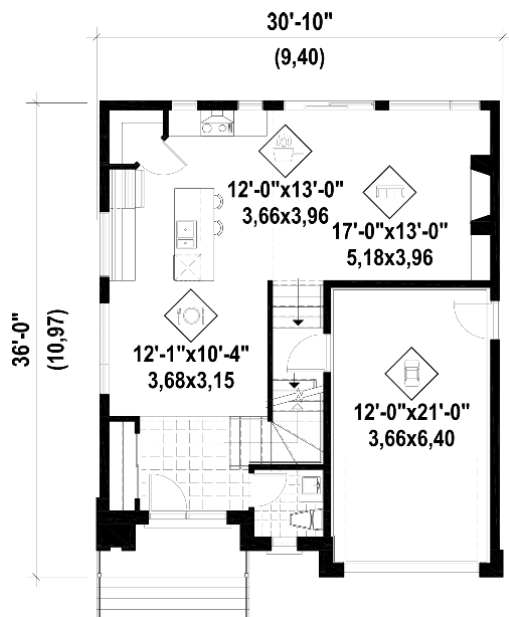

Rez-de-chaussée

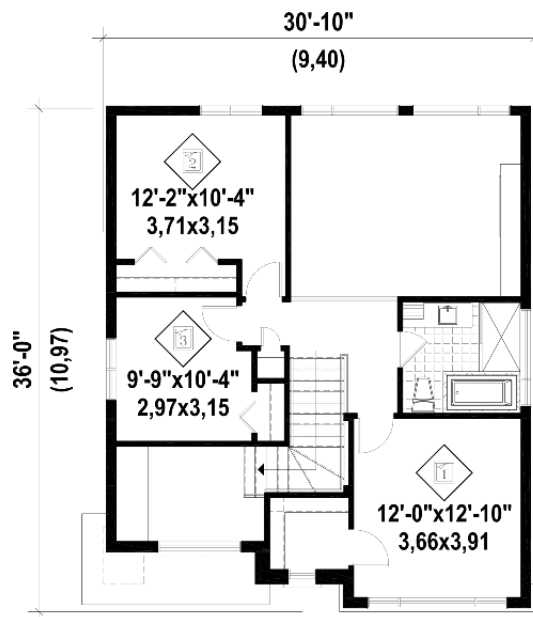

Étage