

06 How do I submit a blood glucose reading?

Task: Submit a reading using an AgaMatrix WaveSense Jazz Wireless meter

Previous actions taken: Set up a blood glucose meter using Bluetooth

Step 1

Take a blood glucose reading as shown by your clinician.

Step 2

Open the app, tap on the **+** button on the hub page.

Ensure that your meter is set up with the app.

Tap on **Take BG reading**.

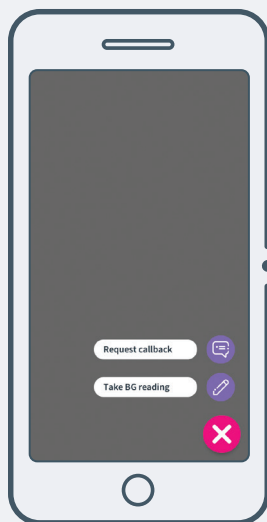

Step 3

Then select **Scan** from the buttons presented.

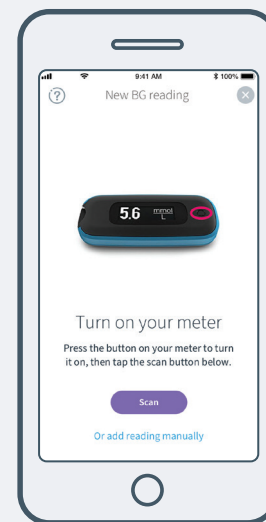

Step 4

Your newest reading will come through on the enter BG reading page:

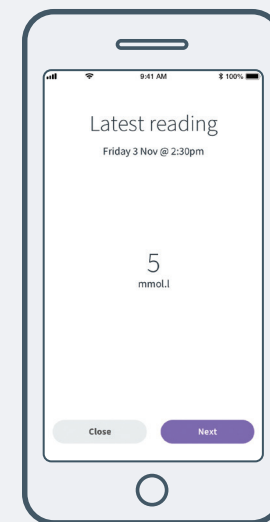

Step 5

Select the meal type associated with the reading. If a reading is before a meal, you may be asked about the medication you have taken.

Type in the dose of the medication and tap **Next**.

NOTE: If you are not on medication, please proceed to **Step 7**.

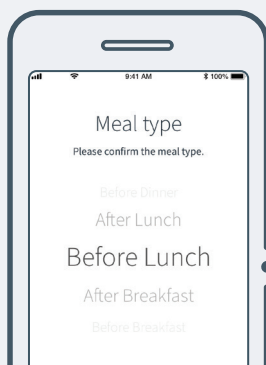

Step 6

If you have not inputted a dose for a medication you will get an **Input required** warning.

Please review your dose and type in a number. If you have not taken your medication then please enter **0**.

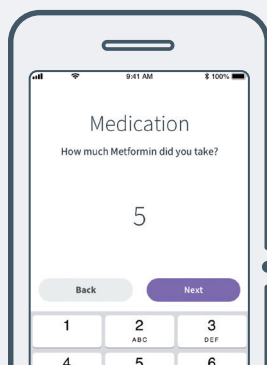

Step 7

If you want to tell your diabetes care team something about your reading then please type this information into the **New Comment** screen and then submit.

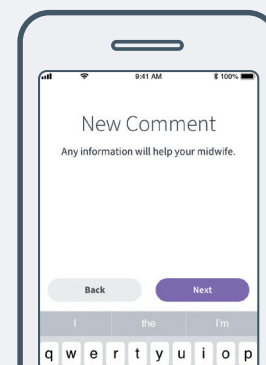

Step 8

Your reading will then appear on your diary and graph screens

NOTE: If you started to enter a new reading unintentionally, tap the **Cancel** button.