

03 How do I set up a blood glucose meter?

Task: Pair an AgaMatrix WaveSense Jazz Wireless meter

Previous actions taken: Download the GDM-Health app / Open the app / Activate the app

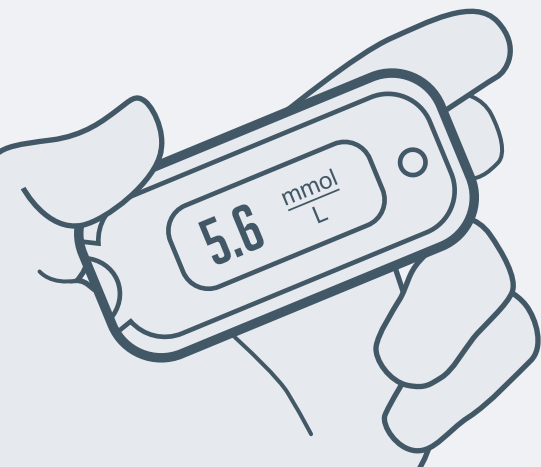

Step 1

If you have an **AgaMatrix WaveSense Jazz Wireless** meter with Bluetooth connectivity, you can set it up in the app so that your blood glucose readings can be transferred from the meter to your app automatically.

After activation, you can set up the meter.

Step 2

Tap on the **Connect to meter** button.

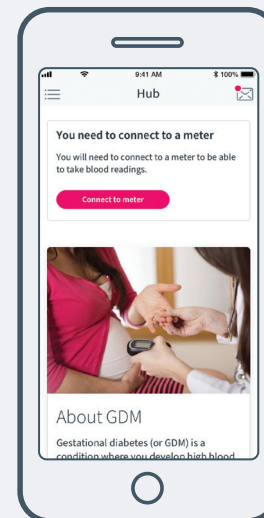

Step 3

Tap the **AgaMatrix WaveSense Jazz Wireless** meter in the **Choose meter type** list.

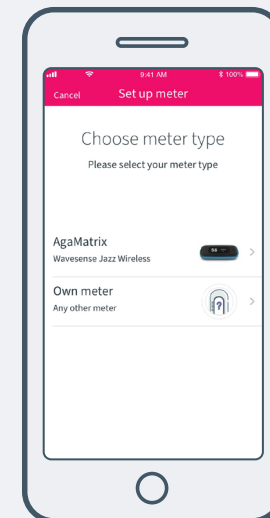

Step 4

Press and hold the button on your **AgaMatrix WaveSense Jazz Wireless** meter for 3 seconds until the Bluetooth symbol starts flashing.

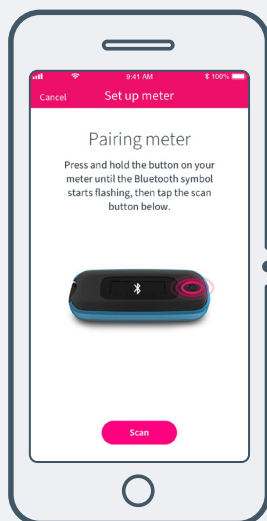

Step 5

The meter and its serial number will appear in your list of meters.

Tap on it to begin pairing.

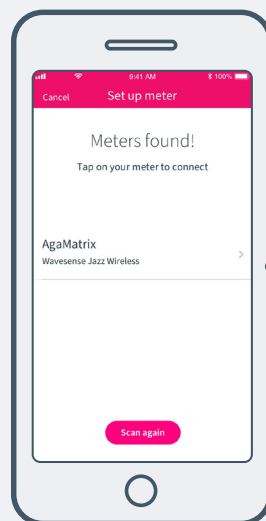

Step 6

When prompted, enter the 6-digit code displayed on your meter into the app.

Step 7

A confirmation should appear once the meter is successfully paired.

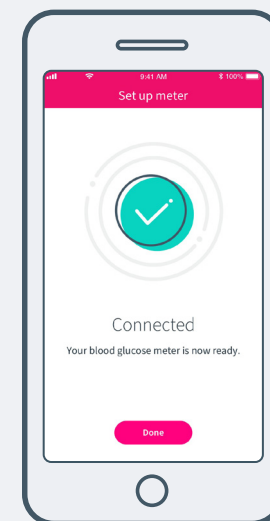

03 How do I set up a blood glucose meter?

Task: Pair an AgaMatrix WaveSense Jazz Wireless meter

Step 8

If you have not allowed the app to use your location, you will be asked to grant permission.

If you do not grant permission, you will not be able to connect to the **AgaMatrix WaveSense Jazz Wireless** meter.

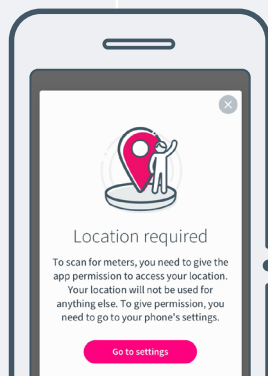

Step 9

If you repeatedly deny permission, you will have to allow it manually. You will be presented with the screen below.

Please go to the settings in your phone to allow the app access to your location. You will then be able to proceed with syncing.

Step 10

If you have Bluetooth turned off on your phone, or if you do not have that ability on your phone, the following error message will appear:

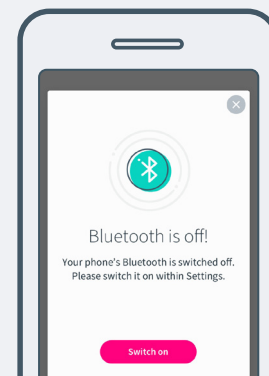

Step 11

To make this work, please turn on your Bluetooth functionality.

If you do not have this ability, please contact your diabetes care team.

Step 12

If the phone cannot find your meter, you will see the following screen:

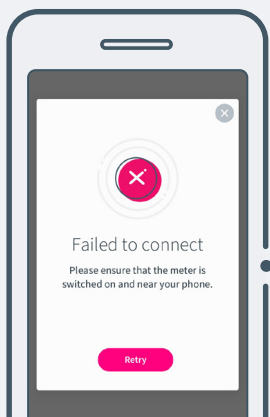

Step 13

Ensure that your meter is turned on and nearby to your phone, then tap **Retry**.

Step 14

If the meter cannot connect to the phone, you will see the following screen:

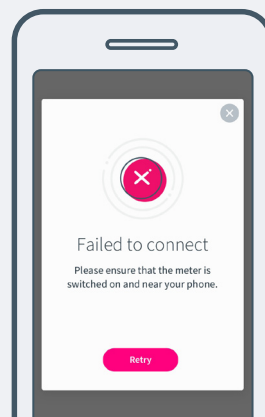

Step 15

Ensure that your meter is turned on, nearby to your phone and in pairing mode, then tap on **Retry**.