

# PP100 SERIES

PCP - PRE CHARGED PNEUMATIC  
HARPY



## OWNER'S MANUAL

Please Register your Air Pistol Online at [www.precihole.com](http://www.precihole.com)

**NO LICENCE REQUIRED**

Specifications	Harpy X1	Harpy X3
Power source	PCP	
Mechanism	Side Lever Loading	
Caliber	4.5 mm (0.177")	
Velocity	243 mps / 800 fps	
Power	Upto 16 joules / Upto 12 ft-lb	
Max. Pressure	200 bar	
Weight	1 Kg	1.15Kg
Total Length	364mm	495mm
Barrel Length	270 mm	
Shots Per Fill	35	

Before using this Air Pistol thoroughly read all instructions and warnings in the Manual.



Tampering with the components, or unauthorized modifications and alterations may make the air pistol unsafe to use and also will invalidate the warranty and may attract legal consequences.

We strongly advise against disassembly or modifying your air pistol. The PCP air pistol are charged at very high pressure. Disassembly of air pistol while it is charged may lead to serious injuries or even death. If there is any physical damage to air cylinders the air pistol must be taken for inspection to an authorized Precihole Sports service center.

Please ensure that all the fields below are filled and it carries the inspection date and sign.

Customer Name			Inspection
Harpy X1 <input type="checkbox"/> X3 <input type="checkbox"/>			Sign :
Serial Number			Date :

### NOTICE

- PP100 Harpy air pistol comes with a MZ10 Rotary Magazine. Pressure range is between : 200 bar - 90 bar.
- DO NOT discharge the pistol completely i.e. do not go below the minimum specified pressure for your air pistol. This could result in leakage.
- OVERFILLING the air pistol beyond the maximum specified pressure would lead to valve lock and damage the seals. This would also result in low velocity.
- Harpy Air Pistol can be dangerous up to 600m.
- PP 100 Harpy model is a High Power Pistol and hence it is normal to hear a loud sound on shooting in unsuppressed version (X1).

### WARNING

- Precision air pistols, because of their design are a special class of guns having very sensitive trigger mechanisms, light trigger pulls and may fire if dropped or jarred abruptly. Careless use of an air pistol can cause serious injuries.
- PCP air pistols are designed specifically for use with dry compressed air. No other gas combination can be used.
- Ensure that you are aware of all the local laws regarding ownership of air pistol. You should always obey all the local laws.
- Anyone under 18 years of age must always be under the 'immediate supervision' of an adult experienced in operating air pistols.

### SAFETY INFO

- Always keep the muzzle pointed in a safe direction. Never point it at something you don't want to shoot. Keep the muzzle pointed either upwards or downwards towards the ground.
- Make sure you note the danger distance of the air pistol i.e. how far the pellets can travel. Also ensure that your target has a safe backstop i.e. Think of what you might hit if the pellet misses or goes through the intended target.
- Always keep your finger away from the trigger and out of the trigger guard until ready to shoot.
- An air pistol has a potential of serious injury. Treat every pistol as if it were loaded. Keep it unloaded until ready to shoot. Move the safety lever to off position only when ready to shoot.
- An air pistol "Safety" is a mechanical device. Like all mechanical devices, it can fail. Never rely on a pistol's "Safety" to protect you and others from unsafe handling. A safety is not a substitute for common sense and good safety procedures.
- When removing any air pistol from storage, or when receiving it from another person, check immediately to see if it is loaded.
- Do not drink and shoot. Handling and using an air pistol requires your full and continuous attention, alertness, and unimpaired judgement.

### LEARN THE PARTS

Before learning how to operate, lets first identify various parts of your PP100 series air rifle.

HARPY X3

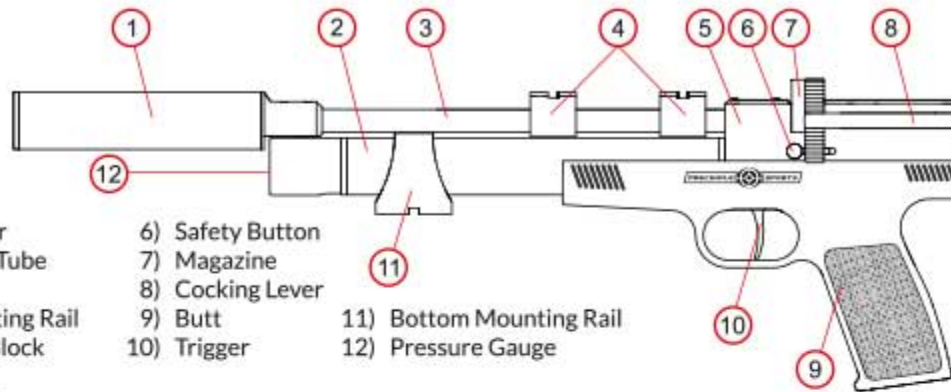

- |                      |                  |                          |
|----------------------|------------------|--------------------------|
| 1) Suppressor        | 6) Safety Button | 11) Bottom Mounting Rail |
| 2) Reservoir Tube    | 7) Magazine      | 12) Pressure Gauge       |
| 3) Barrel            | 8) Magazine      |                          |
| 4) Top Mounting Rail | 9) Butt          |                          |
| 5) Receiver Block    | 10) Trigger      |                          |

#### Other Options

HARPY X1

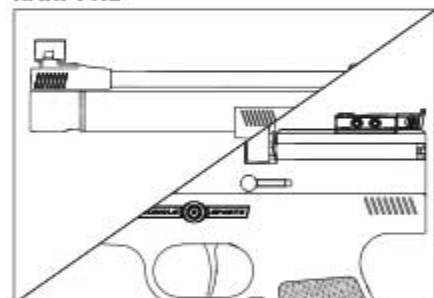

HARPY X3

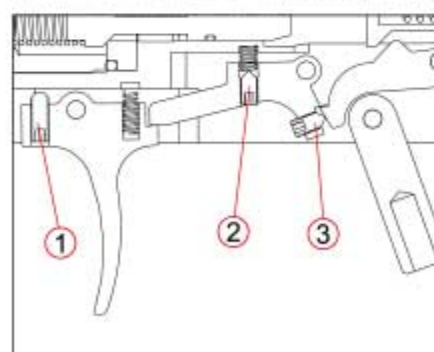
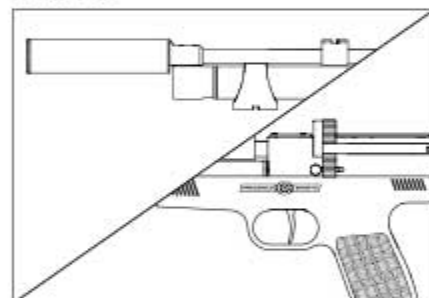

- Length of first pull (Tool required: 1.5 mm Allen Key)  
Turning Clockwise will reduce the amount of first stage travel and Counter-Clockwise will increase the amount of first stage travel.  
**WARNING: Turning Clockwise too much will eliminate the 2nd stage and prevent sear engagement.**
- Weight of second pull Clockwise will increase weight, anticlockwise will decrease weight.
- Trigger Point / Sear Engagement (Tool required: 1.5 mm Allen Key)  
Turning Clockwise decreases resistance of the second stage and Counter-Clockwise increases resistance of the second stage.  
**WARNING: Turning Clockwise too much will prevent gun from cocking.**

### RAILS AND MOUNTS

- Top mounting rail set for 11mm dovetail/picatinny.
- Bottom mounting rail for picatinny attachment.

### AIR PISTOL MAINTENANCE

- Apply a thin layer of suitable grease occasionally or when dried out to the fill probe o-rings.
- To prevent rust from forming due to sweat from your hands, exterior surfaces should be wiped down with an oiled cloth after every use to maintain the quality of finish. (Never Use Strong Chemicals or Water).
- Before you begin oiling or cleaning your pistol, always check to make sure it is unloaded. (Do Not over-lubricate the pistol)
- It is recommended to clean the barrel with a pull through every 500-1000 shots. Do not use harsh firearm bore cleaners.
- After a period of time, the O-rings on the fill probe will need to be replaced. The need for this will become noticeable if air is heard leaking from the fillprobe or the fillprobe is ejected from the port while charging the pistol. Always ensure to replace both O-rings on the fill probe.
- Store in a place that is dry and dark. Store the pistol with a pressure between 200-90 bar for Harpy.

### WARRANTY INFO

Please refer the terms and conditions, replacement & refund policy available on our website

- All Precihole Sports air pistols come with 6 months carry in warranty from the date of retail purchase against faulty parts and labour; this applies to PP100 series HARPY and is not transferable.
- Proof of purchase is required (Original sales receipt)
- Some items are not covered under the warranty:

- Normal wear and tear
- Failure due to misuse or abuse
- Fitting of non-standard parts
- Unauthorized repairs/ parts/ modifications
- Damage as a result of incorrect lubrication or over-lubrication
- Loss or theft
- Over filling pressure
- Discharging pistol below the minimum specified pressure.

**If a pellet is loaded in the pistol, pistol should be fired with the safety off. This ensures that the pellet leaves the barrel and the next pellet can be loaded. Multiple pellets stuck inside barrel are not covered under warranty.**

- Repair Service - If your air pistol needs repair, we recommend you take or send it to your nearest Precihole Sports authorized dealer. Any disassembly or modification not performed by an authorized service station will void the warranty. All warranty work must be done by Precihole Sports or an authorized dealer of the company, and should the air pistol be collected or returned for repair purpose, the transportation charges are to be borne by the customer.



### OPERATING INSTRUCTIONS

#### 1. FILLING THE PCP AIR PISTOL

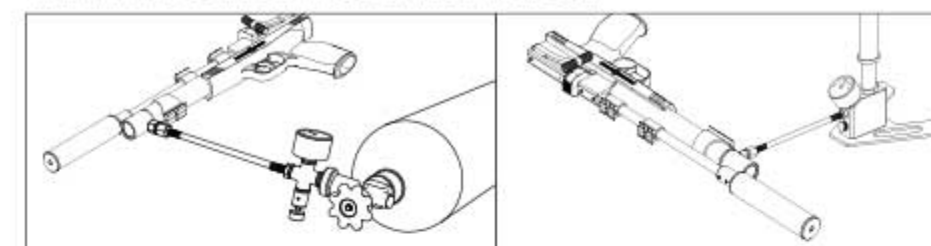

A quick fill connector comes with 8mm foster male fitting. Make sure that the fill probe and filler hole are clear from any dirt. Feel free to use lubricant on

the o-rings to increase their life. **NOTE: use any lubricant in moderation.**

**Fill probe:** Rotate the dust cover to expose the fill probe hole. Insert the fill probe completely into the pistol filler hole located at the end of the air tube.

- FILLING DEVICE:** Close ventilation screw on the charging source. Charge the pistol to a Maximum level specified. (Do not over fill pressure). Always check the pressure on the charging source (filling device). Close the tap on the air bottle. Unscrew the ventilation screw on the filling device to vent the residual air in the hose pipe before removing the fill probe from the pistol.
- HAND PUMP:** When using a hand pump use the ventilation screw on the pump always. Due to continual usage the pump body will become very warm. Allow it to cool down for several minutes before continuing. As pressure increases, more force is required to pump. It is normal if you start to find it hard to pump once the pressure increases. Check the pressure on the Hand Pump gauge as they are more reliable. Do not pump beyond the maximum pressure level specified.

#### 2. COCKING, LOADING AND LOCKING

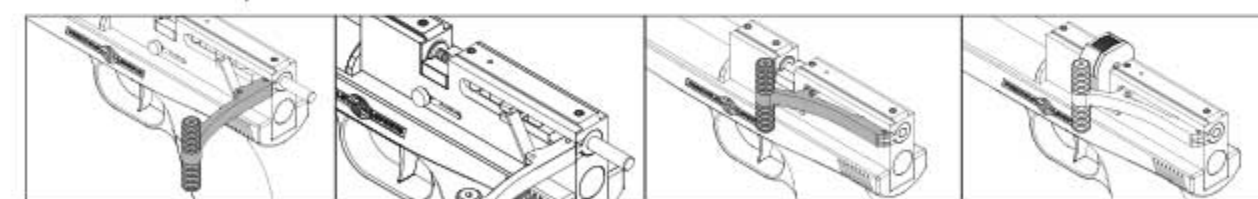

- Pull the cocking lever / handle backward as far as possible till click of sear engaging is felt.
- While loading the magazine in the pistol, ensure that the cocking lever is held fully back and then slide the magazine in place or if using a pellet tray, simply place a pellet in the pellet tray as shown in picture. For more details read the operating manual of the magazine. Be careful not to squeeze or damage the pellet as this could affect accuracy. Close the cocking lever / handle till it locks in place. This chambers the pellet into the barrel. The pistol is now cocked and ready to fire.

#### 3. AIR PISTOL SAFETY LOCK

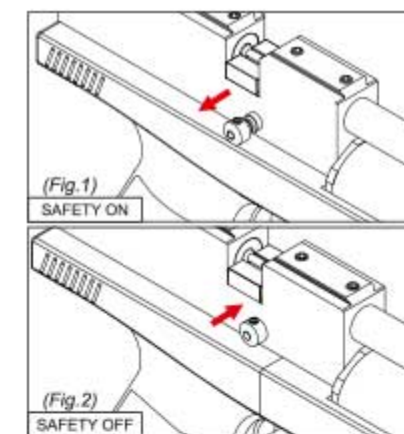

Safety button can be set to 'ON' and 'OFF' position manually. To set the safety to 'ON', push the safety lever to the right. The pistol has to be in cocked position while moving safety from 'ON' to 'OFF' or vice versa. In this position, the hammer is blocked and the air pistol cannot fire. (Fig.1) You can use this position to do dry fire training.

To move the safety to 'OFF', push safety lever to the left after cocking the pistol. In this position, the pistol is ready to shoot (Fig.2)

**CAUTION: Until you are actually ready to shoot, keep the safety in the 'ON' position (Fig.1)**

**Before firing the pistol ensure safety is in fire position.**

#### SIGHT ALIGNMENT & ADJUSTMENT

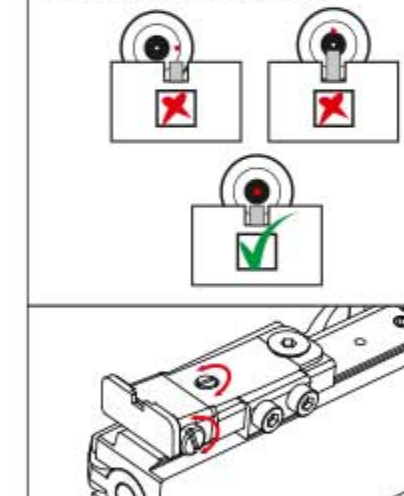

- The front sight blade should be set exactly in the center of the notch area of the rear sight and its top should be even with the top of the rear sight. The bullseye should appear to rest on top of the front sight.
- Precihole Sports air pistols are equipped with an adjustable rear sight for both elevation (Up and Down) and windage (Left and right).
- To adjust point of impact right or left:** Turn the (Windage screw) located on the side of the rear sight. Rotating the screw clockwise will move the point of impact to the right i.e. the pellet will hit to the right. Rotating the screw anti clockwise will move the point of impact to the left i.e. the pellet will hit to the left.
- To adjust elevation:** Turn the elevation screw located on top of the sight with a small screwdriver. Rotating the screw anti clockwise will elevate the point of impact making the air pistol shoot higher. Rotating the screw clockwise will depress the point of impact making the air pistol shoot lower.

**NOTE: Please refer Precision Aperture Rear Sight Manual for Adjustment.**

**NOTE: Please refer pistol Rear Sight Manual for Adjustments.**

#### 5. FIRING YOUR AIR PISTOL

Ensure the cocking handle is fully closed before firing the pistol as its performance will be affected if not fully closed. Close the cocking handle till it locks in place. Aim at your intended target and disengage the safety and prepare to shoot. Pull the trigger gently and the pistol will fire. To reload pistol, pull the cocking handle to its rear-most position and follow the section 2.(Cocking, Loading & Locking).

**NOTE: Many factors affect the velocity, including the ammunition brand and weight, lubrication, barrel condition and temperature.**

## HARPY X3

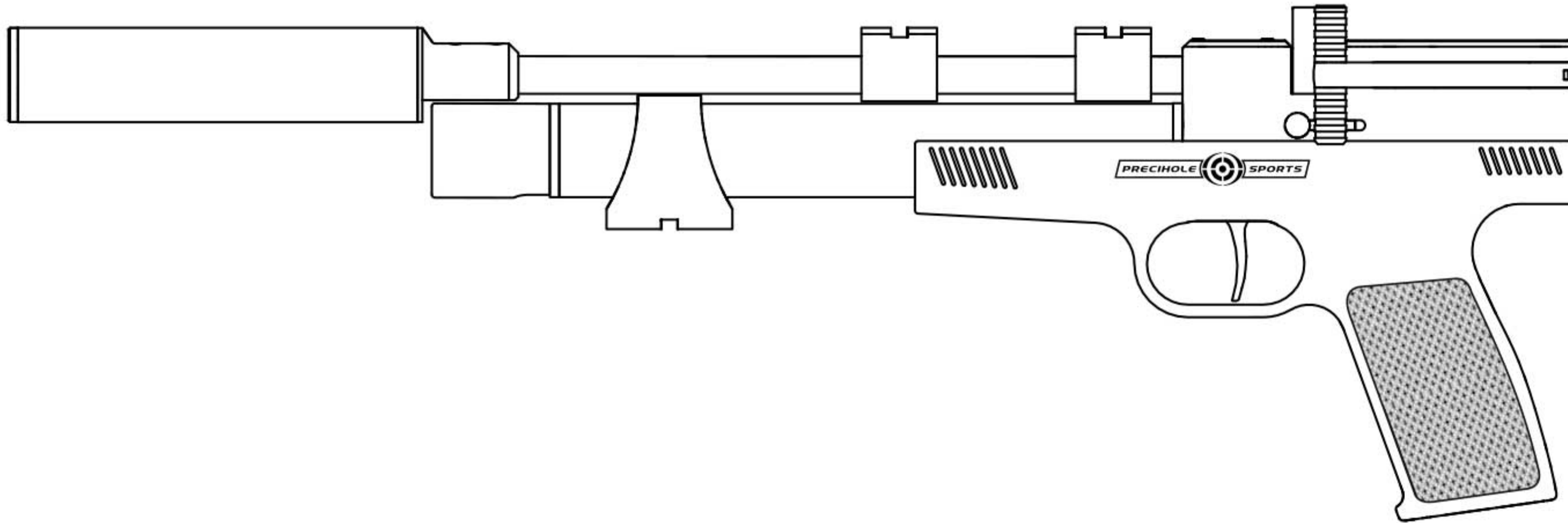

## HARPY X1

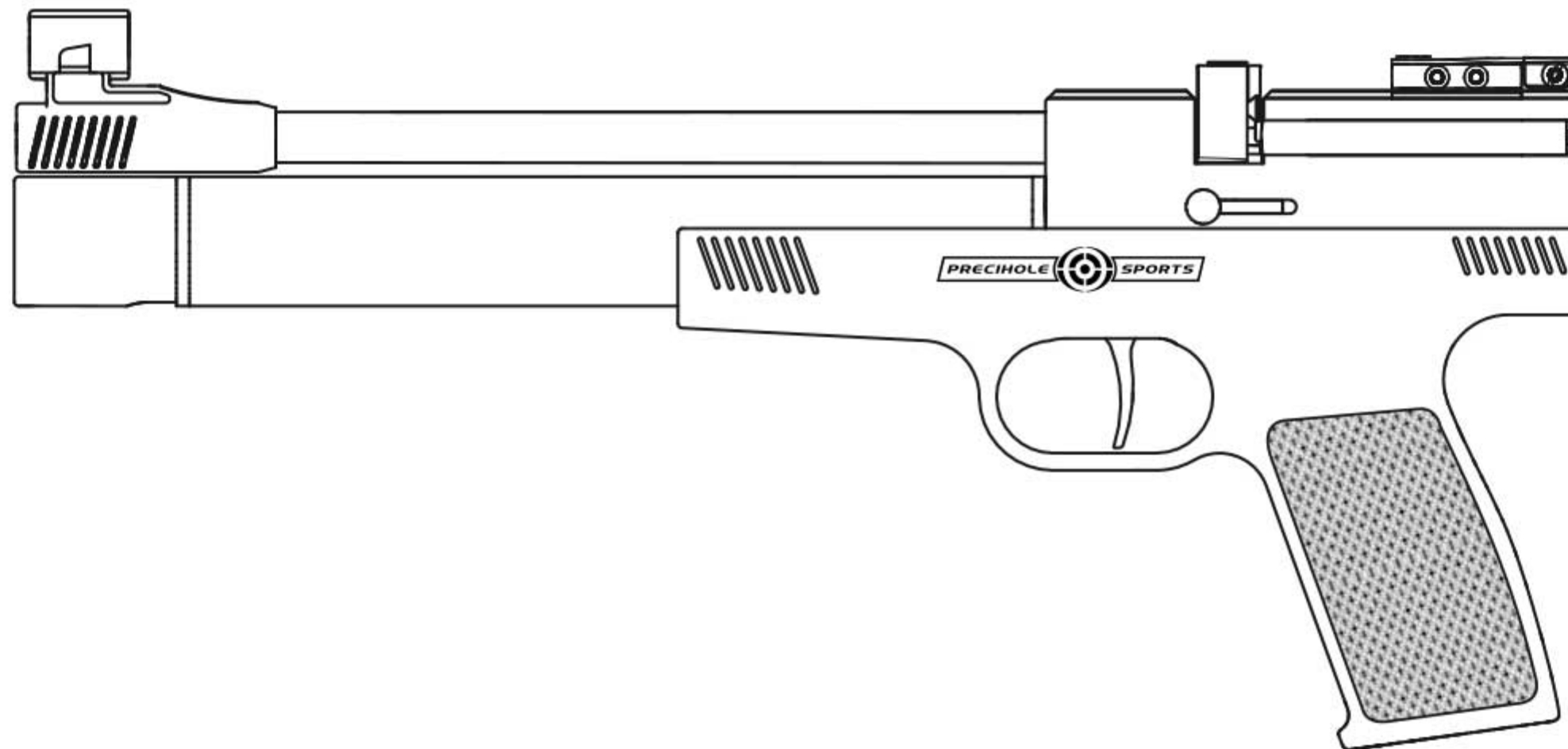

### PRECIHOLE SPORTS PVT. LTD.

📍 A-272, Road 16A, Opp. ESIC Hospital, Wagle Estate, Thane (W) - 400604  
☎ +91 8879320376 / 77 | ✉ info@preciholesports.com  
🌐 www.preciholesports.com | Follow us on: @ f 📺 🐦

