

# MOD-U-SERVE

## MODULAR HOT/COLD FOOD UNIT

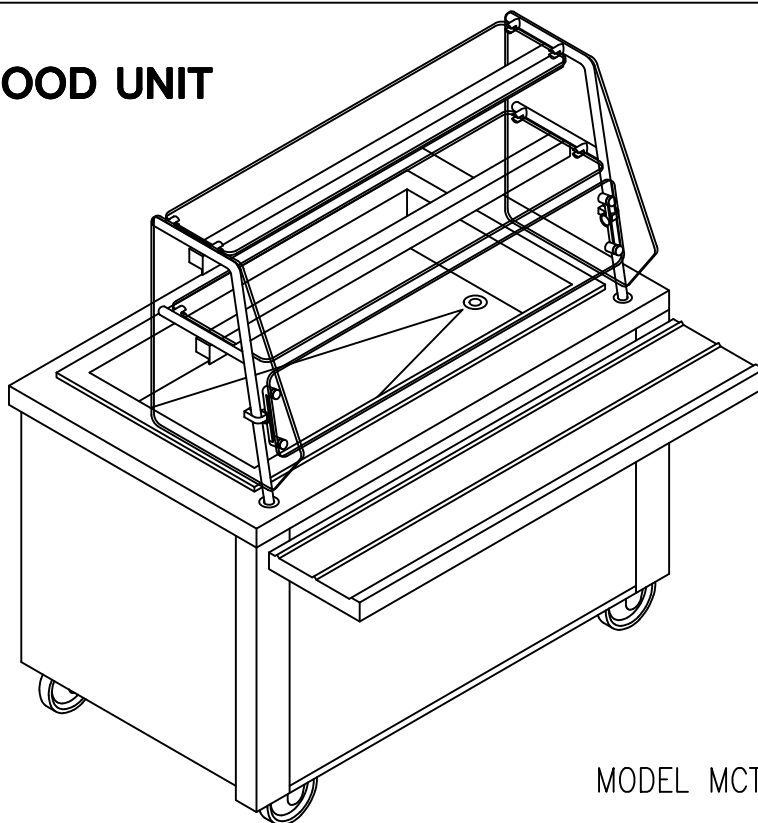

MODEL MCT-H/CF3 SHOWN

MODEL	LENGTH	WELLS	HP	VOLTS	PHASE	AMPS	CORD/CAP
MCT-H/CF1	34"	1	1/4	120/208	1	5.8	NEMA L14-20P
MCT-H/CF2	38"	2	1/4	120/208	1	10.6	NEMA L14-20P
MCT-H/CF3	52"	3	1/4	120/208	1	10.6	NEMA L14-20P
MCT-H/CF4	66"	4	1/4	120/208	1	15.6	NEMA L14-20P
MCT-H/CF5	80"	5	1/3	120/208	1	20.4	NEMA L14-30P

**FRAME:** Featuring frameless construction utilizing 16 gauge stainless steel corner mullions with top and bottom horizontal members of 16 gauge stainless steel.

**CASTERS:** Heavy duty 5" diameter adjustable polyurethane casters with brakes all the way around.

**TOP:** 14 ga. stainless steel with 2" turndown on all sides and sound deadening applied between top and frame.

**SNEEZE GUARD:** Elite 4 custom guards with 1" round stainless steel tubing post. 3/8" tempered glass NSF rated with optional LED light fixtures and heat lamps with infinite control located in control panel.

**FRONT BODY PANEL:** Removable front panels in a wide array of options.

**UNDERSHELF:** 18 ga. stainless steel with 18" high ends and 4" high back. Underself is held back 6" from front panel forming a utility chase for plumbing and electrical services.

**TRAYSLIDE:** 14 gauge stainless steel with inverted vee ridges on fold-down brackets.

**HOT/COLD FOOD UNITS:** Mechanically cooled stainless steel cold pan 6" deep with adaptor bars. 1000 watt heating elements. Bottom slopes to 1" drain.

**CONTROL PANEL:** All switches to be centrally located in common control panel assembly with fold down front for ease of maintenance and service.

**CONDENSING UNIT:** R404A high temperature hermetically sealed unit with thermostatic adjustment.

**REFRIGERATION:** 3/8" copper side wall mounted coil with thermal mastic applied to increase surface area.  
(1) self contained condensing unit with receiver and expansion valve operation.

**THERMOMETER:** Unit complete with digital thermostat/controller.

**STAINLESS STEEL SPECIFICATION:** All stainless steel to be type 304 with number 3 finish.

**MODULE LATCHING:** Easy operation pin and slide module latching in top turndown where required.

# MOD-U-SERVE

## MODULAR HOT/COLD FOOD UNIT

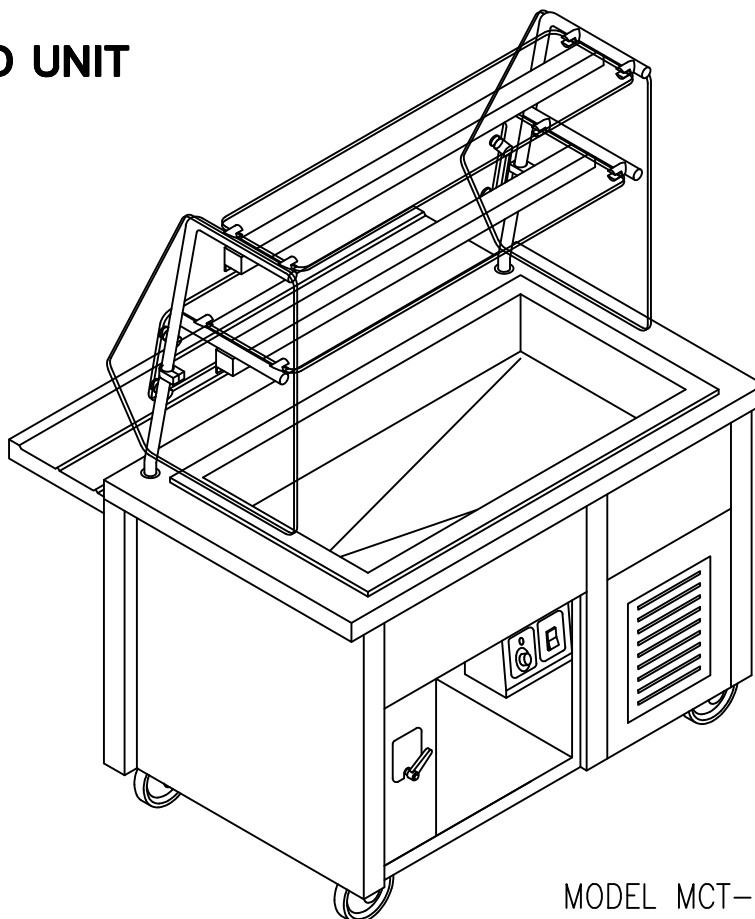

MODEL MCT-H/CF3 SHOWN

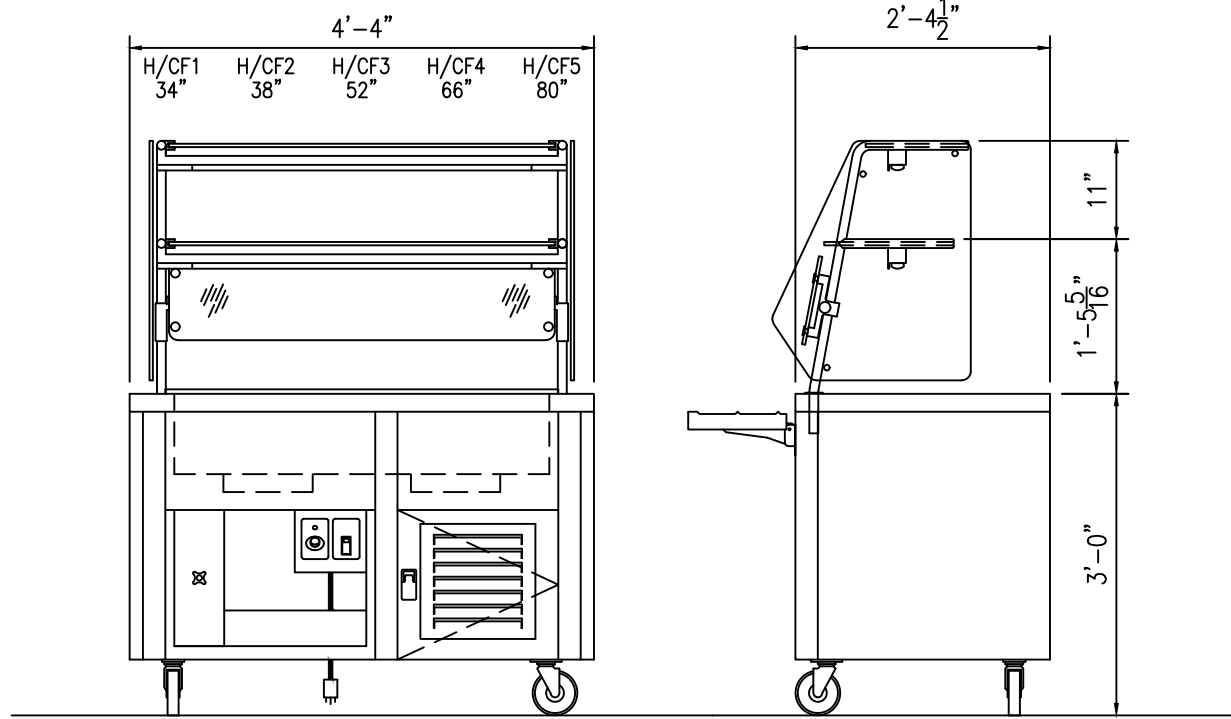

FILE: MCT-H/CF (2)