

TESTED ASSEMBLY

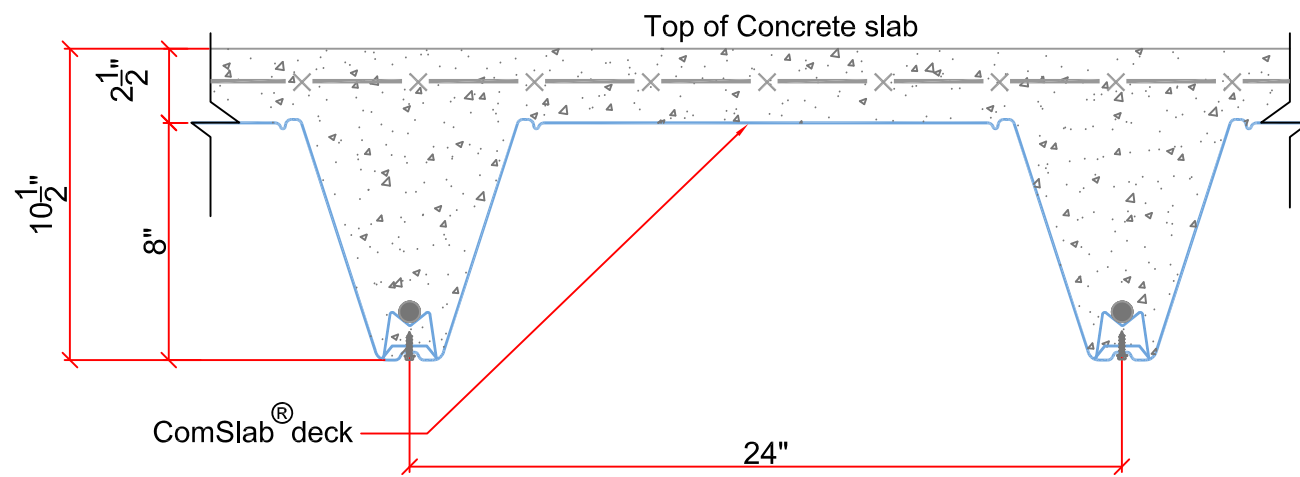

RESULT: **STC 47**

TESTED ASSEMBLY

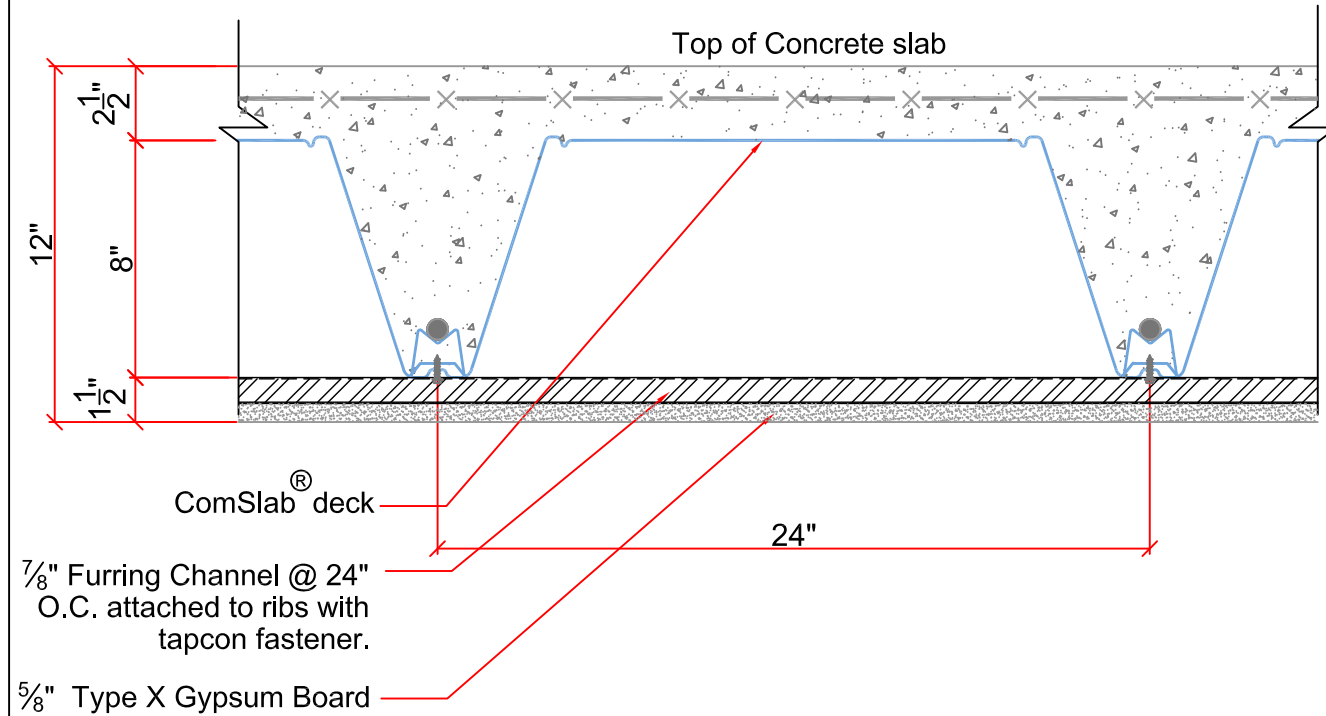

RESULT: **STC 56**

TESTED ASSEMBLY

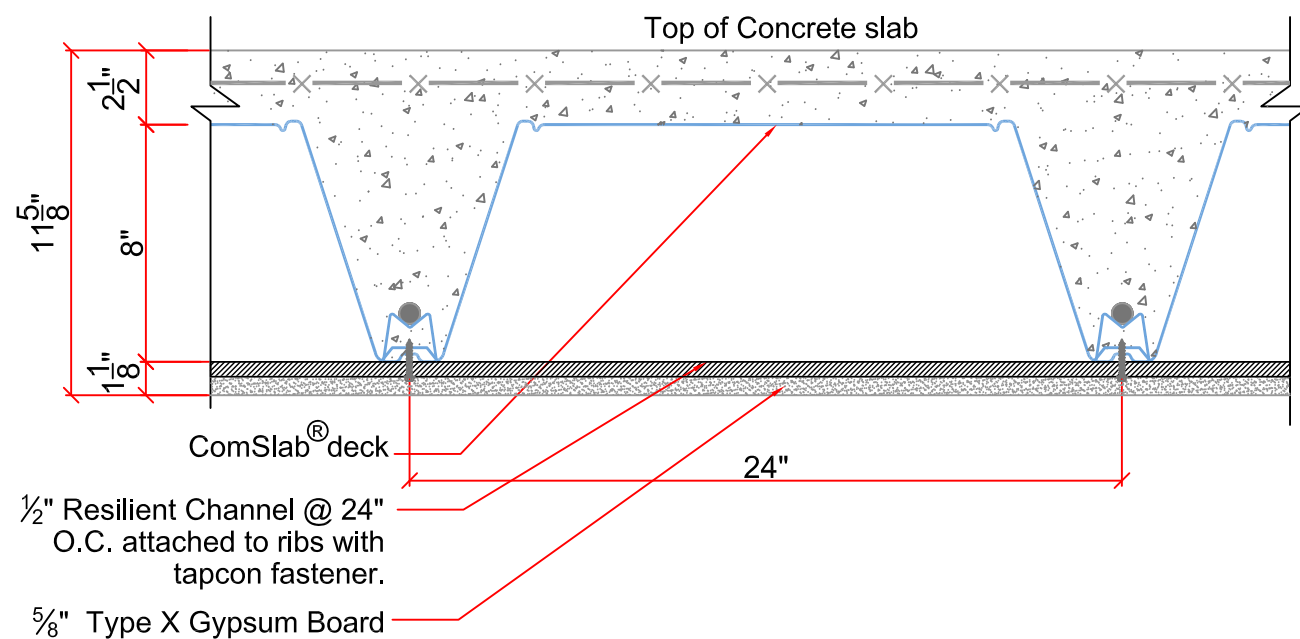

RESULT: **STC 58**

TESTED ASSEMBLY

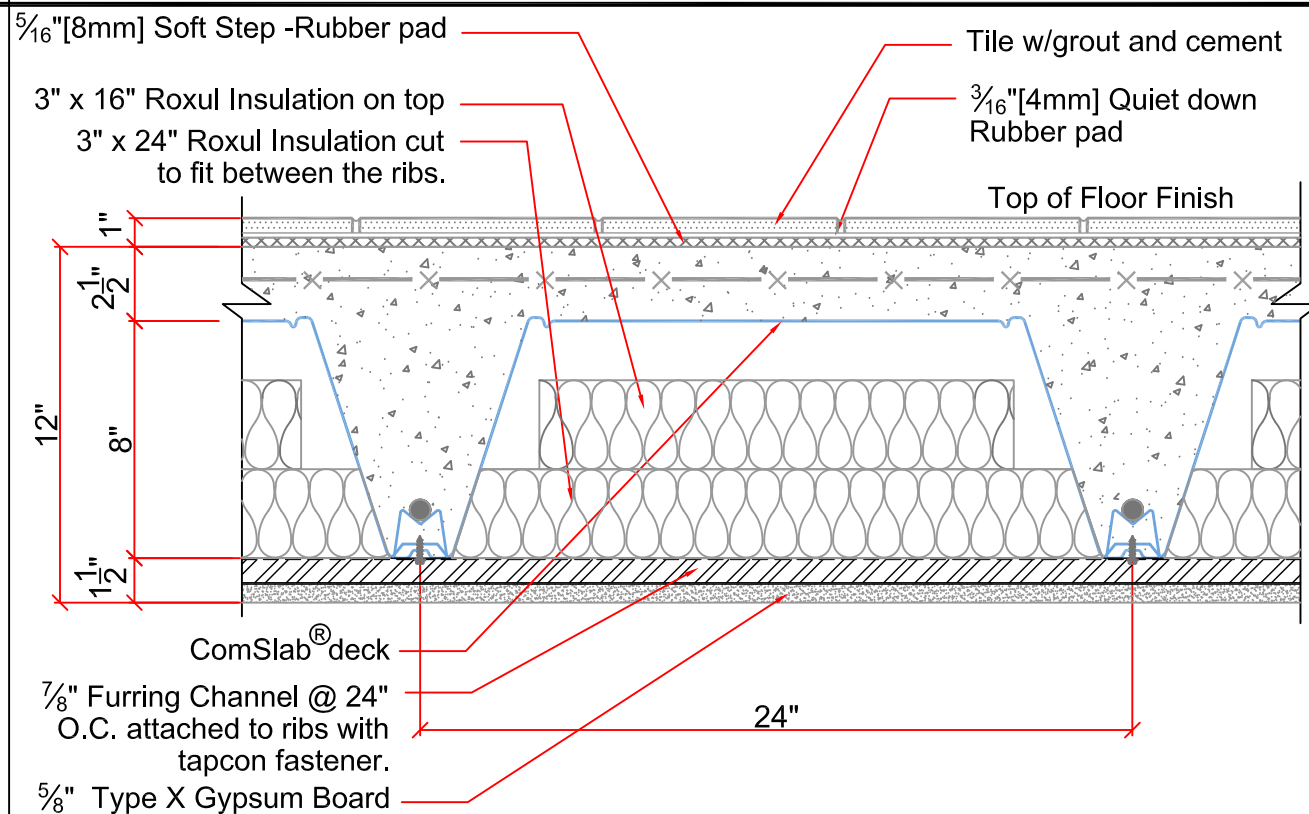

RESULT: **STC 60**



21863 Aurora Road Suite B  
Cleveland, OH 44146

PROJECT:

TYPICAL DETAILS

TITLE:

ComSlab Acoustical Performance  
STC - Comslab with 2 1/2" Concrete Topping

PROJECT NO:

DATE: April 21, 2014

DRAWN BY: K.O.

CHECK BY: A.A.

SCALE: NOT TO SCALE

DRAWING NO:

1.0

TESTED ASSEMBLY

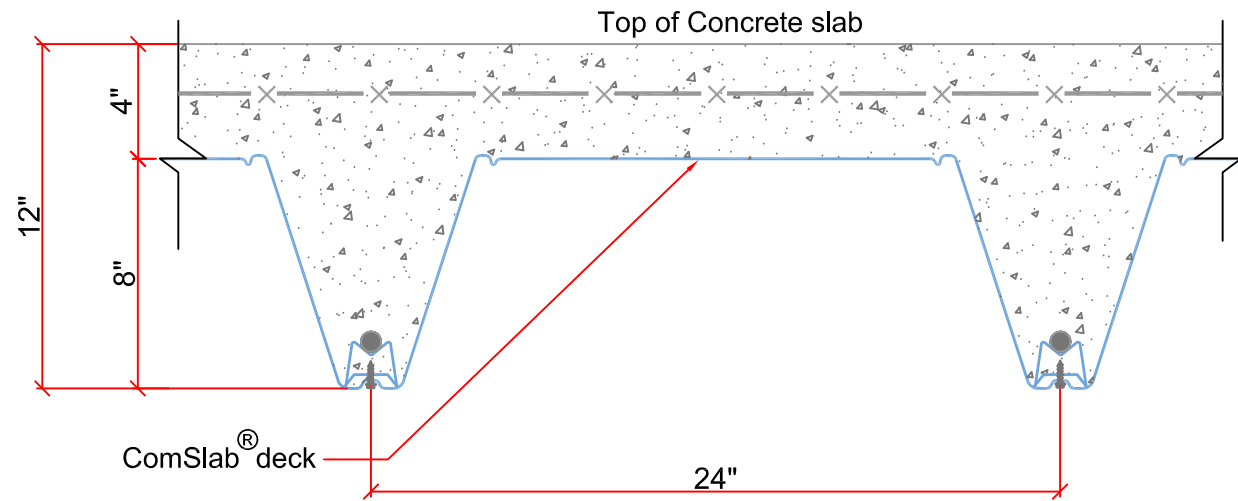

RESULT: **STC 49**

TESTED ASSEMBLY

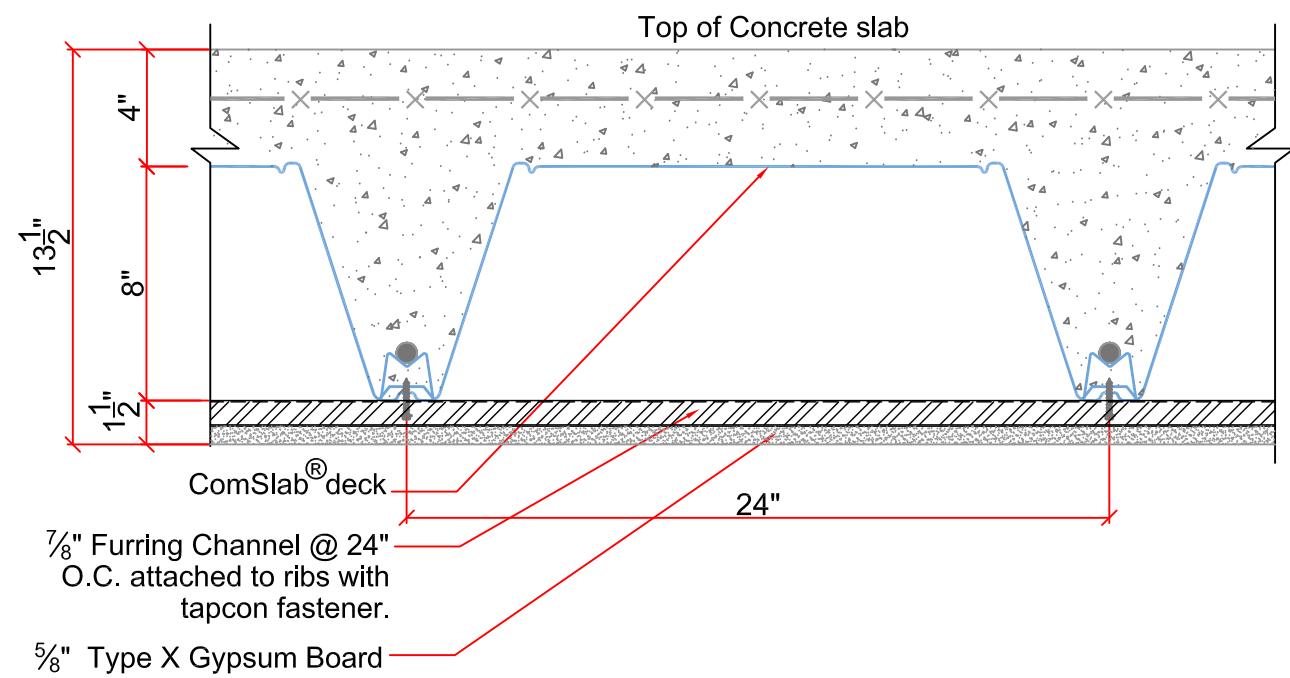

RESULT: **STC 58**



21863 Aurora Road Suite B  
Cleveland, OH 44146

PROJECT:

TYPICAL DETAILS

TITLE:

ComSlab Acoustical Performance  
STC - Comslab with 4" Concrete Topping

PROJECT NO:

DATE: April 21, 2014

DRAWN BY : K.Q.

CHECK BY : A.A.

SCALE: NOT TO SCALE

DRAWING NO:

1.1

TESTED ASSEMBLY

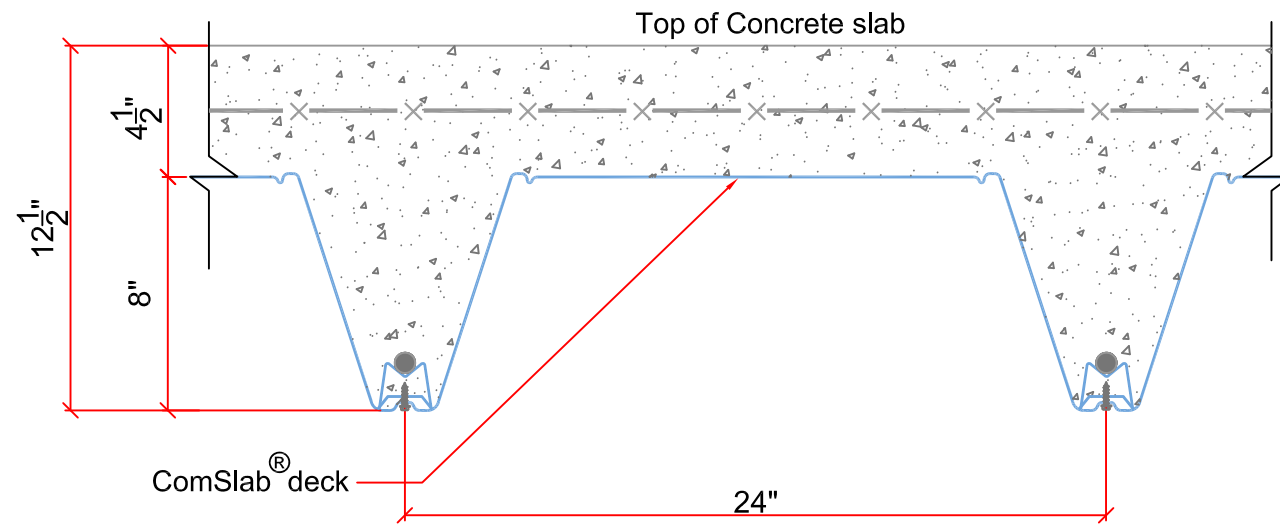

RESULT: **STC 51**

TESTED ASSEMBLY

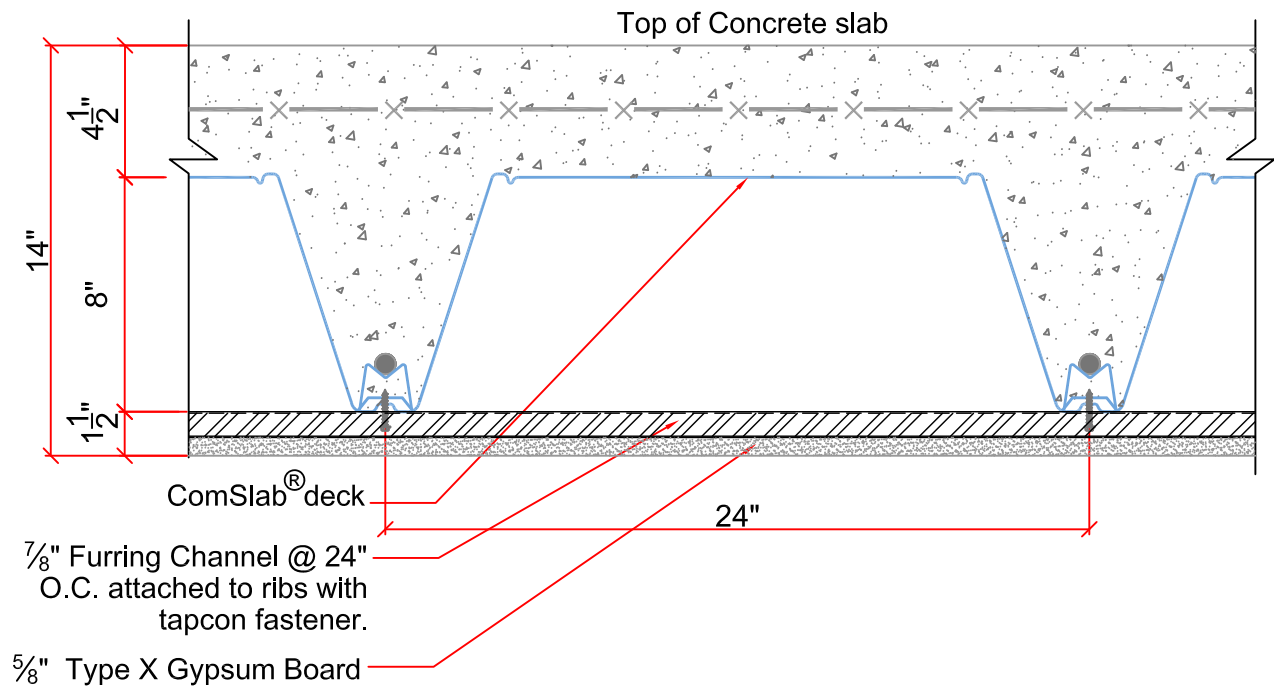

RESULT: **STC 57**

TESTED ASSEMBLY

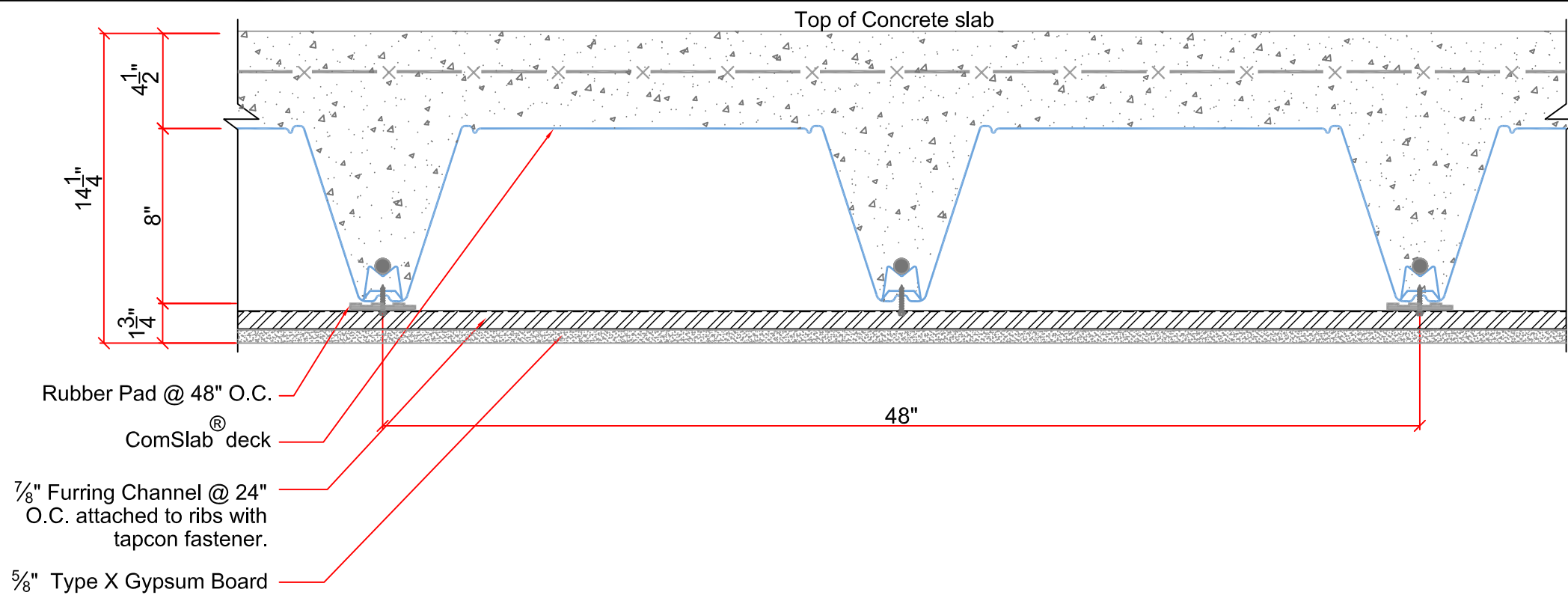

RESULT: **STC 61**



21863 Aurora Road Suite B  
Cleveland, OH 44146

PROJECT:

TYPICAL DETAILS

TITLE:

ComSlab Acoustical Performance  
STC - Comslab with 4 1/2" Concrete Topping

PROJECT NO:

DATE: April 21, 2014

DRAWN BY: K.Q.

CHECK BY: A.A.

SCALE: NOT TO SCALE

DRAWING NO:

1.2