

The Ameena Group Ltd

Suite 313

28 Old Brompton Road

London SW7 3SS

t: +44 (0)788 192 7267

w: theameenagroup.com

Bridgeman House, 375 KHS, London W14

£2,200,000 Leasehold



- 2 Bedrooms • 2 Bathrooms • 1009 sqft/ 93.7 sqm internal area • 6th Floor • 1 Balcony • 1 Sky Garden •
- 24 hr Concierge • Underground Parking • Gym • Business Suite • 990 + Year Lease • On Site Amenities •

Bridgeman House is part of the popular 375 Kensington High Street new development. The development offers a number of amenities on site, including 24 hr concierge, a gym and a swimming pool.

The development is located on High Street Kensington close to Olympia Station. It is also a 10-15 minutes walk to either Earls Court or High Street Kensington Station, with regular buses running from outside the development. Transport and connectivity wise, you are very comfortable.







Bridgeman House, W14

Approximate Gross Internal Area = 93.7 sq m / 1009 sq ft

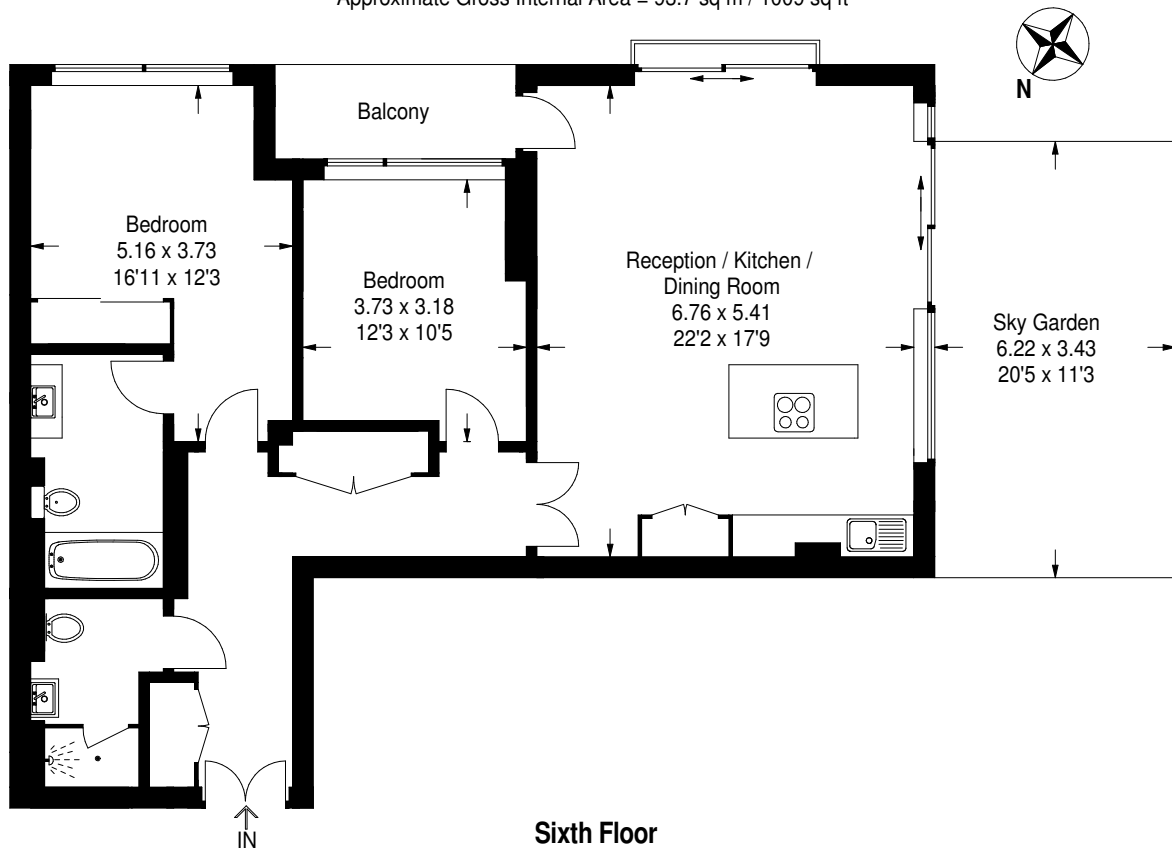

Sixth Floor

Illustration for identification purposes only, measurements are approximate, not to scale.



For more information call on

+44 (0) 20 3773 5759

or email at

ac@theameenagroup.com

We're members of the

