



## PLANA

**Controtelaio.** Legno di abete FJ su 3 lati sezione standard 20x103 mm; fornito di serie assemblato con distanziali e n. 6 zanche laterali zingate.

**Telaio.** Listellare controplaccato di sezione min. 40x106 mm con spigolo raggio 1 mm; guarnizione di battuta in APVC bianco, marrone o nero.

**Anta.** Sp. 45 mm, bordo in massello, tamburata in MDF; pannello interno fonoisolante (optional).

**Vetro / Griglie.** Possibilità di inserimento oblo vetrato e griglie aerazione.

**Coprifili.** Interni 72x12 mm, esterni 85x12 mm, in multistrato controplaccati in essenza di legno con aletta telescopica.

**Finitura.** Laccatura RAL opaco, extra opaco e lucido. Rovere (naturale, trasparente, sbiancato, wenge, mordenzato), Tanganica (noce, ciliegio), Ciliegio, Castagno, Noce, Palissandro, Teak, Precomposti.

**Cerniere.** Acciaio trattato. Modello Plana n. 3 Ø 14x80; modello Linear n. 3 registrabili a scomparsa (optional).

**Maniglia.** Alluminio anodizzato (di serie); optional: a scelta da cataloghi fornitori Cipriani.

**Serratura.** Patent Q.8 acciaio trattato Optional: serratura magnetica, Yale e Libero/ Occupato.

**Accessori.** Cromo satinato, bronzati, ottonati, cromati (optional).

**Apertura.** Destro, Sinistro, Libro asimmetrico, Scorrevole esterno muro, Scorrevole Sipario.

**Precadre.** Bois de sapin FJ sur 3 côtés section standard 20x103 mm; fourni comme standard assemblé avec entretoises et 6 pinces à queue de carpes latéraux.

**Chassis.** Latte contrecollée de la section min. 40x106 mm avec rayon de coin 10 mm; Joint en APVC blanc, marron ou noir.

**Vantail.** Sp. 45 mm, bord en massif, creux et contre plaqué en MDF, Px interne isolation acoustique (optionnelle).

**Verre / Grilles.** Possibilité d'insertion hublot et grilles vitrées ventilation.

**Couvre-joint.** Intérieur 72x12 mm, extérieur 85x12 mm, en contreplaqué contrecollé en essence de bois avec ailette télescopique.

**Finition.** Laquage RAL mat, extra mat et brillant. Chêne (naturel, transparent, blanchi, wengé, gravé), Tanganique (noyer, cerisier), Cerise, Châtaigne, Noyer, Palissandre, Teck, Reconstitué.

**Charnières.** Acier traité. Model Plana n. 3 Ø 14x80; model Linear n. 3 encastré et réglable (optionnelle).

**Poignée.** Aluminium anodisé (standard); en option: choisi parmi les catalogues Cipriani fournisseurs.

**Serrure.** Patent Q.8 acier traité en option: verrouillage magnétique, Yale et libre / occupé.

**Accessoires.** Chrome satiné, bronze, brassy, chromé (facultatif).

**Ouverture.** Droite, Gauche, Pliant asymétrique, Paroi Coulissante externe, Coulissant intramur.

**Sub frame.** Fir wood FJ on 3 sides standard section 20x103 mm; standard supply assembled with spacers and n. 6 galvanized side clamps.

**Frame.** Counter plated blockboard minimum section of 40x106 mm with corner radius 1mm; APVC rubber gasket in white, brown or black.

**Door leaf.** 45 mm thick, solid wood edge, honeycombed in MDF with sound proofing internal panel (optional)

**Glass / Grilles.** Possibility of inserting porthole glass and ventilation grilles.

**Architraves.** Internal 72x12 mm, external 85x12 mm in plywood counterplated in wood essence, adjustable.

**Finishing.** Lacquered RAL matt, extra matt and glossy. Oak (natural, transparent, bleached, wenge, stained), Tanganika (walnut, cherry), Cherry, Chestnut, Walnut, Rosewood, Teak, Engineered wood.

**Hinges.** Treated steel. Model Plana n.3 Ø 14x80; model Linear n. 3 hidden adjustable (optional).

**Handle.** Anodized aluminium (standard); optional: to be chosen from Cipriani's supplier catalogues.

**Lock.** Patent Q.8 treated steel. Optional: magnetic lock, Yale and occupancy lock.

**Accessories.** Satin chrome, bronzed, brassy, chromed (optional).

**Opening.** Right, Left, Bi-folding, External wall Sliding, Pocket door.

Dimensioni di serie in mm / Dimensions standard en mm / Standard sizes mm

|                                   |                                                                               |           |  |     |  |     |  |      |  |     |
|-----------------------------------|-------------------------------------------------------------------------------|-----------|--|-----|--|-----|--|------|--|-----|
| Larghezza / Largeur / Width       | Luce netta passaggio / Passage net / Net clearance                            | <b>LP</b> |  | 600 |  | 700 |  | 750  |  | 800 |
|                                   | Interno controtelaio / Interne precadre / Casing interior                     | <b>LC</b> |  | 700 |  | 800 |  | 850  |  | 900 |
|                                   | Muratura al grezzo / Maçonnerie brut / Unrefined masonry                      | <b>LM</b> |  | 760 |  | 860 |  | 910  |  | 960 |
| Altezza / Hauteur / Height        | Luce netta passaggio / Passage net / Net clearance                            | <b>HP</b> |  |     |  |     |  | 2100 |  |     |
|                                   | Da pavimento a controtelaio / Du plancher au precadre / From floor to casing  | <b>HC</b> |  |     |  |     |  | 2150 |  |     |
|                                   | Pavimento a grezzo / Du plancher au maçonnerie brut / From floor to unrefined | <b>HM</b> |  |     |  |     |  | 2180 |  |     |
| Spessore / Épaisseur<br>Thickness | Spessore muro / Épaisseur mur / Wall thickness                                | <b>SM</b> |  |     |  |     |  | 106  |  |     |



PLANA (DI SERIE / STANDARD)

LINEAR (SU RICHIESTA / SUR DEMANDE / ON REQUEST)

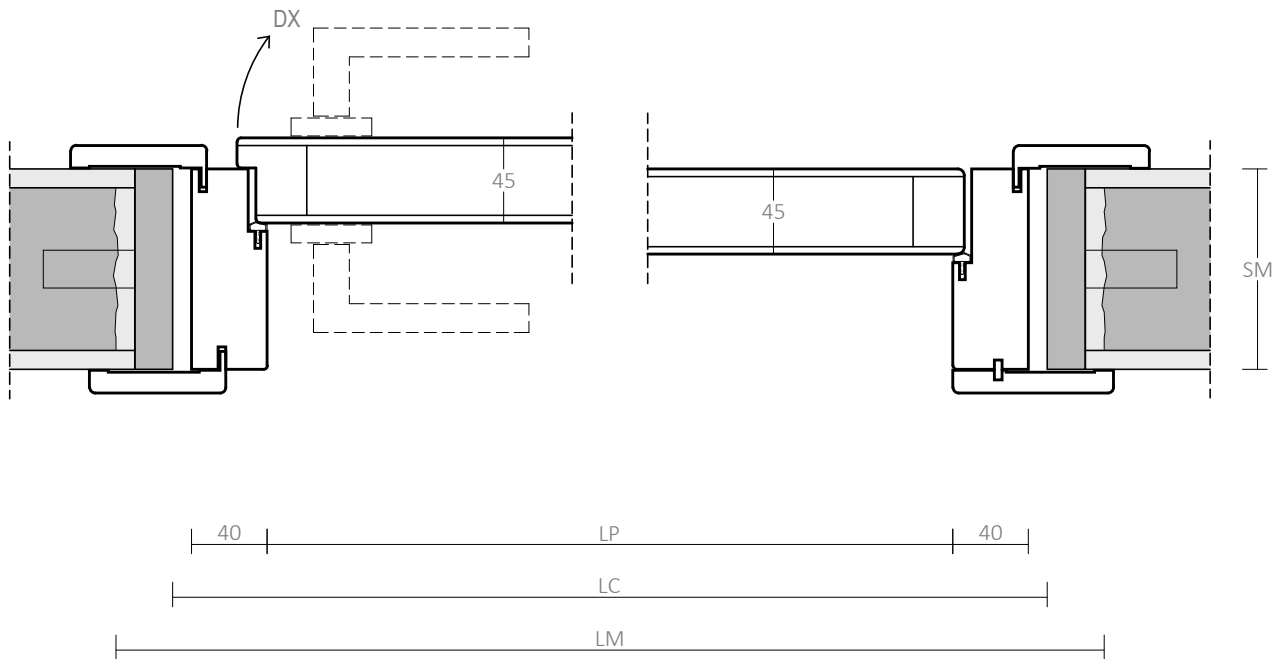

SCALA / ÉCHELLE / SCALE 1:4



Nella foto a sinistra porta in rovere sintetico sbiancato. Nella foto a destra Optional Plana Linear laccata extra lucido.

En photo à gauche porte en chêne synthétique blanchi. En photo à droite Optional Plana Linear lacquage extra brillant.

In the left picture in bleached artificial oak essence door. In the right picture Optional Plana Linear lacquered extra glossy.



## COMPLANARE (SU RICHIESTA / SUR DEMANDE / ON REQUEST)

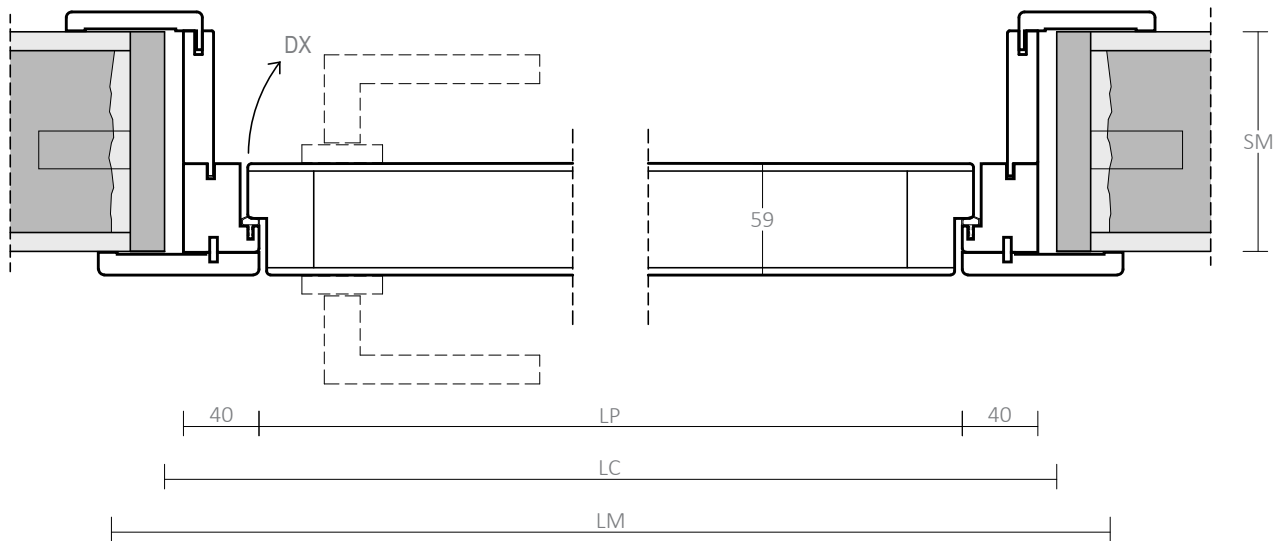

SCALA / ÉCHELLE / SCALE 1:4



La porta Plana può essere realizzata con effetto complanare e cerniere a scomparsa nelle varianti laccata e in essenza.

La porte Plana peut être réalisée à effet coplanaire et charnières encastré, avec la finition laquage ou essence ou in essence.

The door Plana can be provided flush with hidden hinges and laquered or veneered options.